



FOR SALE

GARDEN GROVE COMMERCE PARK
12620 WESTMINSTER AVENUE,
UNITS B & C
GARDEN GROVE | CA 92843

FOR MORE INFORMATION PLEASE CONTACT:

JIM ST. OMER ROY
VICE PRESIDENT

P: 949.242.1713

jim.saint@daumcommercial.com

CADRE #00944842

Property Features

- High Image Industrial Condos
- Large Reception | Open Office, Two Private Offices, Two Restrooms
- Fully Fire Sprinklered
- Two 12'x12' Rear Ground Level Loading Doors
- 15' Minimum Warehouse Clear Height
- 200 Amps of 120/208 Volt Electrical Service
- 2:1,000 Parking Ratio
- CC& R's to Maintain Quality Business Park Environment
- Convenient Access to 22, 5, 57 Freeways

Although all information is furnished regarding for sale, rental or financing is from sources deemed reliable, such information has not been verified and no express representation is made nor is any to be implied as to the accuracy thereof, and it is submitted subject to errors, omissions, changes of price, rental or other conditions, prior sale, lease or financing, or withdrawal without notice.



3,628 SF INDUSTRIAL CONDO

3,628 SF
CONDO

GARDEN GROVE COMMERCE PARK
UNITS B & C

FOR SALE

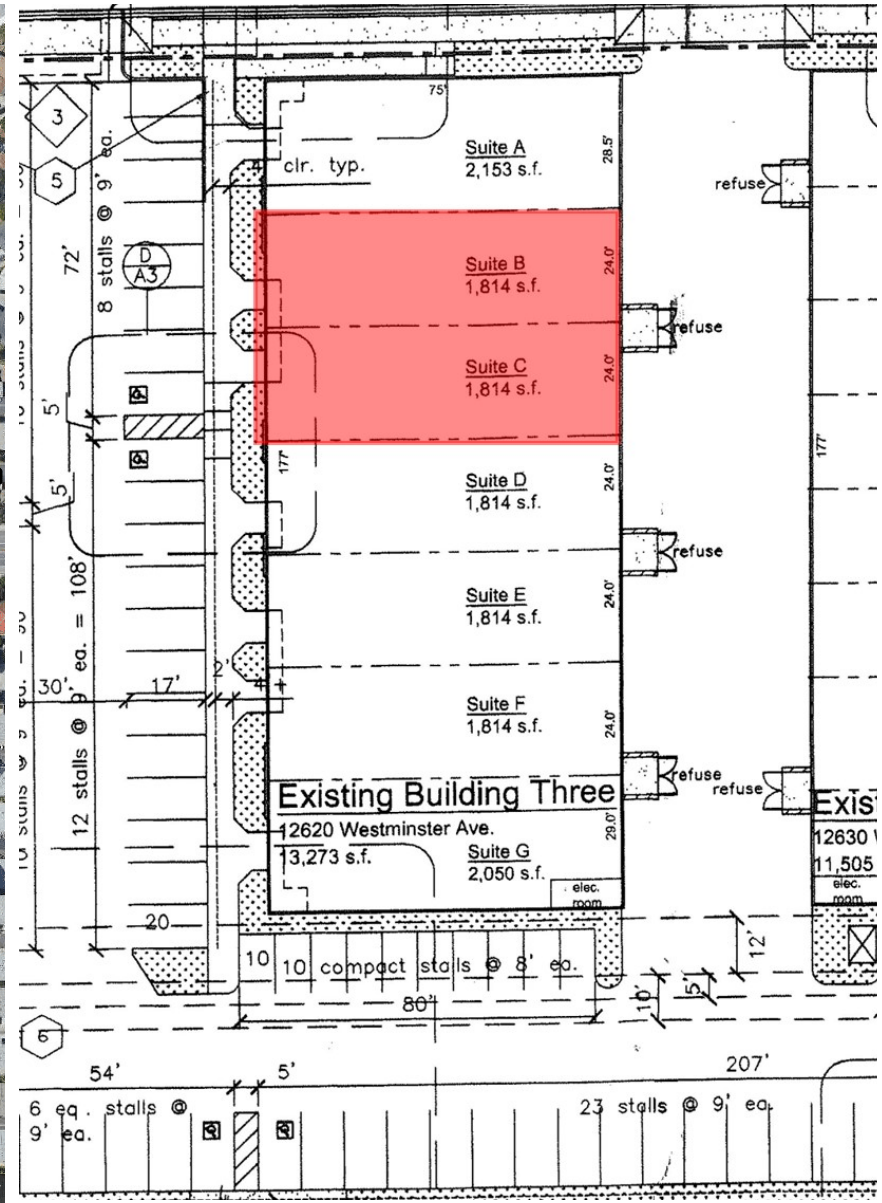
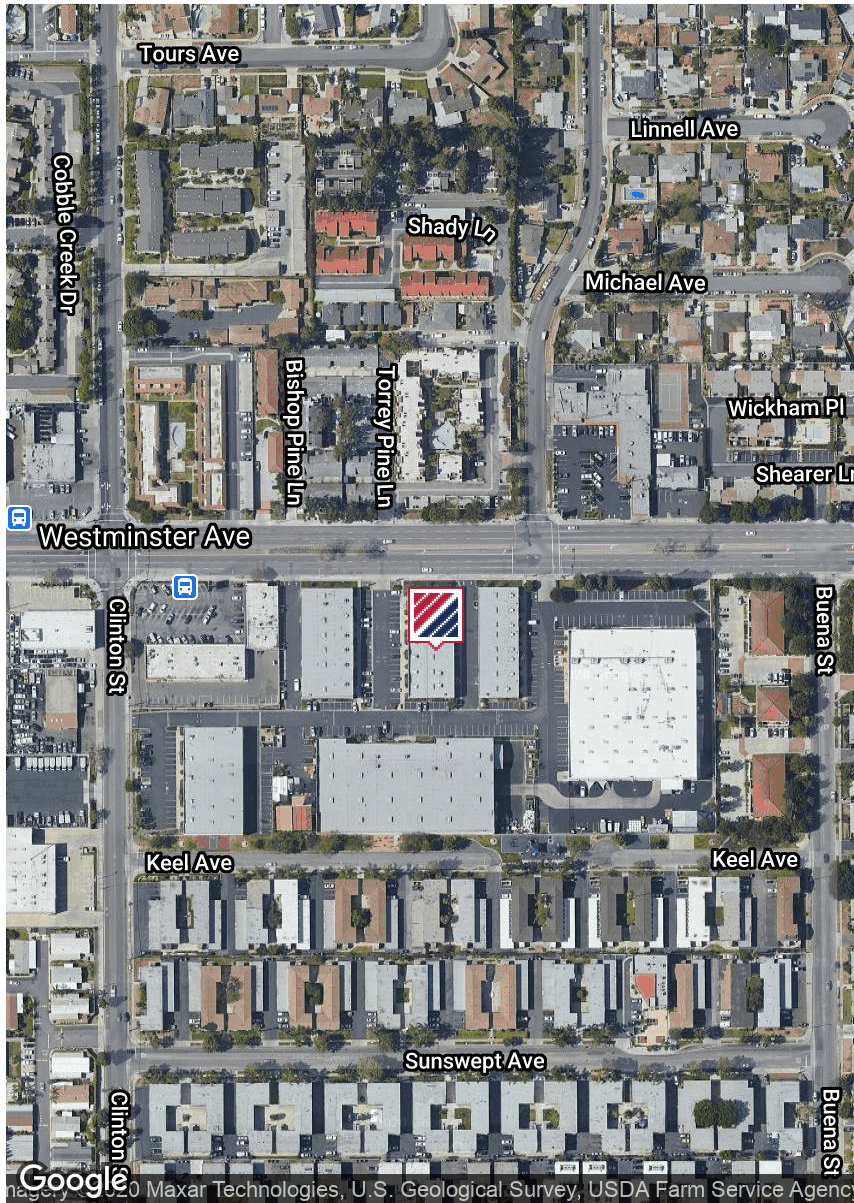

FOR MORE INFORMATION PLEASE CONTACT:

JIM ST. OMER ROY
VICE PRESIDENT

P: 949.242.1713
jim.saint@daucommercial.com
CADRE #00944842

Although all information is furnished regarding for sale, rental or financing is from sources deemed reliable, such information has not been verified and no express representation is made nor is any to be implied as to the accuracy thereof, and it is submitted subject to errors, omissions, changes of price, rental or other conditions, prior sale, lease or financing, or withdrawal without notice.

