



# FOR SALE

GARDEN GROVE COMMERCE PARK  
12620 WESTMINSTER AVENUE,  
UNIT C  
GARDEN GROVE | CA 92843

FOR MORE INFORMATION PLEASE CONTACT:

**JIM ST. OMER ROY**  
**VICE PRESIDENT**

P: 949.242.1713

[jim.saint@daumcommercial.com](mailto:jim.saint@daumcommercial.com)

CADRE #00944842

## Property Features

- High Image Industrial Condo
- Reception/Open Office, One Private Office, One Restroom
- Fully Fire Sprinklered
- One 12'x12' Rear Ground Level Loading Door
- 15' Minimum Warehouse Clear Height
- 100 Amps of 120/208 Volt Electrical Service
- 2:1,000 Parking Ratio
- CC& R's to Maintain Quality Business Park Environment
- Convenient Access to 22, 5, 57 Freeways

Although all information is furnished regarding for sale, rental or financing is from sources deemed reliable, such information has not been verified and no express representation is made nor is any to be implied as to the accuracy thereof, and it is submitted subject to errors, omissions, changes of price, rental or other conditions, prior sale, lease or financing, or withdrawal without notice.

 **DAUM**  
COMMERCIAL REAL ESTATE SERVICES

1,814 SF INDUSTRIAL CONDO



1,814 SF  
CONDO

GARDEN GROVE COMMERCE PARK  
UNIT C

FOR SALE

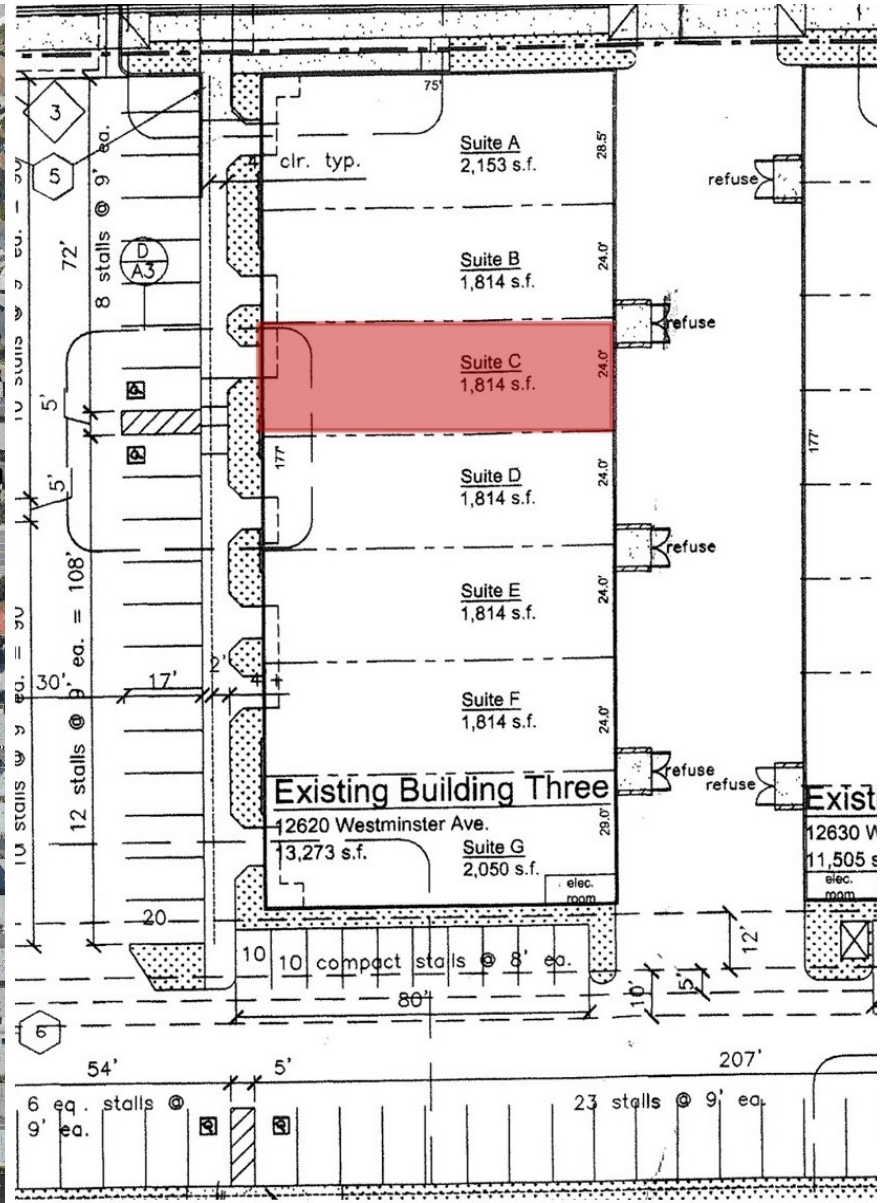
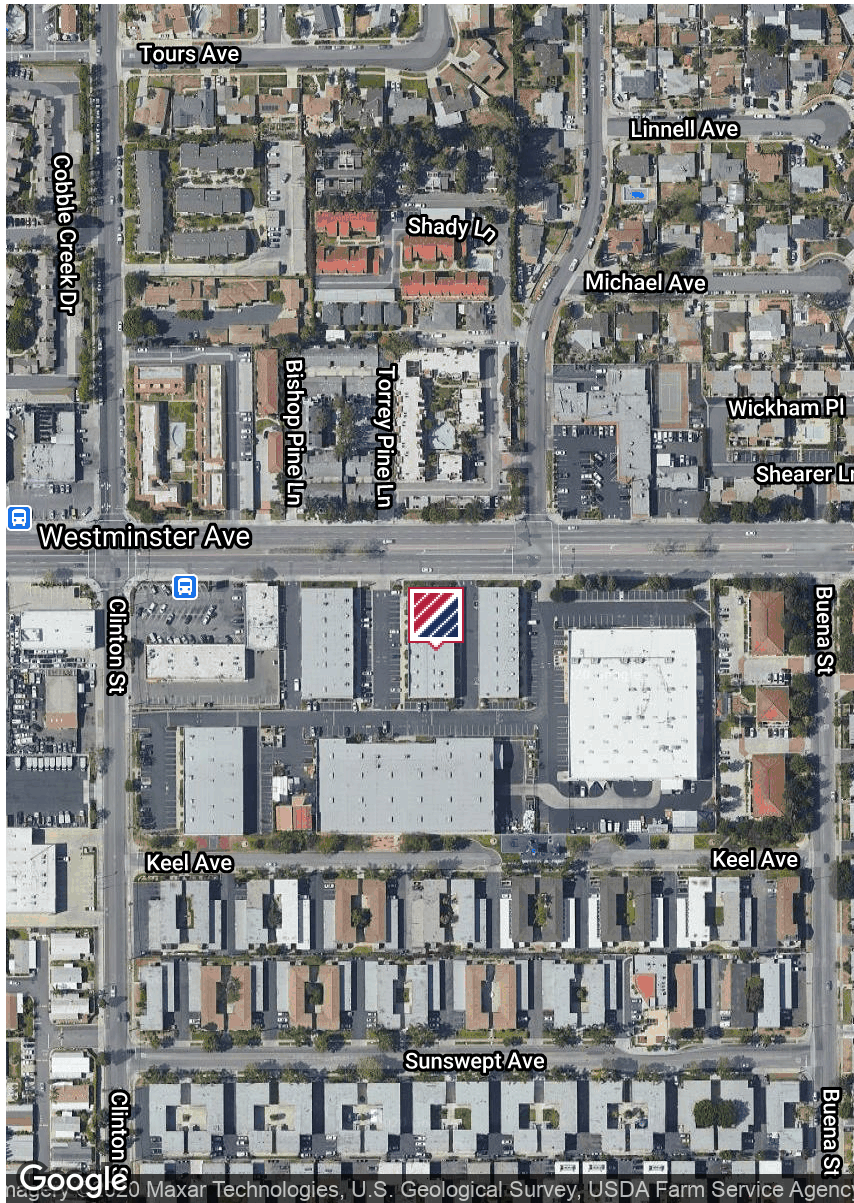

FOR MORE INFORMATION PLEASE CONTACT:

**JIM ST. OMER ROY**  
VICE PRESIDENT

**P: 949.242.1713**  
jim.saint@daucommercial.com  
CADRE #00944842

Although all information is furnished regarding for sale, rental or financing is from sources deemed reliable, such information has not been verified and no express representation is made nor is any to be implied as to the accuracy thereof, and it is submitted subject to errors, omissions, changes of price, rental or other conditions, prior sale, lease or financing, or withdrawal without notice.

