

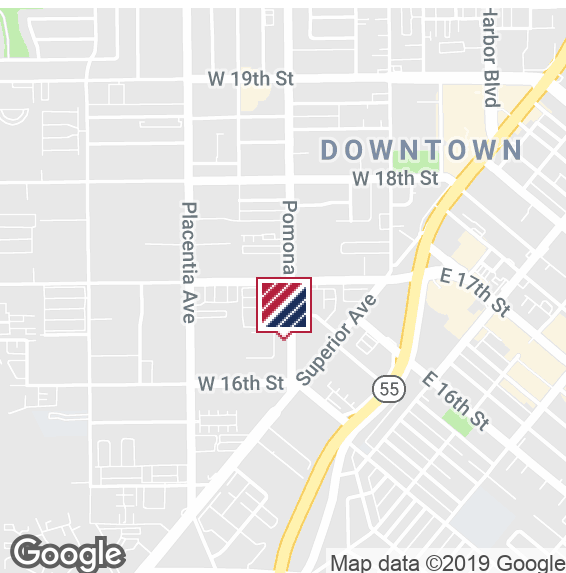

# 1634

OHMS WAY, UNIT B  
COSTA MESA | CA



## FOR LEASE

±3,000 SF INDUSTRIAL UNIT

### PROPERTY HIGHLIGHTS

- ±3,000 SF Industrial Unit
- One (1) Office
- One (1) Restroom
- Newly Renovated Interior & Exterior
- Sprinklered
- Two (2) Ground Level Doors
- 15' Clearance Height
- Located in the Coveted Westside Costa Mesa Submarket
- Large Electric Exhaust Fan
- Convenient 55 Freeway Access

FOR MORE INFORMATION PLEASE CONTACT:

**CHRIS MIGLIORI, SIOR**

EXECUTIVE VICE PRESIDENT

P: 714.941.5320 | M: 714.501.6075

chris.migliori@daumcommercial.com

CABRE #00972843

**DEVIN RAY**

ASSOCIATE

P: 949.242.1065 | M: 713.322.1252

devin.ray@daumcommercial.com

CABRE #02018130

**AUSTIN MILLER**

SALES INTERN

P: 949.724.1900 x2564 | M: 909.786.9046

amiller@daumcommercial.com

CABRE #02045328

Although all information is furnished regarding for sale, rental or financing is from sources deemed reliable, such information has not been verified and no express representation is made nor is any to be implied as to the accuracy thereof, and it is submitted subject to errors, omissions, changes of price, rental or other conditions, prior sale, lease or financing, or withdrawal without notice.

**DAUM**  
COMMERCIAL REAL ESTATE SERVICES

# 1634

OHMS WAY, UNIT B  
COSTA MESA | CA

# FOR LEASE

±3,000 SF INDUSTRIAL UNIT

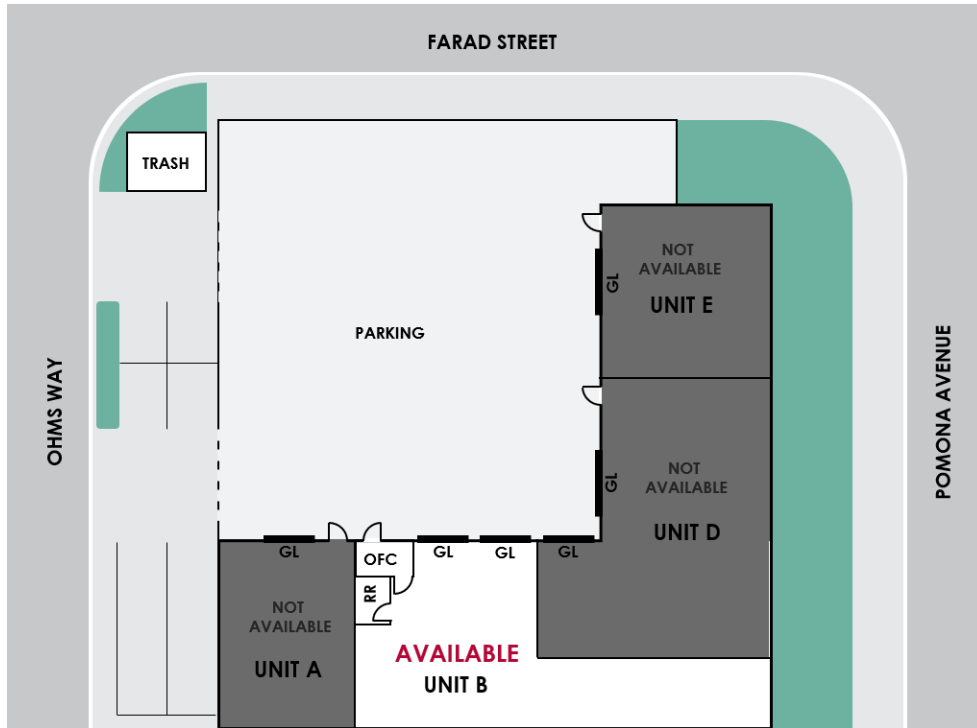

Although all information is furnished regarding for sale, rental or financing is from sources deemed reliable, such information has not been verified and no express representation is made nor is any to be implied as to the accuracy thereof, and it is submitted subject to errors, omissions, changes of price, rental or other conditions, prior sale, lease or financing, or withdrawal without notice.