



4,000 SF OFFICE SPACE
FOR LEASE

2012 CAMFIELD AVE
COMMERCE | CA, 90040

PROPERTY FEATURES:

- Best Location & Quality Business Park In Commerce
- Industrial & Wholesale/Showroom Spaces
- Walk to Citadel Outlet Center, Food Court, Starbucks Ruby's Diner & More
- Close to Downtown

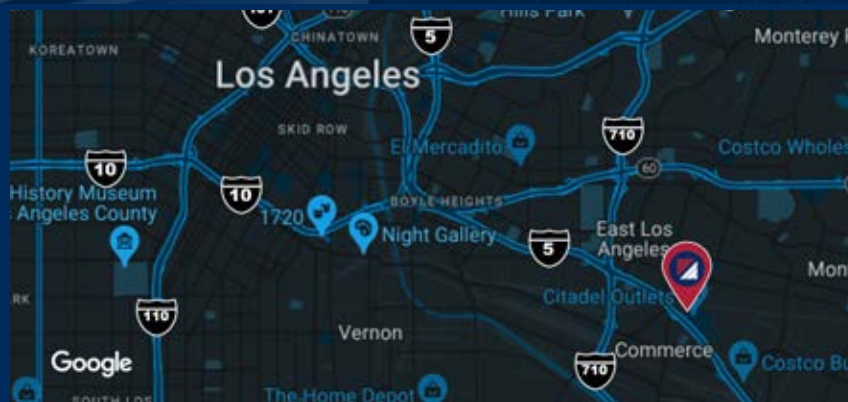

FOR MORE INFORMATION PLEASE CONTACT:

DAVID MUIR

EXECUTIVE VICE PRESIDENT

P: 213.270.2244

david.muir@daumcommercial.com

CADRE #01210653

Although all information is furnished regarding for sale, rental or financing is from sources deemed reliable, such information has not been verified and no express representation is made nor is any to be implied as to the accuracy thereof, and it is submitted subject to errors, omissions, changes of price, rental or other conditions, prior sale, lease or financing, or withdrawal without notice.

DAUM
COMMERCIAL REAL ESTATE SERVICES

2012

CAMFIELD AVE
COMMERCE | CA

FOR LEASE
INDUSTRIAL PROPERTY

EXHIBIT "A"

SITE PLAN

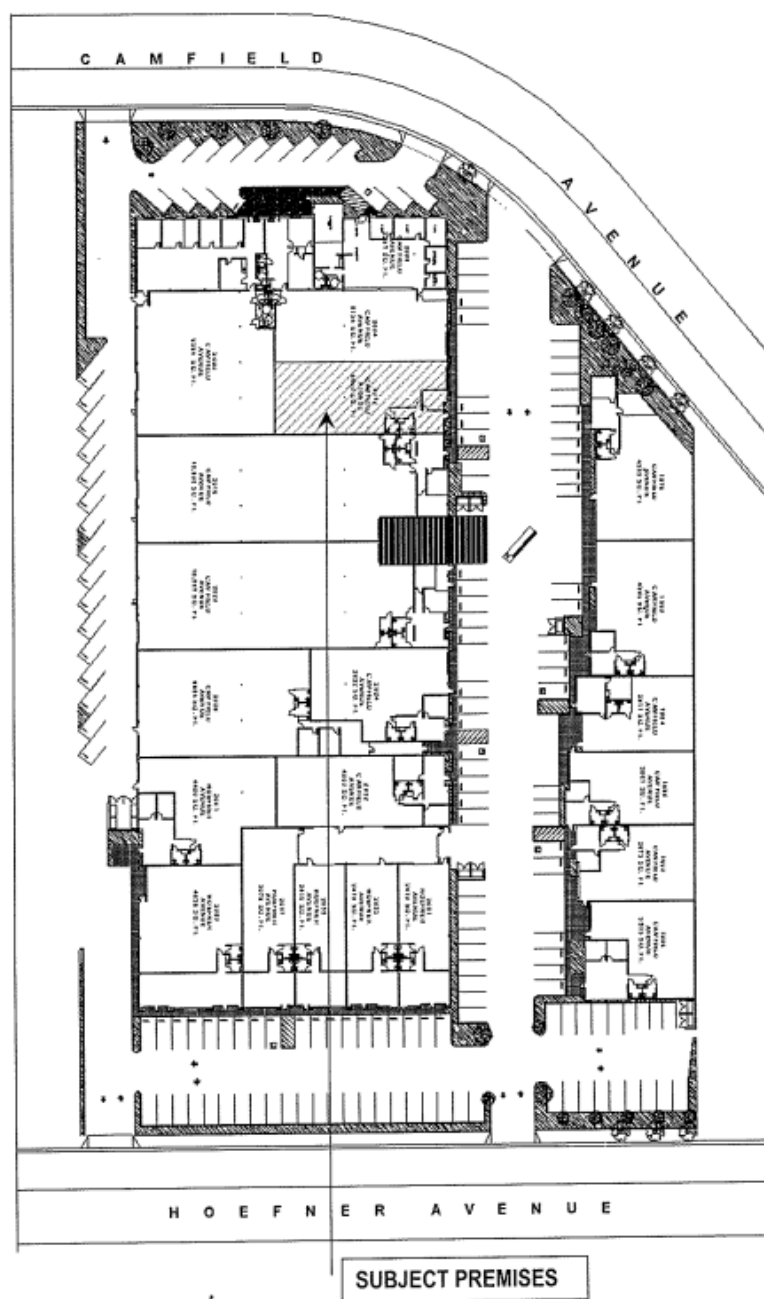

Although all information is furnished regarding for sale, rental or financing is from sources deemed reliable, such information has not been verified and no express representation is made nor is any to be implied as to the accuracy thereof, and it is submitted subject to errors, omissions, changes of price, rental or other conditions, prior sale, lease or financing, or withdrawal without notice.

2012

CAMFIELD AVE
COMMERCE | CA

FOR LEASE

INDUSTRIAL PROPERTY



Although all information is furnished regarding for sale, rental or financing is from sources deemed reliable, such information has not been verified and no express representation is made nor is any to be implied as to the accuracy thereof, and it is submitted subject to errors, omissions, changes of price, rental or other conditions, prior sale, lease or financing, or withdrawal without notice.



2012

CAMFIELD AVE
COMMERCE | CA

FOR LEASE

INDUSTRIAL PROPERTY

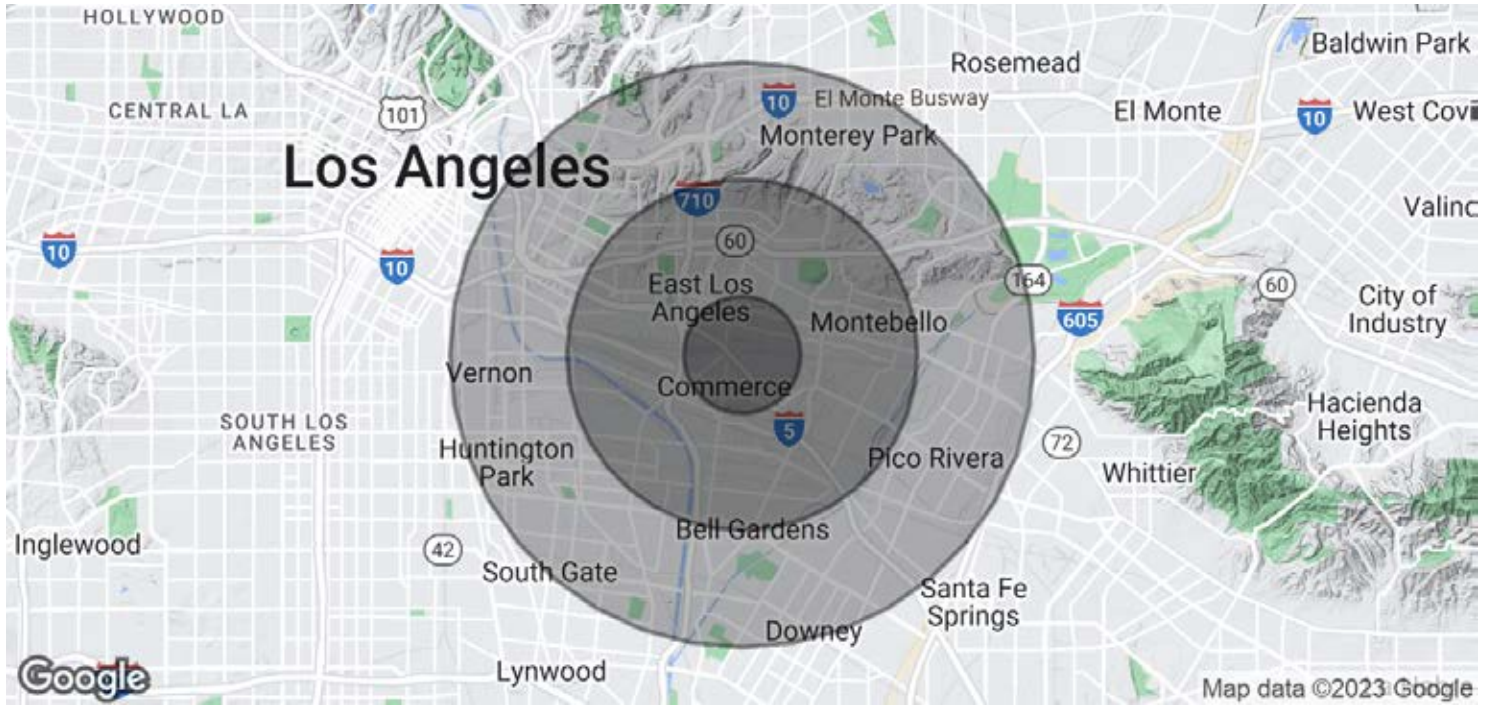

DEMOGRAPHICS

POPULATION	1 MILE	3 MILES	5 MILES
Total population	22,223	248,379	712,038
Median age	34.8	34.0	35.2
Median age (Male)	34.2	33.0	33.9
Median age (Female)	36.2	35.2	36.4
HOUSEHOLDS & INCOME	1 MILE	3 MILES	5 MILES
Total households	5,573	63,443	187,622
# of persons per HH	3.6	3.6	3.5
Average HH income	\$61,996	\$65,827	\$69,900
Average house value	\$367,033	\$450,854	\$472,808

* Demographic data derived from 2020 ACS - US Census

Although all information is furnished regarding for sale, rental or financing is from sources deemed reliable, such information has not been verified and no express representation is made nor is any to be implied as to the accuracy thereof, and it is submitted subject to errors, omissions, changes of price, rental or other conditions, prior sale, lease or financing, or withdrawal without notice.

