

FOR LEASE

CREATIVE OFFICE, SHOWROOM, AND WAREHOUSE

6100

W. JEFFERSON BLVD.

5100

CULVER CITY | CA



For More Information, Contact:

DAVID FREITAG

P: 213.270.2235

dfreitag@daumcre.com

CA License #00855673

IMANI MCMILLAN

P: 213.270.2230

imcmillan@daumcre.com

CA License #02057115

DAUM
COMMERCIAL REAL ESTATE SERVICES

FREESTANDING BUILD

B100

W. JEFFERSON BLVD.

CULVER CITY | CA

PROPERTY HIGHLIGHTS

- Available November 1st, 2021
- 10,000 sq. ft.
- Space can be Divisible Into 4,000 or 6,000 sq. ft.
- Three (3) Ground Level Doors
- Freestanding Building
- Natural Light
- Fully Air Conditioned
- Private Breakout Rooms
- Open Kitchen and Conference Rooms
- Gated Parking Lot – 15 Cars at no Charge
- \$2.95 per sq. ft. Modified Gross

FOR MORE INFORMATION, CONTACT:

DAVID FREITAG

P: 213.270.2235 | M: 310.413.9390
dfreitag@daumcre.com
CA License #00855673

IMANI MCMILLAN

P: 213.270.2230 | M: 310.800.4589
imcmillan@daumcre.com
CA License #02057115

Although all information is furnished regarding for sale, rental or financing is from sources deemed reliable, such information has not been verified and no express representation is made nor is any to be implied as to the accuracy thereof, and it is submitted subject to errors, omissions, changes of price, rental or other conditions, prior sale, lease or financing, or withdrawal without notice. D/AQ Corp. # 01129558

W. JEFFERSON BLVD.

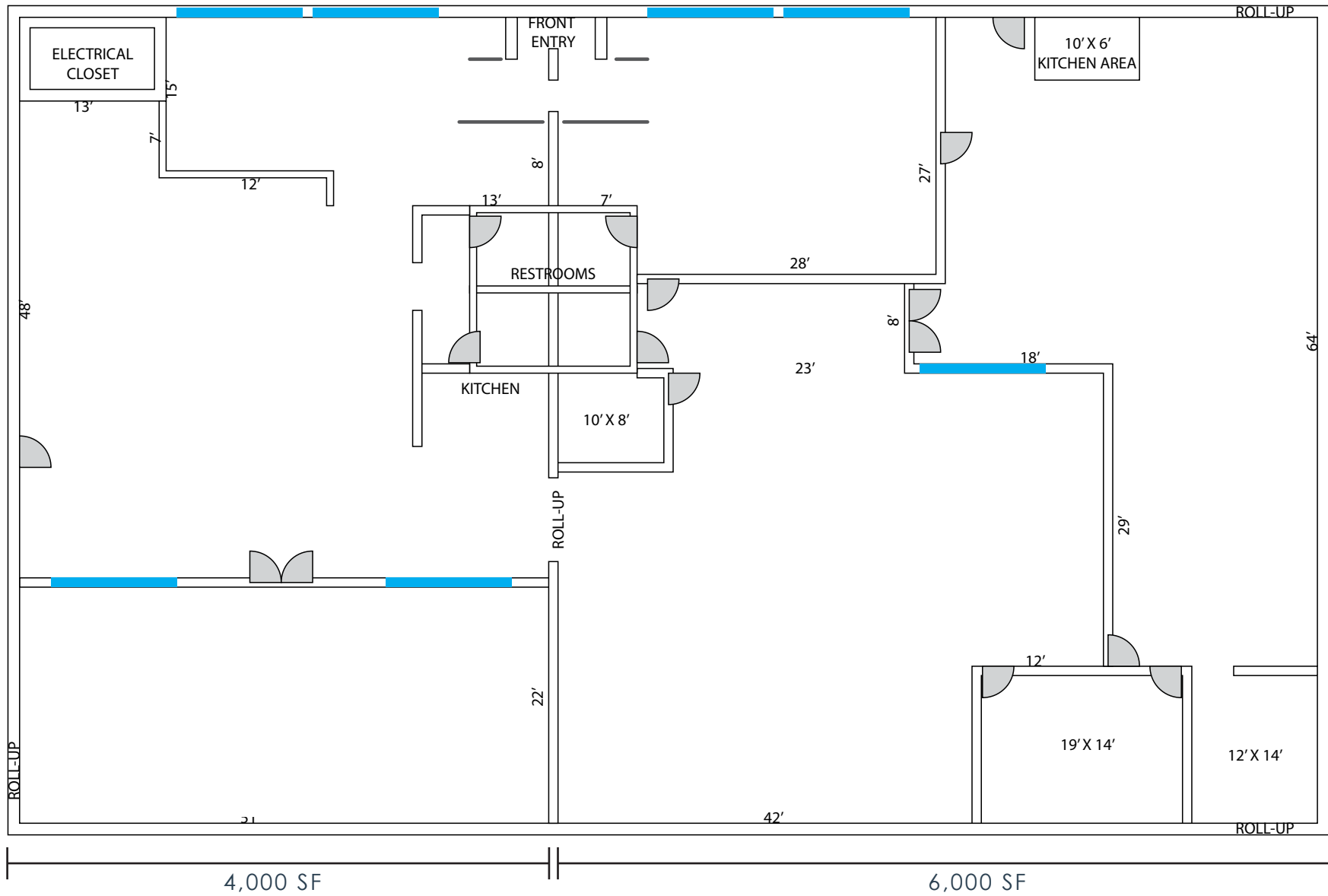



PHOTOS

FREE STADNING BUILDING | CREATIVE OFFICE, SHOWROOM, AND WAREHOUSE | FOR LEASE



PHOTOS

FREE STADNING BUILDING | CREATIVE OFFICE, SHOWROOM, AND WAREHOUSE | FOR LEASE

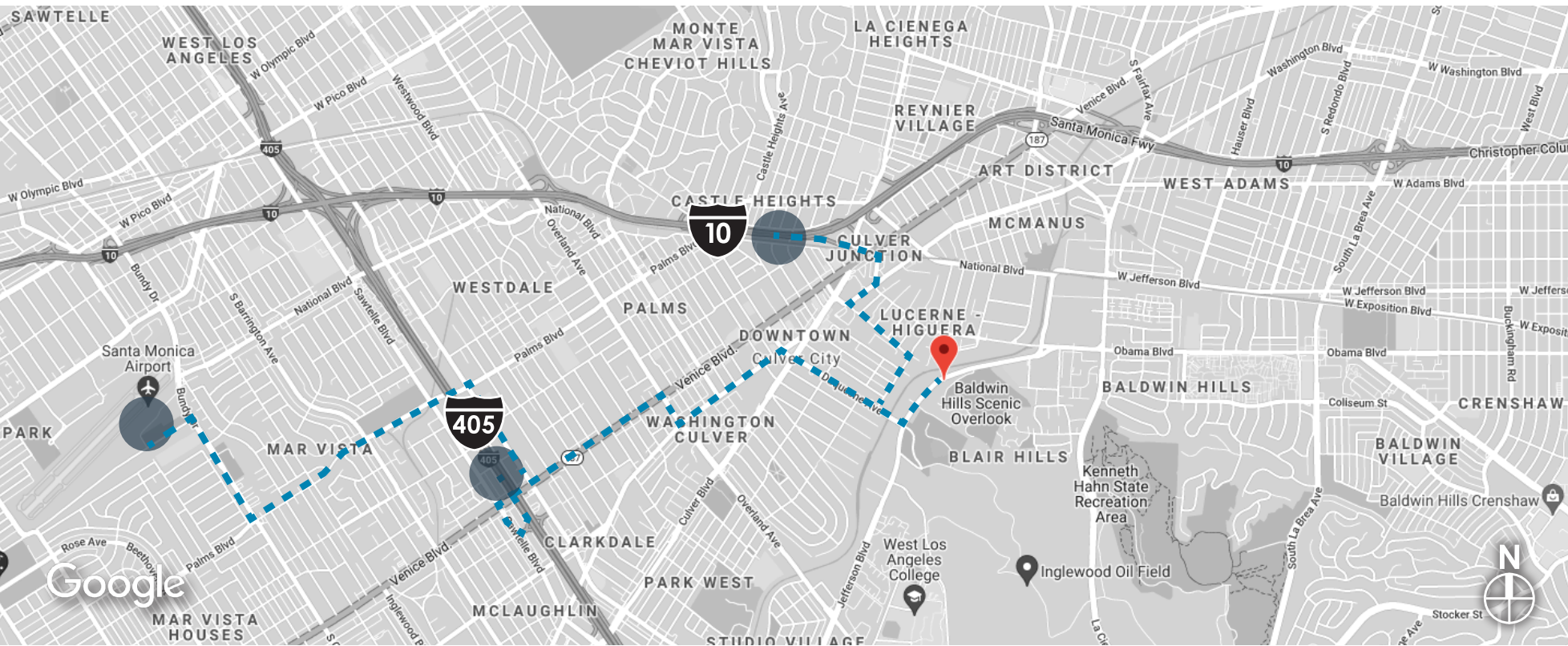

LOCATION

FREE STADNING BUILDING | CREATIVE OFFICE, SHOWROOM, AND WAREHOUSE | FOR LEASE

DEMOGRAPHICS

SOURCE: COSTAR*

POPULATION 2021

+885,524
PEOPLE
(5 MILE RADIUS)

+366,459
HOUSEHOLDS
(5 MILE RADIUS)

\$111,465
AVERAGE HH INCOME
(5 MILE RADIUS)

ECONOMICS

\$13,579,686,293
CONSUMER SPENDING
(5 MILE RADIUS) | 2026



\$12,449,583,339
CONSUMER SPENDING
(5 MILE RADIUS) | 2021

TRAFFIC COUNT

8,549
EASTHAM DR W.
(0.40 MILES FROM PROPERTY - 2020)



24,927
RODEO DR. NO.
(0.41 MILES FROM PROPERTY - 2020)

27,922
W JEFFERSON BLVD W.
(0.53 MILES FROM PROPERTY - 2020)

30,727
KALSMAN DR E.
(0.58 MILES FROM PROPERTY - 2020)

FOR MORE INFORMATION, CONTACT:

DAVID FREITAG

P: 213.270.2235 | M: 310.413.9390
dfreitag@daumcre.com
CA License #00855673

IMANI MCMILLAN

P: 213.270.2230 | M: 310.800.4589
imcmillan@daumcre.com
CA License #02057115

