

# FOR LEASE

## SANTA FE INDUSTRIAL CENTER

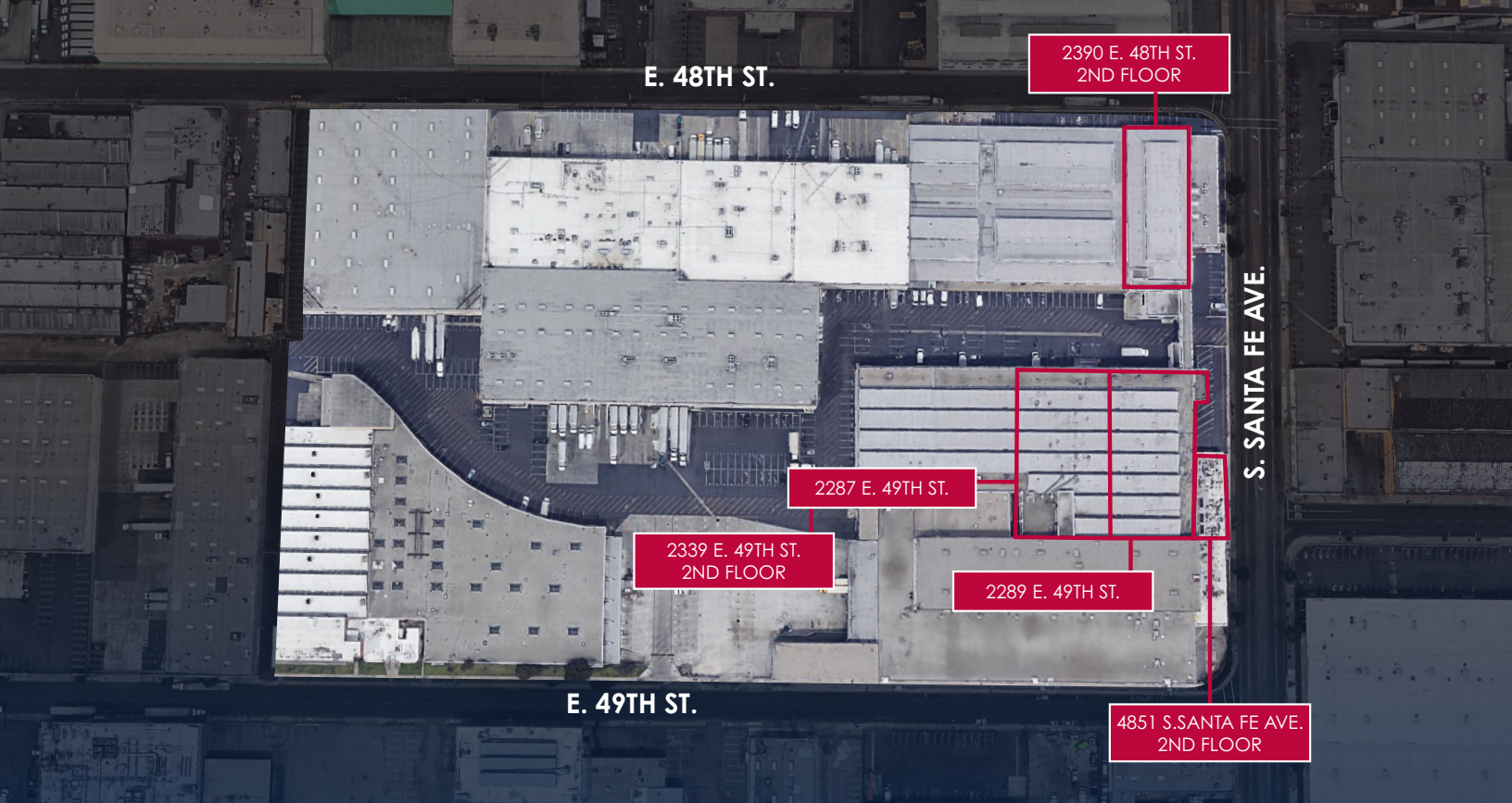

**DAVID FREITAG**  
*Executive Vice President*  
O: 213.270.2235  
david.freitag@daumcommercial.com  
CA License #00855673

**IMANI MCMILLAN**  
*Associate*  
O: 213.270.2230 | C: 310.800.4589  
imani.mcmillan@daumcommercial.com  
CA License # 02057115

**MICHAEL CHASE**  
*Associate*  
O: 213.270.2242 | C: 310.415.0472  
michael.chase@daumcommercial.com  
CA License #02071146



# FOR LEASE | 25,853 SF

## 2289 E. 49TH STREET

### PROPERTY HIGHLIGHTS

- Sprinklered
- 2 DH Doors
- Office: 744 SF
- 27 Parking Spaces
- Clear Height 14'
- Security at Complex
- Asking Price: \$0.55/SF
- CAM Fees \$0.11/SF



Although all information is furnished regarding for sale, rental or financing is from sources deemed reliable, such information has not been verified and no express representation is made nor is any to be implied as to the accuracy thereof, and it is submitted subject to errors, omissions, changes of price, rental or other conditions, prior sale, lease or financing, or withdrawal without notice. All maps courtesy of Google Maps, Bing, and Google Earth. Images courtesy of Pixabay D/AQ Corp. # 01129558



# FOR LEASE | 16,500 SF

4851 S. SANTA FE AVE  
SECOND FLOOR SPACE

## PROPERTY HIGHLIGHTS

- Sprinklered
- 2 DH Doors
- 1 GL Door
- Office: 4,000 SF
- 14 Parking Spaces
- Clear Height 15'
- Abundant Natural Light
- Security at Complex
- Asking Price: \$0.60/SF
- CAM Fee \$0.11/SF

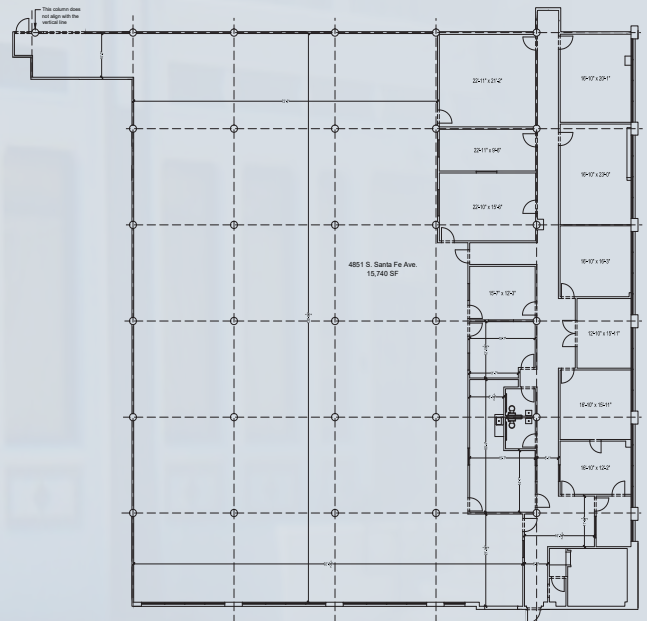

Although all information is furnished regarding for sale, rental or financing is from sources deemed reliable, such information has not been verified and no express representation is made nor is any to be implied as to the accuracy thereof, and it is submitted subject to errors, omissions, changes of price, rental or other conditions, prior sale, lease or financing, or withdrawal without notice. All maps courtesy of Google Maps, Bing, and Google Earth. Images courtesy of Pixabay D/AQ Corp. # 01129558



# FOR LEASE | 14,458 SF

2390 E. 48TH STREET  
SECOND FLOOR SPACE

## PROPERTY HIGHLIGHTS

- Sprinklered
- 2 DH Doors
- Office: 1,000 SF
- 17 Parking Spaces
- Clear Height 18'
- Abundant Natural Light
- Exclusive Use of two Elevators
- Security at Complex
- Asking Price: \$0.67/SF
- CAM Fees \$0.11/SF



Although all information is furnished regarding for sale, rental or financing is from sources deemed reliable, such information has not been verified and no express representation is made nor is any to be implied as to the accuracy thereof, and it is submitted subject to errors, omissions, changes of price, rental or other conditions, prior sale, lease or financing, or withdrawal without notice. All maps courtesy of Google Maps, Bing, and Google Earth. Images courtesy of Pixabay D/AQ Corp. # 01129558



# FOR LEASE | 11,233 SF

2339 E. 49TH STREET  
SECOND FLOOR SPACE

## PROPERTY HIGHLIGHTS

- Sprinklered
- 2 DH Doors
- 1 GL Door
- Office: 924 SF
- 10 Parking Spaces
- Clear Height 14'
- Abundant Natural Light
- Security at Complex
- Asking Price: \$0.69/SF
- CAM Fees \$0.11/SF

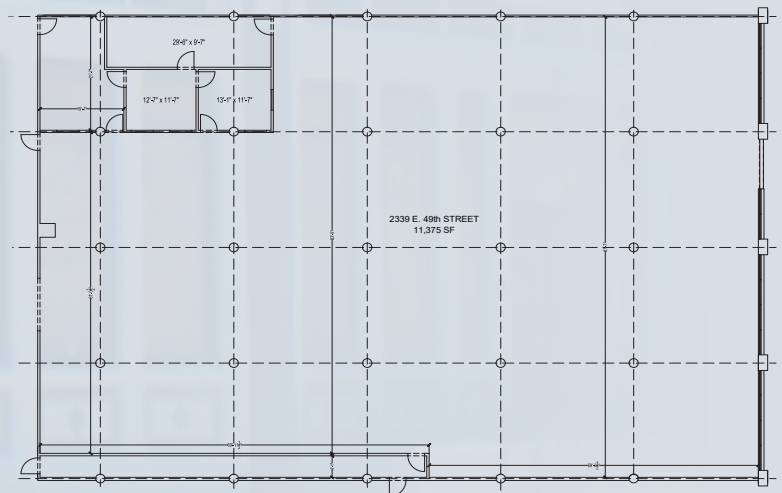

Although all information is furnished regarding for sale, rental or financing is from sources deemed reliable, such information has not been verified and no express representation is made nor is any to be implied as to the accuracy thereof, and it is submitted subject to errors, omissions, changes of price, rental or other conditions, prior sale, lease or financing, or withdrawal without notice. All maps courtesy of Google Maps, Bing, and Google Earth. Images courtesy of Pixabay D/AQ Corp. # 01129558



# FOR LEASE | 9,662 SF

## 2287 E. 49TH STREET

### PROPERTY HIGHLIGHTS

- Sprinklered
- 2 DH Doors
- 1 GL Door
- Office: 156 SF
- 10 Parking Spaces
- Clear Height 12'
- Security at Complex
- Asking Price: \$0.74/SF
- CAM Fees \$0.11/SF

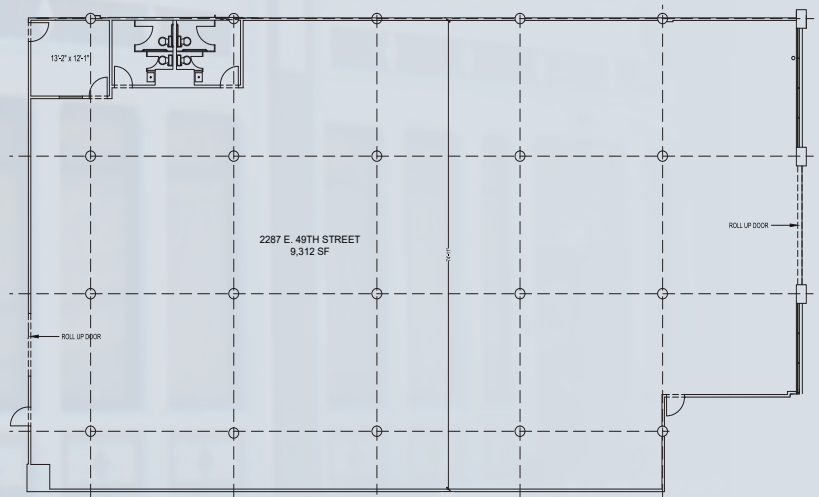

Although all information is furnished regarding for sale, rental or financing is from sources deemed reliable, such information has not been verified and no express representation is made nor is any to be implied as to the accuracy thereof, and it is submitted subject to errors, omissions, changes of price, rental or other conditions, prior sale, lease or financing, or withdrawal without notice. All maps courtesy of Google Maps, Bing, and Google Earth. Images courtesy of Pixabay D/AQ Corp. # 01129558