

**PREMIER INLAND EMPIRE WEST LOCATION**  
BUILDING 3 – 68,110 SF

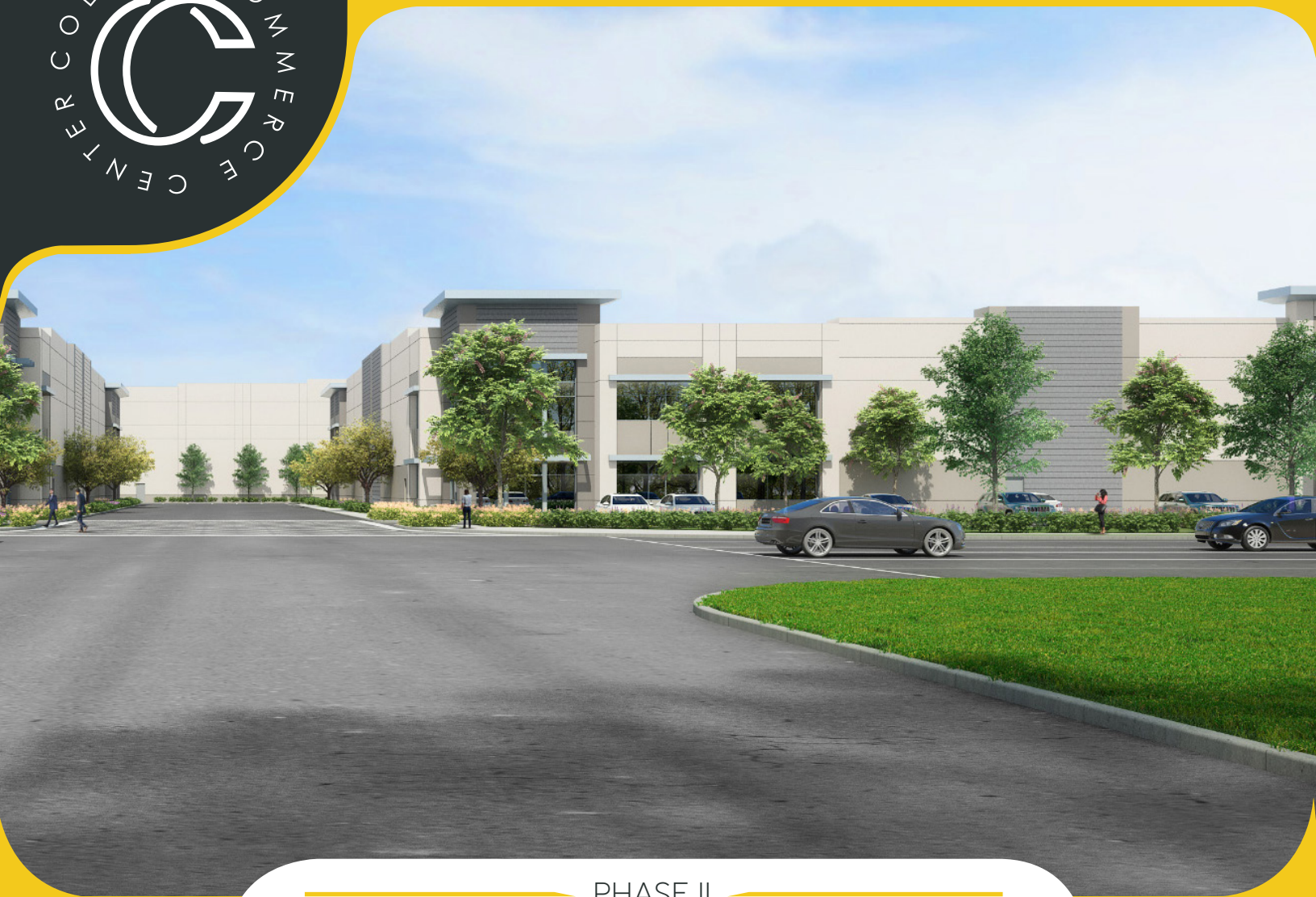

PHASE II

## **COLONY COMMERCE CENTER**

2580 East Merrill Ave., Ontario, CA

Colony Commerce Center, Phase II is a world class development in Ontario, CA consisting of nine (9) industrial buildings ranging in size from 41,210 to 1,000,930 square feet. The Project's strategic location on the western-edge of the Inland Empire marketplace produces the closest proximity to Los Angeles and Orange County with immediate access via the I-15, SR-60 and SR-71 freeway systems.

Building 3 is located in Phase II of the Colony Commerce Center. Situated on 3.13 acres and totaling 68,110 SF of rentable area, Building 3 boasts every feature and specification for a state-of-the-art industrial facility.



**Groundbreaking Q1 2019**

[www.Colony-Commerce-Center.com](http://www.Colony-Commerce-Center.com)



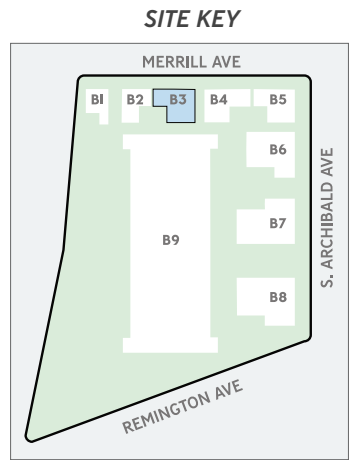
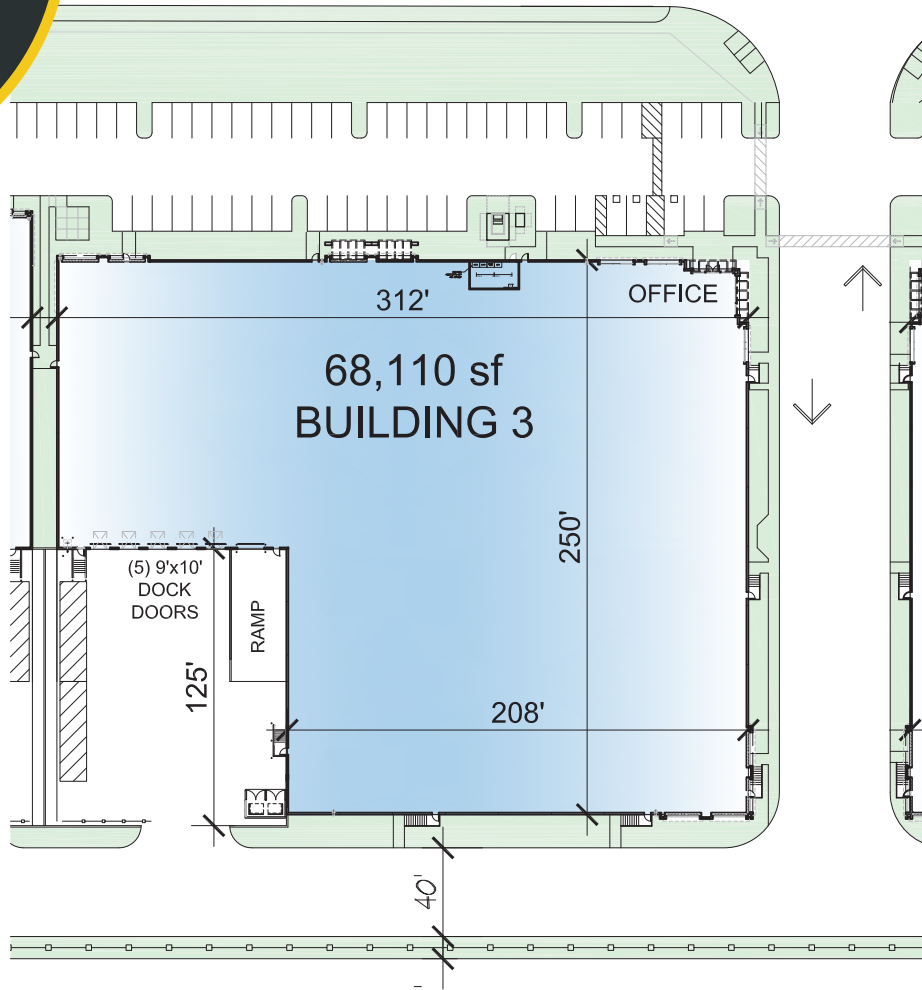

## BUILDING SPECIFICATIONS

- **68,110 SF** Total Rentable Area
- **3.13** Acres
- **±5,225 SF** High-Finish Office Space
- **50.0%** Site Coverage
- **30'** Clear Height
- **125'** Truck Court Depths
- **5** Dock High Doors
- **1** Ground Level Doors
- **59** Auto Parking Stalls
- **Fully Secured** Truck Yards
- **100% Concrete** Truck Courts & Parking Areas
- **10 Year** NDL Warranty
- **50' x 52'** Column Spacing (Typical)
- **ESFR** Sprinkler System
- **2,000 AMP** 277/480 Volt Electrical Service (Expandable)
- **2%** Skylights
- **Min 6"** Floor Slab Thickness
- **Environmentally Stable** Design
- **Q1 2020** Anticipated Delivery Date

LEADING SUBMARKET IN WESTERN INLAND EMPIRE

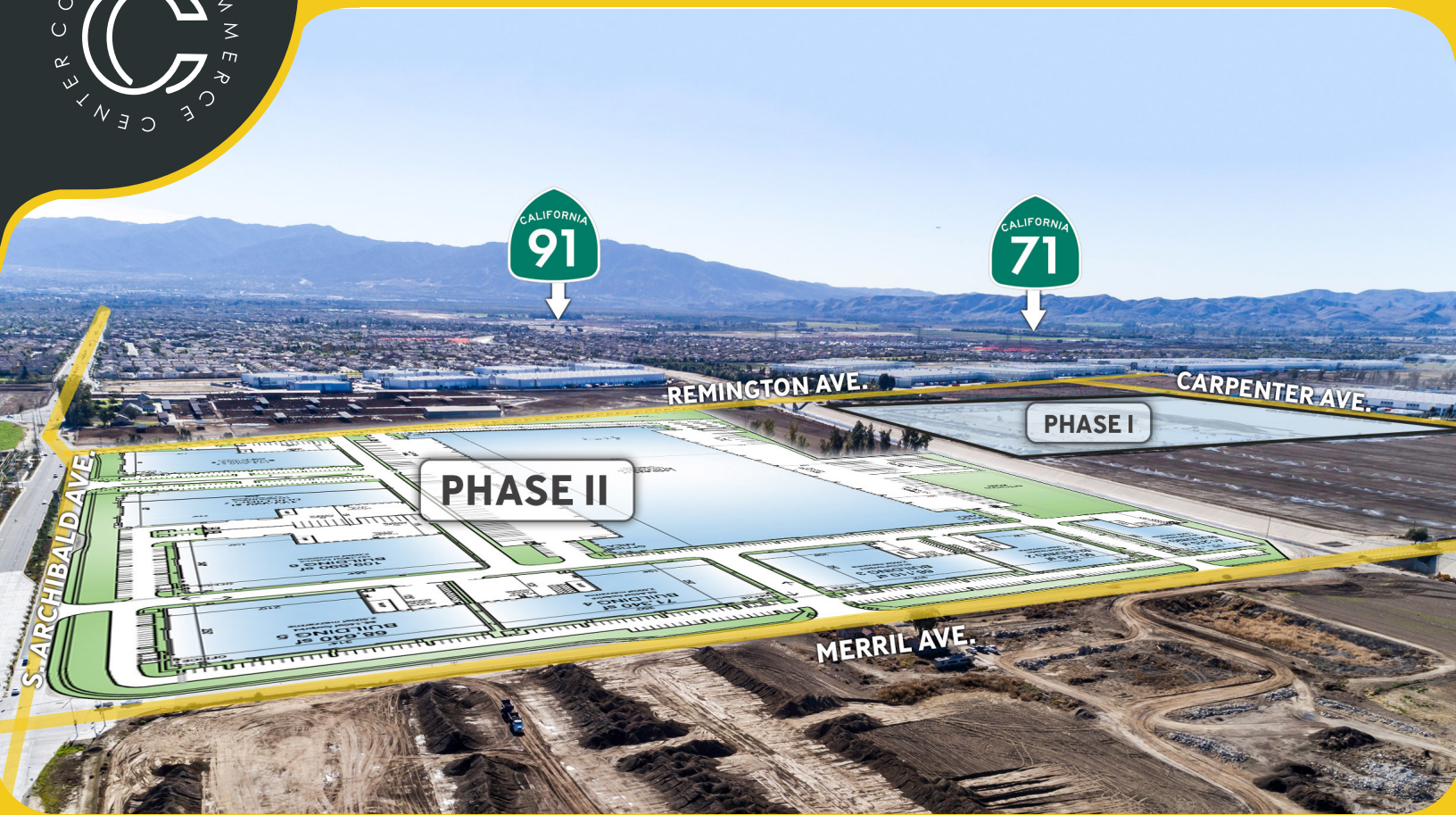

# EXCEPTIONAL TRANSPORTATION ROUTE ACCESS

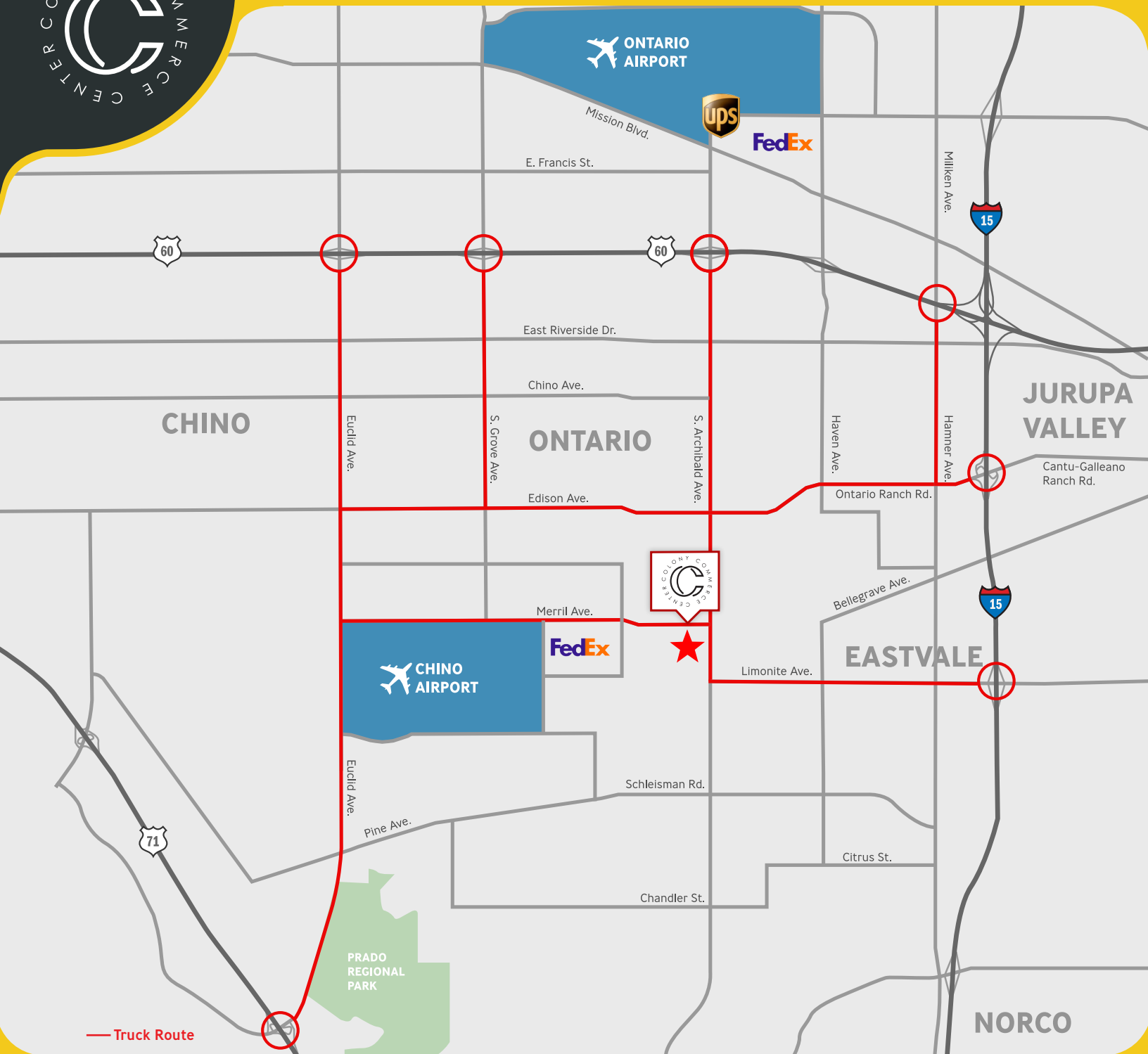

**I-15** - 1.7 mi  
**SR 60** - 3.3 mi  
**SR 71** - 7 mi  
**SR 91** - 11.2 mi



**Port of Long Beach** - 55 mi  
**Port of Los Angeles** - 56 mi



**Ontario International (OIA)** - 5.4 mi  
**Orange County (SNA)** - 34.5 mi  
**Los Angeles (LAX)** - 58 mi



**BNSF Intermodal (San Bernardino)** - 24 mi  
**Union Pacific Intermodal (Industry)** - 24 mi

PROUDLY OWNED BY



**Ivanhoé  
Cambridge**

CDP Capital  
Groupe immobilier

ANOTHER QUALITY PROJECT BY



FOR MORE INFORMATION, CONTACT

**PATRICK WOOD**

SENIOR VICE PRESIDENT

T) 909.467.6857

Patrick.Wood@am.jll.com

CA License #01776274

**MIKE MCCRARY**

MANAGING DIRECTOR

T) 909.467.6885

Mike.McCrary@am.jll.com

CA License #01054055

**GUS ANDROS**

EXECUTIVE VICE PRESIDENT

T) 909.912.0003

Gandros@daumcre.com

CA License #01129558

**ERIC FIKSE**

EXECUTIVE VICE PRESIDENT

T) 909.652.9056

Efikse@daumcre.com

CA License #01457380

**PETER MCWILLIAMS**

INTERNATIONAL DIRECTOR

T) 909.467.6860

Peter.McWilliams@am.jll.com

CA License #00973278

**ERIC CHOU 周政勳**

VICE PRESIDENT

T) 909.467.6856

Eric.Chou@am.jll.com

CA License #01952666

**RICK JOHN | SIOR**

EXECUTIVE VP | BRANCH MGR.

T) 909.912.0001

Rj@daumcommercial.com

CA License #00800783



Jones Lang LaSalle Brokerage, Inc.  
3281 E. Guasti Rd., Suite 850  
Ontario, CA 91761



DAUMCRE | Ontario Branch  
3595 Inland Empire Blvd., Bldg. 5  
Ontario, CA 91764

[www.Colony-Commerce-Center.com](http://www.Colony-Commerce-Center.com)