

# STATE-OF-THE-ART INDUSTRIAL IN MOORPARK

FOR SALE OR LEASE 201,976 SF



**DAUM**  
COMMERCIAL REAL ESTATE SERVICES

**6000**  
CONDOR DRIVE

MOORPARK | CALIFORNIA

Another Exciting Project By:

**TRANSWESTERN®**

## STRATEGIC LOCATION

Centered in Moorpark, California  
(85,088 Population Within a 5 Mile Radius)

## ACCESSIBLE

Close Proximity to the 118, 23, & 101  
Freeways (28,123 Households Within  
a 5 Mile Radius)

## VISIBLE

Within 15 minutes of Westlake Village &  
less than 5 minutes of Moorpark College

D/AQ Corp. #01129558. Maps Courtesy ©Google & ©Microsoft. Although all information is furnished regarding for sale, rental or financing is from sources deemed reliable, such information has not been verified and no express representation is made nor is any to be implied as to the accuracy thereof, and it is submitted subject to errors, omissions, changes of price, rental or other conditions, prior sale, lease or financing, or withdrawal without notice.



## LOCAL HIGHLIGHTS



**+1.7 MILES**  
COMMUTER RAIL



CONVENIENT TO  
WESTLAKE VILLAGE  
& LAKE SHERWOOD



**+31.8 MILES**  
PORT OF HUENEME



**+29 MILES**  
MALIBU BEACH



## STATE-OF-THE-ART BUILDING

**+ CONCRETE TILT UP CONSTRUCTION**

## PROJECT FEATURES



24'  
clear  
height



16  
truck high  
doors



4  
ground level  
doors



2,500 Amps  
277/480 Volt  
power



405  
parking  
space



118,101 & 23  
close  
proximity



11.87 AC  
lot size



48'x48'  
column  
spacing



.33/3,000  
fire sprinklers

For More Information, Contact:

**BRAM WHITE, SIOR**  
DAUM COMMERCIAL

O: 805.384.8840 | C: 805.320.1000  
bram.white@daumcommercial.com  
CA BRE License # 00356063

**DON THORDARSON**

DONALD J. THORDARSON, INC

O: 818.832.4929 | C: 818.294.3010 | F: 818.832.8938  
djthordarsoninc@socal.rr.com  
CA BRE License # 00671906

Another Exciting Project By:



**TRANSWESTERN®**



D/AQ Corp. #01129558. Maps Courtesy ©Google & ©Microsoft. Although all information is furnished regarding for sale, rental or financing is from sources deemed reliable, such information has not been verified and no express representation is made nor is any to be implied as to the accuracy thereof, and it is submitted subject to errors, omissions, changes of price, rental or other conditions, prior sale, lease or financing, or withdrawal without notice.



[6000]

CONDOR DRIVE

MOORPARK | CALIFORNIA

INTERIOR RENDERINGS



For More Information, Contact:

**BRAM WHITE, SIOR**  
**DAUM COMMERCIAL**

O: 805.384.8840 | C: 805.320.1000  
bram.white@daumcommercial.com  
CA BRE License # 00356063



**DON THORDARSON**  
**DONALD J. THORDARSON, INC**

O: 818.832.4929 | C: 818.294.3010 | F: 818.832.8938  
djthordarsoninc@socal.rr.com  
CA BRE License # 00671906

Another Exciting Project By:

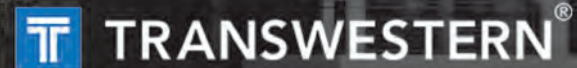

D/AQ Corp. #01129558. Maps Courtesy ©Google & ©Microsoft. Although all information is furnished regarding for sale, rental or financing is from sources deemed reliable, such information has not been verified and no express representation is made nor is any to be implied as to the accuracy thereof, and it is submitted subject to errors, omissions, changes of price, rental or other conditions, prior sale, lease or financing, or withdrawal without notice.



# [6000]

CONDOR DRIVE

MOORPARK | CALIFORNIA

## SITE PLAN

The dramatic, comprehensive improvement will include eight (8) new truck high doors, a new roof, new parking surfaces, new paint, new restrooms and landscape enhancement.

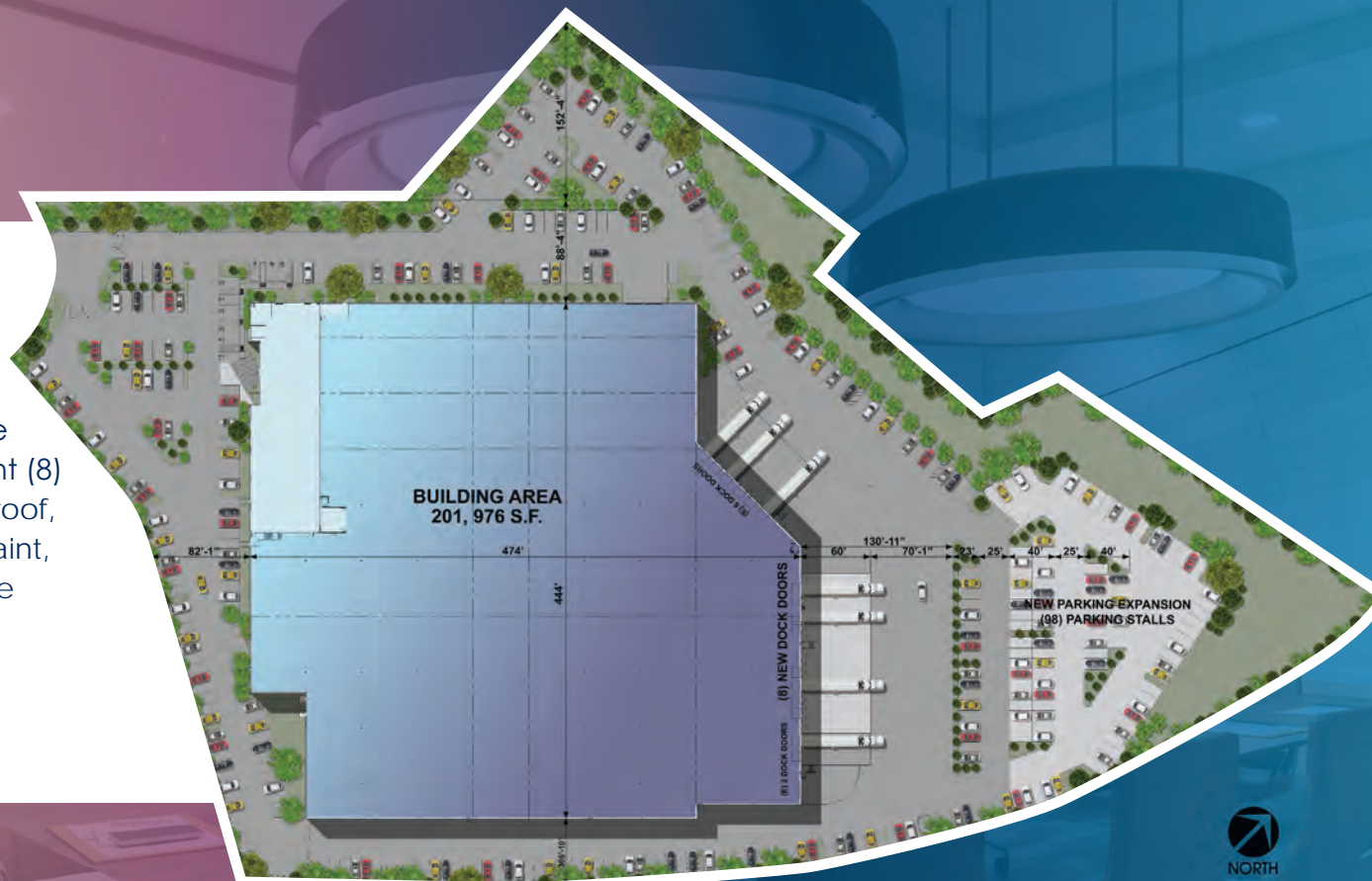

For More Information, Contact:

**BRAM WHITE, SIOR**  
DAUM COMMERCIAL

O: 805.384.8840 | C: 805.320.1000  
bram.white@daumcommercial.com  
CA BRE License # 00356063

**DON THORDARSON**

DONALD J. THORDARSON, INC

O: 818.832.4929 | C: 818.294.3010 | F: 818.832.8938  
djthordarsoninc@socal.rr.com  
CA BRE License # 00671906

Another Exciting Project By:

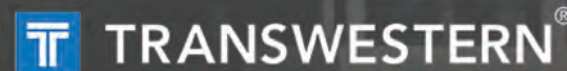

D/AQ Corp. #01129558. Maps Courtesy ©Google & ©Microsoft. Although all information is furnished regarding for sale, rental or financing is from sources deemed reliable, such information has not been verified and no express representation is made nor is any to be implied as to the accuracy thereof, and it is submitted subject to errors, omissions, changes of price, rental or other conditions, prior sale, lease or financing, or withdrawal without notice.

[6000]  
CONDOR DRIVE

MOORPARK | CALIFORNIA

## SITE PLAN 2

Alternate site plan for  
trailer storage



For More Information, Contact:

**BRAM WHITE, SIOR**  
DAUM COMMERCIAL

O: 805.384.8840 | C: 805.320.1000  
bram.white@daumcommercial.com  
CA BRE License # 00356063

**DON THORDARSON**

DONALD J. THORDARSON, INC

O: 818.832.4929 | C: 818.294.3010 | F: 818.832.8938  
djthordarsoninc@socal.rr.com  
CA BRE License # 00671906

Another Exciting Project By:

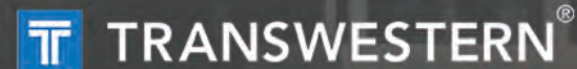

**DAUM**  
COMMERCIAL REAL ESTATE SERVICES

D/AQ Corp. #01129558. Maps Courtesy ©Google & ©Microsoft. Although all information is furnished regarding for sale, rental or financing is from sources deemed reliable, such information has not been verified and no express representation is made nor is any to be implied as to the accuracy thereof, and it is submitted subject to errors, omissions, changes of price, rental or other conditions, prior sale, lease or financing, or withdrawal without notice.



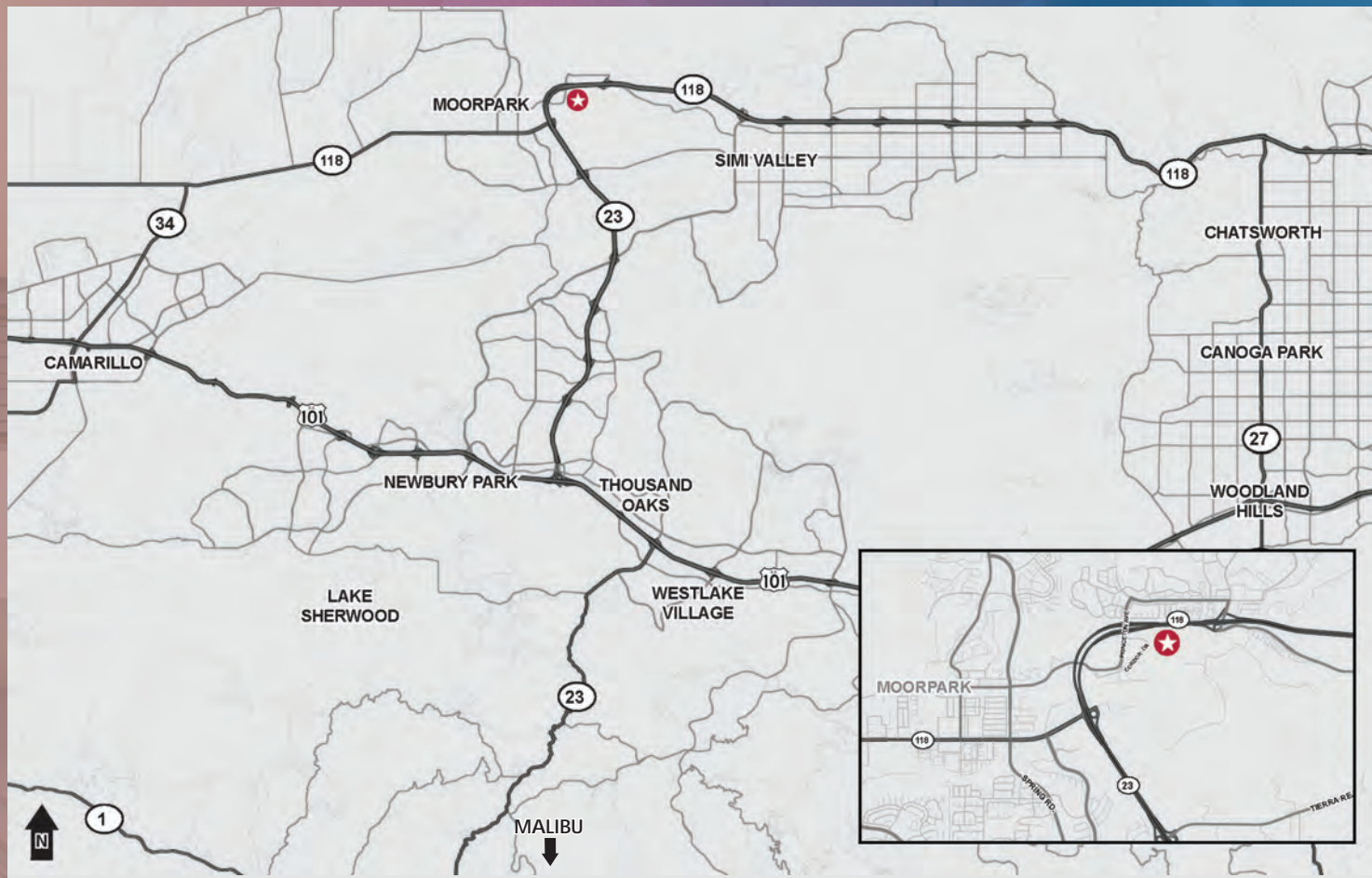

# [6000]

CONDOR DRIVE

MOORPARK | CALIFORNIA

## LOCATION



**+85,088**  
PEOPLE  
(5 MILE RADIUS)



**+ 28,123**  
HOUSEHOLDS  
(5 MILE RADIUS)



**\$107,417**  
HH INCOME  
(5 MILE RADIUS)

For More Information, Contact:

**BRAM WHITE, SIOR**  
DAUM COMMERCIAL

O: 805.384.8840 | C: 805.320.1000  
bram.white@daumcommercial.com  
CA BRE License # 00356063

**DON THORDARSON**

DONALD J. THORDARSON, INC

O: 818.832.4929 | C: 818.294.3010 | F: 818.832.8938  
djthordarsoninc@socal.rr.com  
CA BRE License # 00671906

Another Exciting Project By:



**TRANSWESTERN®**



D/AQ Corp. #01129558. Maps Courtesy ©Google & ©Microsoft. Although all information is furnished regarding for sale, rental or financing is from sources deemed reliable, such information has not been verified and no express representation is made nor is any to be implied as to the accuracy thereof, and it is submitted subject to errors, omissions, changes of price, rental or other conditions, prior sale, lease or financing, or withdrawal without notice.



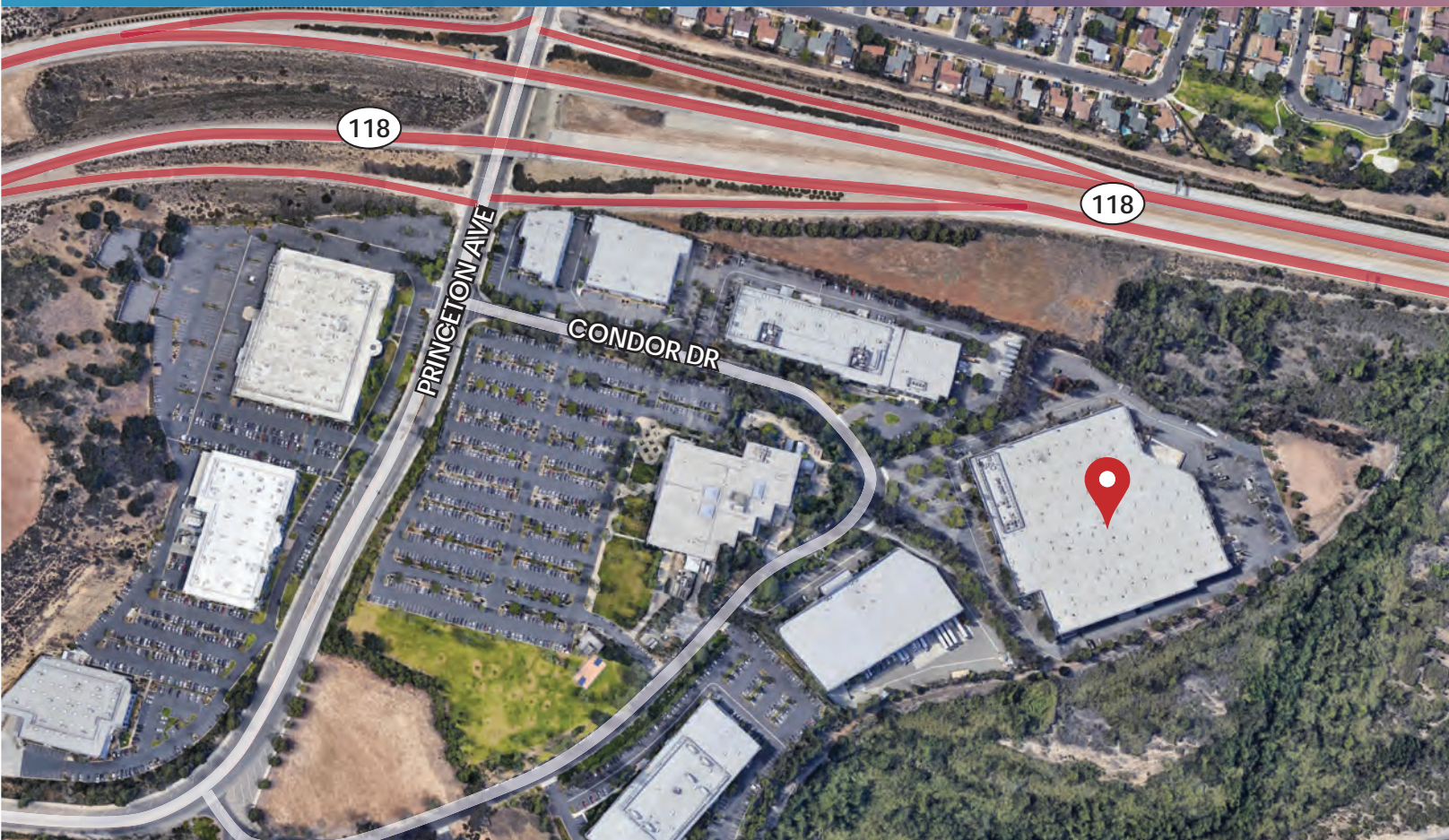

6000

CONDOR DRIVE

MOORPARK | CALIFORNIA

# STATE-OF-THE-ART INDUSTRIAL IN MOORPARK

FOR SALE OR LEASE 201,976 SF

AERIAL

For More Information, Contact:

**BRAM WHITE, SIOR**  
DAUM COMMERCIAL

O: 805.384.8840 | C: 805.320.1000  
bram.white@daumcommercial.com  
CA BRE License # 00356063

**DON THORDARSON**

DONALD J. THORDARSON, INC

O: 818.832.4929 | C: 818.294.3010 | F: 818.832.8938  
djthordarsoninc@socal.rr.com  
CA BRE License # 00671906

Another Exciting Project By:



**TRANSWESTERN®**

**DAUM**  
COMMERCIAL REAL ESTATE SERVICES

D/AQ Corp. #01129558. Maps Courtesy ©Google & ©Microsoft. Although all information is furnished regarding for sale, rental or financing is from sources deemed reliable, such information has not been verified and no express representation is made nor is any to be implied as to the accuracy thereof, and it is submitted subject to errors, omissions, changes of price, rental or other conditions, prior sale, lease or financing, or withdrawal without notice.