

FOR LEASE ± 26,136 SF  
CLASS A INDUSTRIAL WAREHOUSE  
& OFFICE IN GARDENA

14  
95

W E S T  
1 3 9 T H  
S T R E E T  
GARDENA | CA

“ideal central location between  
los angeles airport & ports”

 **DAUM**  
COMMERCIAL REAL ESTATE SERVICES

**LARA TEAM**

D/AQ Corp. #01129558. Maps Courtesy ©Google & ©Microsoft. Although all information is furnished regarding for sale, rental or financing is from sources deemed reliable, such information has not been verified and no express representation is made nor is any to be implied as to the accuracy thereof, and it is submitted subject to errors, omissions, changes of price, rental or other conditions, prior sale, lease or financing, or withdrawal without notice.

[www.lara-team.com](http://www.lara-team.com) | [www.daumcommercial.com](http://www.daumcommercial.com) | **ONCOR INTERNATIONAL**





SUBJECT PROPERTY

14  
95

WEST  
139TH  
STREET  
GARDENA | CA



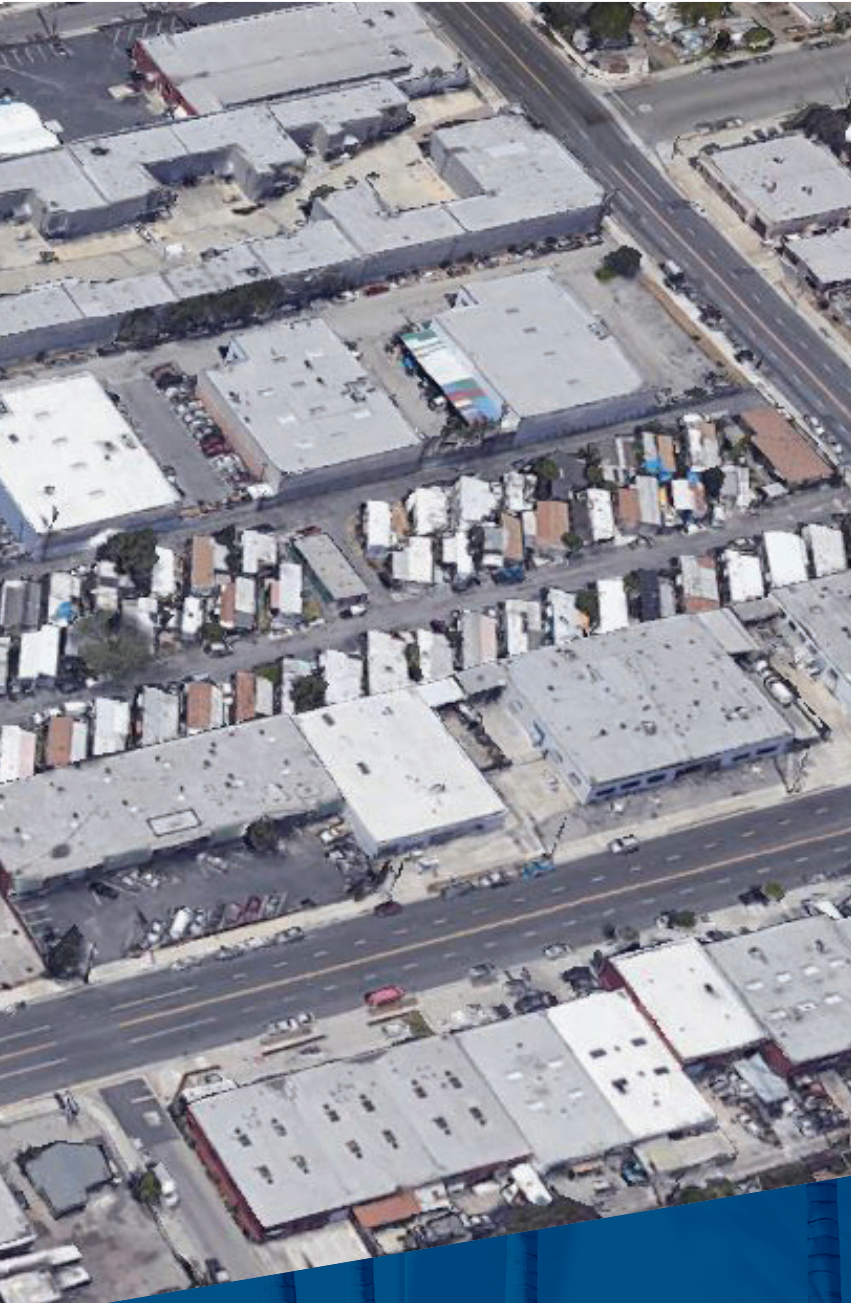

## PROPERTY FEATURES

- Ideal Central location between LAX and Ports
- Lot Size: 43,713 Sq. Ft.
- Office Area: 1,304 SF
- Power: 800 Amps, 480/277
- Year Built: 1999
- (3) dock high doors 10'x 10'
- (1) Drive-In Ramp Door 12'x 14'
- Truck well
- Concrete truck court
- Private side yard with easy drive in accessibility
- 4 Offices and 1 Lobby
- 33 Free Surface parking spaces
- Sprinkler System: 0.60/2,000

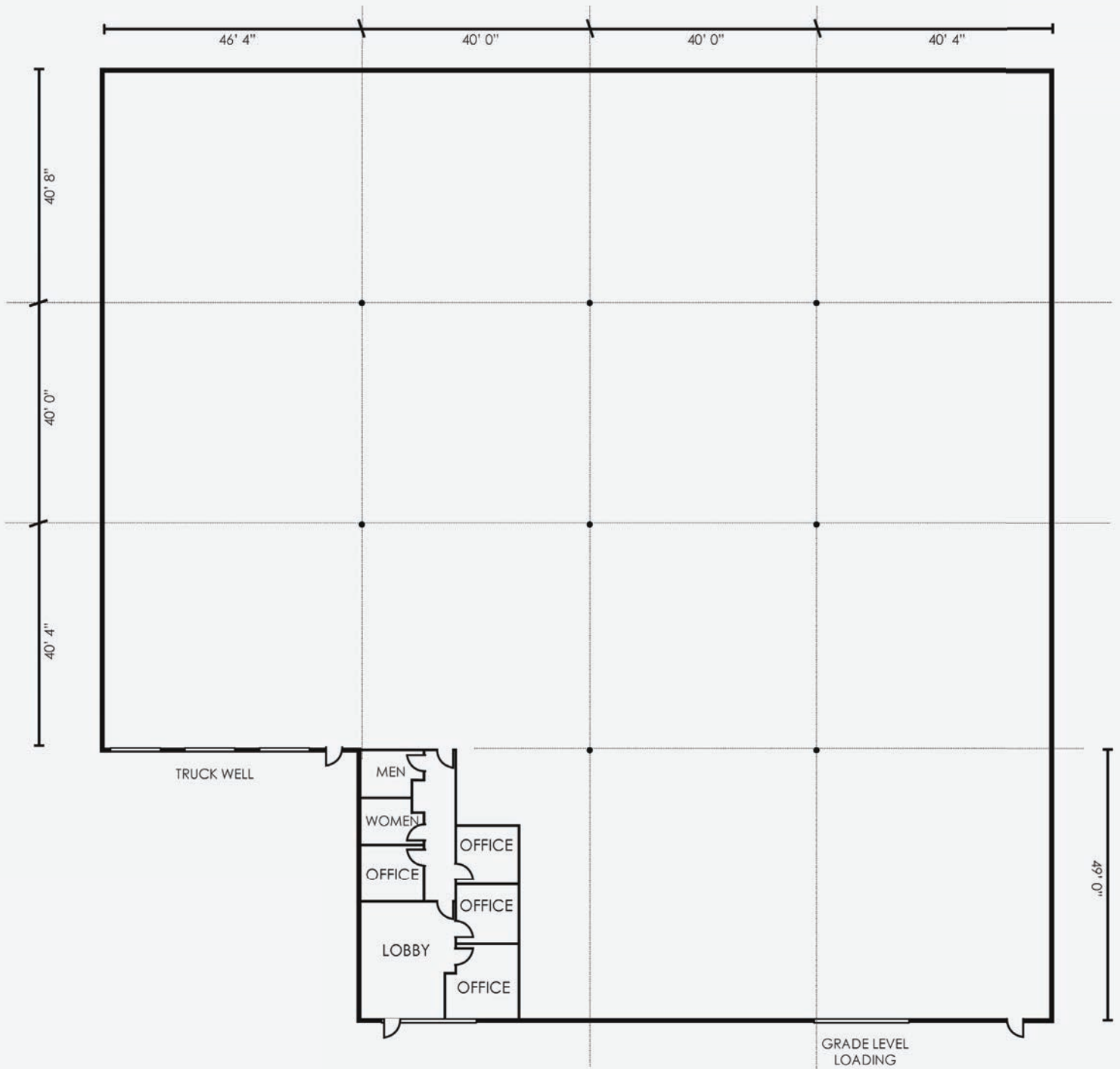

**14  
95**  
WEST  
139TH  
STREET  
GARDENA | CA



±26,136 SF  
BUILDING AREA



1,304 SF  
OFFICE AREA



3  
DH LOADING  
DOORS



26'-29'6"  
CLEAR HEIGHT

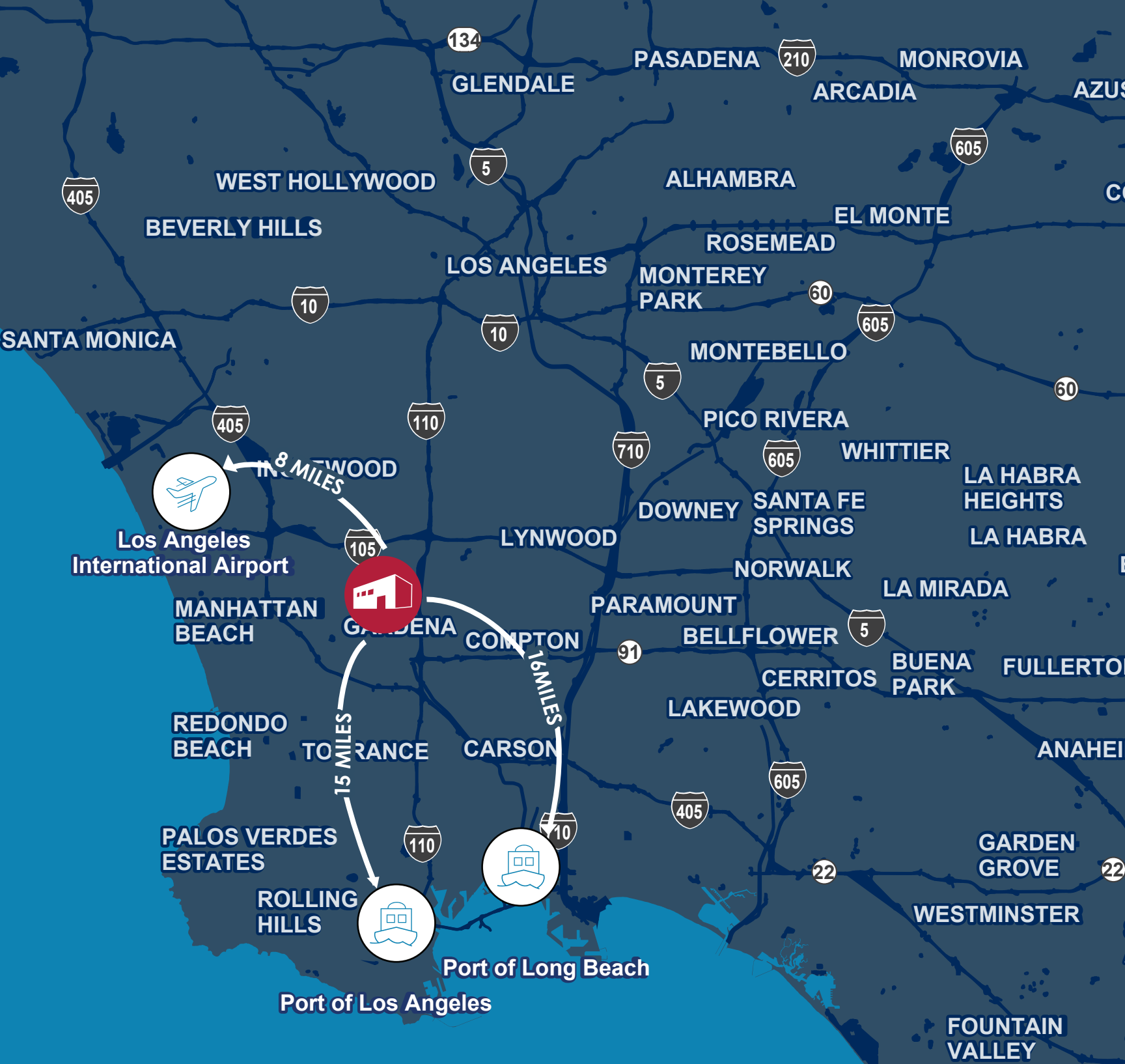

## Key Distances



CA-105  
1 mile



CA-110  
0.7 miles



CA-405  
9 miles



CA-710  
6 miles



Port of Long Beach  
16 miles



Port of Los Angeles  
16 miles



LAX  
8 miles



For More Information, Contact:

Andrew Lara, SIOR, CCIM  
Executive V.P./Principal  
(310) 538-6744  
alara@daumcre.com  
BRE LIC. #01820297

Jordan Lara  
Executive V.P./Principal  
(310) 538-6789  
jlara@daumcre.com  
BRE LIC. #01877128

Rudy Lara, SIOR  
Executive V.P./Principal  
(714) 273-6515  
rlara@daumcre.com  
BRE LIC. #00833860

Natalie Lara  
Associate  
(714) 616-0203  
natalie.lara@daumcommercial.com  
BRE LIC. #02044707

**DAUM**  
COMMERCIAL REAL ESTATE SERVICES

**LARA TEAM**

**14  
95**  
WEST  
139TH  
STREET  
GARDENA | CA

