



**REFURBISHMENT COMPLETE**

INDUSTRIAL PROPERTY  
**FOR LEASE**

**901 SLAUSON AVE.**  
LOS ANGELES | CA, 90011



**9,783 SF**  
SQUARE FEET



**600**  
OFFICE SF

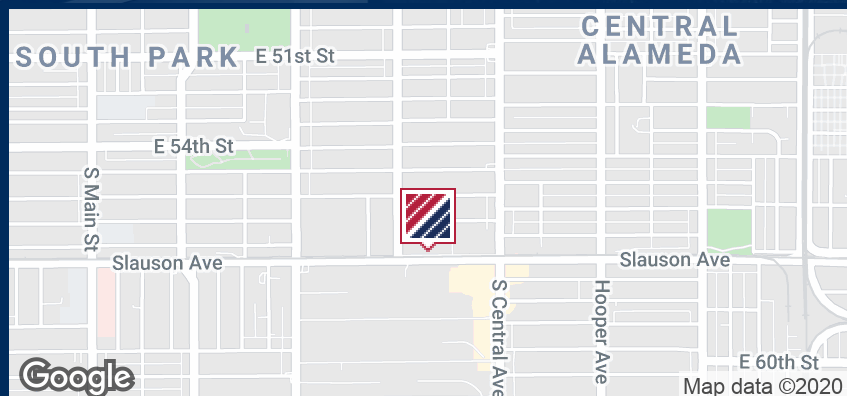

FOR MORE INFORMATION PLEASE CONTACT:

**DAVID FREITAG**

EXECUTIVE VICE PRESIDENT

P: 213.270.2235

david.freitag@daumcommercial.com

CABRE #00855673

**CARLOS CASTILLO**

ASSOCIATE

P: 213.270.2263 | M: 213.842.5877

ccastillo@daumcommercial.com

CABRE #01451618

Although all information is furnished regarding for sale, rental or financing is from sources deemed reliable, such information has not been verified and no express representation is made nor is any to be implied as to the accuracy thereof, and it is submitted subject to errors, omissions, changes of price, rental or other conditions, prior sale, lease or financing, or withdrawal without notice.

**DAUM**  
COMMERCIAL REAL ESTATE SERVICES



# 901

SLAUSON AVE.  
LOS ANGELES | CA

# FOR LEASE

INDUSTRIAL PROPERTY



## PROPERTY HIGHLIGHTS

- Freestanding Building
- Dock High Loading
- Fenced Yard
- 6 Blocks East of 110 (Harbor) Freeway, Minutes From Downtown
- CAM Fee: \$0.08/SF

## OFFERING SUMMARY

Lease Rate:	\$0.83/SF month (Gross)
Available SF:	9,783 SF
Building Size:	19,381 SF

Although all information is furnished regarding for sale, rental or financing is from sources deemed reliable, such information has not been verified and no express representation is made nor is any to be implied as to the accuracy thereof, and it is submitted subject to errors, omissions, changes of price, rental or other conditions, prior sale, lease or financing, or withdrawal without notice.

# 901

SLAUSON AVE.  
LOS ANGELES | CA

# FOR LEASE

INDUSTRIAL PROPERTY

(Not to Scale)

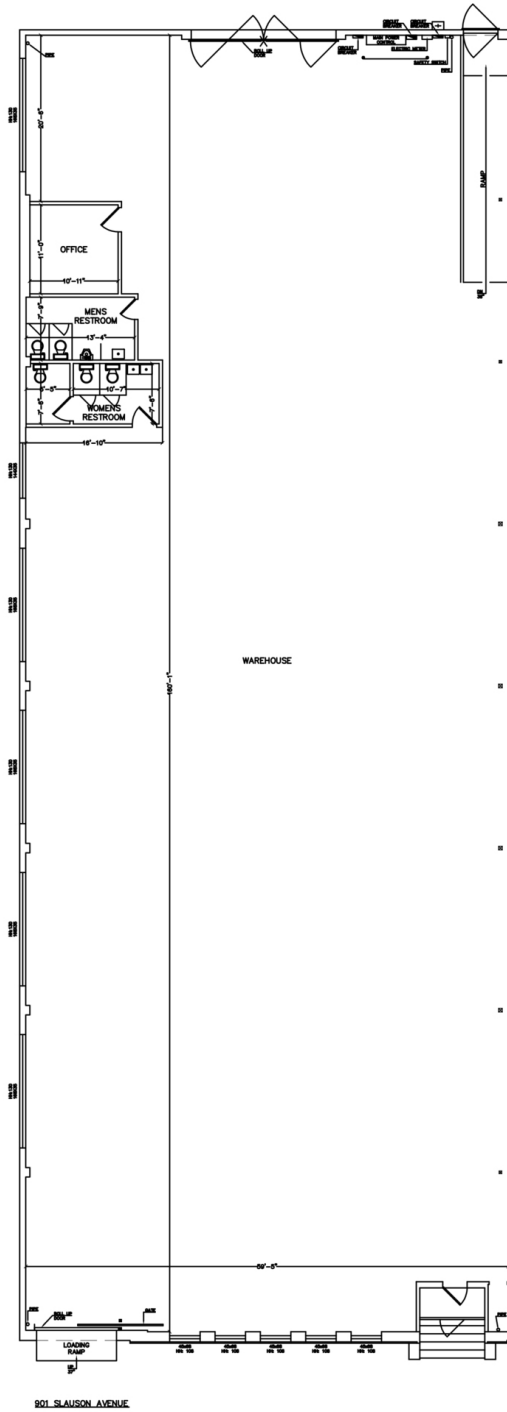

Although all information is furnished regarding for sale, rental or financing is from sources deemed reliable, such information has not been verified and no express representation is made nor is any to be implied as to the accuracy thereof, and it is submitted subject to errors, omissions, changes of price, rental or other conditions, prior sale, lease or financing, or withdrawal without notice.

**DAUM**  
COMMERCIAL REAL ESTATE SERVICES