



2522

S. MALT AVENUE
COMMERCE | CA



FOR LEASE INDUSTRIAL BUILDING



±16,172 SF
SQUARE FEET



±2,800
OFFICE SF



20 ft
CLEAR HEIGHT



3
DOCK HIGH DOORS

FOR MORE INFORMATION PLEASE CONTACT:

DAVID MUIR
EXECUTIVE VICE PRESIDENT

P: 213.270.2244
david.muir@daumcommercial.com
CABRE #01210653

MATTHEW BOGGS
VICE PRESIDENT

P: 213.270.2237
matthew.boggs@daumcommercial.com
CABRE #01937117

Although all information is furnished regarding for sale, rental or financing is from sources deemed reliable, such information has not been verified and no express representation is made nor is any to be implied as to the accuracy thereof, and it is submitted subject to errors, omissions, changes of price, rental or other conditions, prior sale, lease or financing, or withdrawal without notice.

DAUM
COMMERCIAL REAL ESTATE SERVICES

2522

S. MALT AVENUE
COMMERCE | CA

FOR LEASE

INDUSTRIAL BUILDING



PROPERTY HIGHLIGHTS

- Easy Access to 5 Freeway Off Telegraph
- Functional Dock High Building with large fenced yard
- Wide Street | Great Truck Access
- High Clear Building with Many Skylights
- Unfinished Mezzanine: 2,800 SF, is not included in Total SF

AVAILABLE SPACES

SUITE	SIZE (SF)	LEASE TYPE	LEASE RATE
2522 S Malt Avenue	16,172 SF	Gross	\$0.83 SF/month

Although all information is furnished regarding for sale, rental or financing is from sources deemed reliable, such information has not been verified and no express representation is made nor is any to be implied as to the accuracy thereof, and it is submitted subject to errors, omissions, changes of price, rental or other conditions, prior sale, lease or financing, or withdrawal without notice.

DAUM
COMMERCIAL REAL ESTATE SERVICES

2522

S. MALT AVENUE
COMMERCE | CA

FOR LEASE

INDUSTRIAL BUILDING



Although all information is furnished regarding for sale, rental or financing is from sources deemed reliable, such information has not been verified and no express representation is made nor is any to be implied as to the accuracy thereof, and it is submitted subject to errors, omissions, changes of price, rental or other conditions, prior sale, lease or financing, or withdrawal without notice.

 **DAUM**
COMMERCIAL REAL ESTATE SERVICES

2522

S. MALT AVENUE
COMMERCE | CA

FOR LEASE

INDUSTRIAL BUILDING

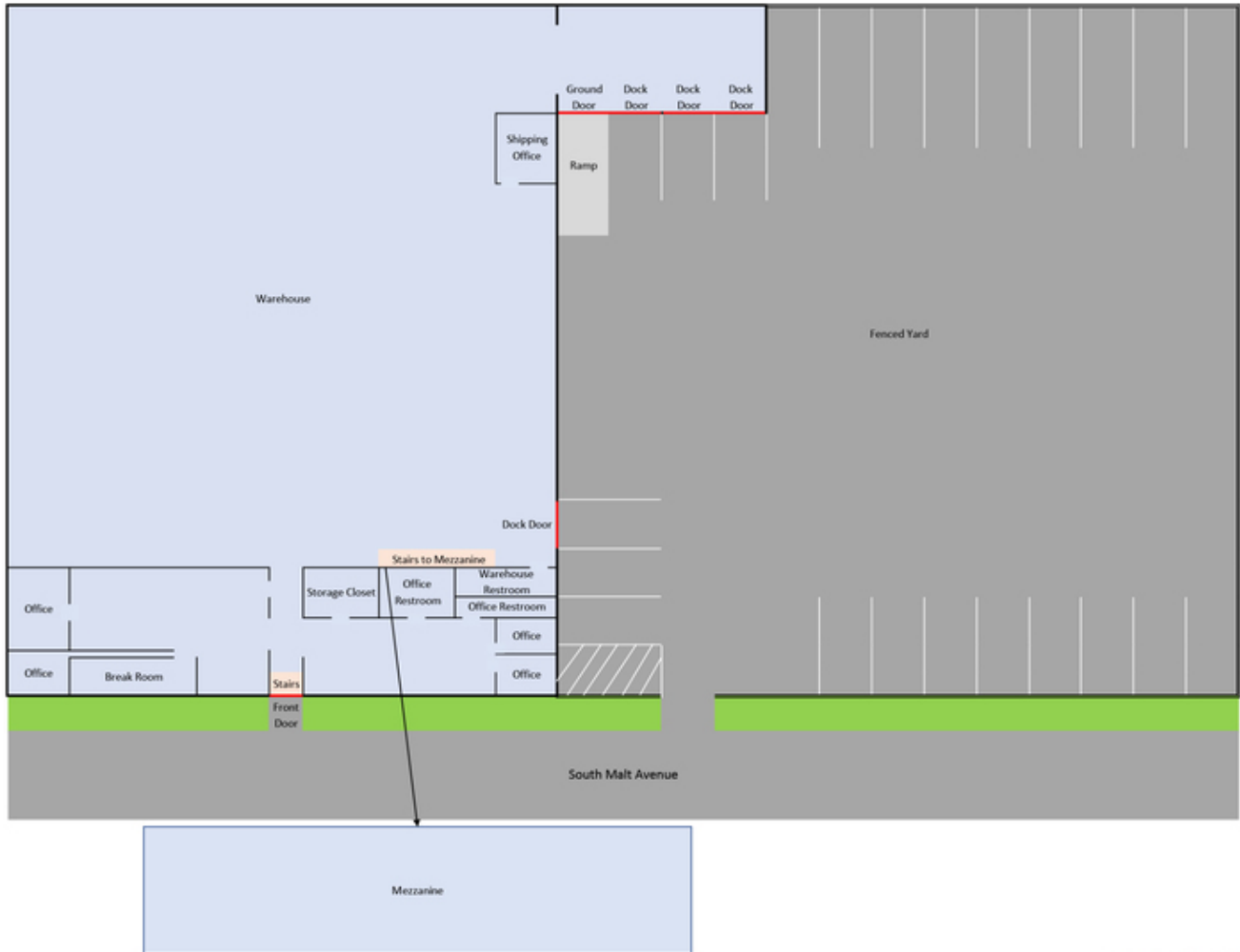

NOT TO SCALE*

DAVID MUIR
EXECUTIVE VICE PRESIDENT
P: 213.270.2244
david.muir@daumcommercial.com
CABRE #01210653

MATTHEW BOGGS
VICE PRESIDENT
P: 213.270.2237
matthew.boggs@daumcommercial.com
CABRE #01937117

Although all information is furnished regarding for sale, rental or financing is from sources deemed reliable, such information has not been verified and no express representation is made nor is any to be implied as to the accuracy thereof, and it is submitted subject to errors, omissions, changes of price, rental or other conditions, prior sale, lease or financing, or withdrawal without notice.

