



FOR SALE
±45,681 SF

11810 CENTER STREET
SOUTH GATE | CALIFORNIA

Features

- Redevelopment Opportunity
- Located in The Heart of The Hollydale Village Area of South Gate - **CLICK TO VIEW PLAN**
- Owner/User Potential - Check with city for allowable uses
- Two Parcels: (±56,889 Square Feet, Zoned CDR3 & ±8,621 Square Feet Zoned NL)

EXCLUSIVE LISTING AGENT:

MATTHEW BOGGS
VICE PRESIDENT
P: 213.270.2237
mboggs@daumcre.com
CADRE #01937117

Although all information is furnished regarding for sale, rental or financing is from sources deemed reliable, such information has not been verified and no express representation is made nor is any to be implied as to the accuracy thereof, and it is submitted subject to errors, omissions, changes of price, rental or other conditions, prior sale, lease or financing, or withdrawal without notice. All maps courtesy of Google Maps, Bing, and Google Earth. D/AQ Corp. #01129558

DAUM
COMMERCIAL REAL ESTATE SERVICES

11810 CENTER STREET

SOUTH GATE | CALIFORNIA

SITE PLAN

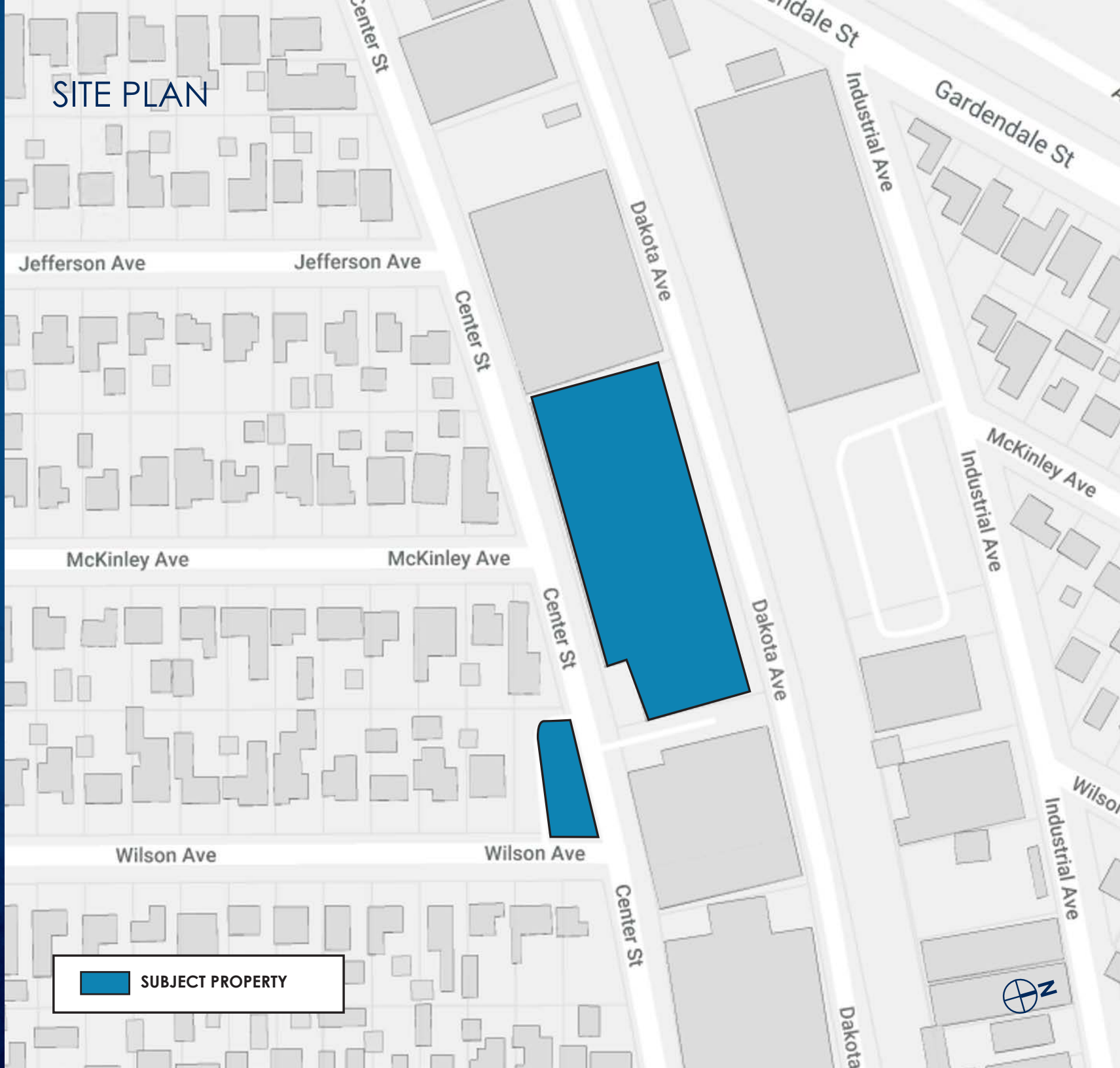

Although all information is furnished regarding for sale, rental or financing is from sources deemed reliable, such information has not been verified and no express representation is made nor is any to be implied as to the accuracy thereof, and it is submitted subject to errors, omissions, changes of price, rental or other conditions, prior sale, lease or financing, or withdrawal without notice. All maps courtesy of Google Maps, Bing, and Google Earth. D/AQ Corp. # 01129558

11810 CENTER STREET

SOUTH GATE | CALIFORNIA

Although all information is furnished regarding for sale, rental or financing is from sources deemed reliable, such information has not been verified and no express representation is made nor is any to be implied as to the accuracy thereof, and it is submitted subject to errors, omissions, changes of price, rental or other conditions, prior sale, lease or financing, or withdrawal without notice. All maps courtesy of Google Maps, Bing, and Google Earth. D/AQ Corp. # 01129558

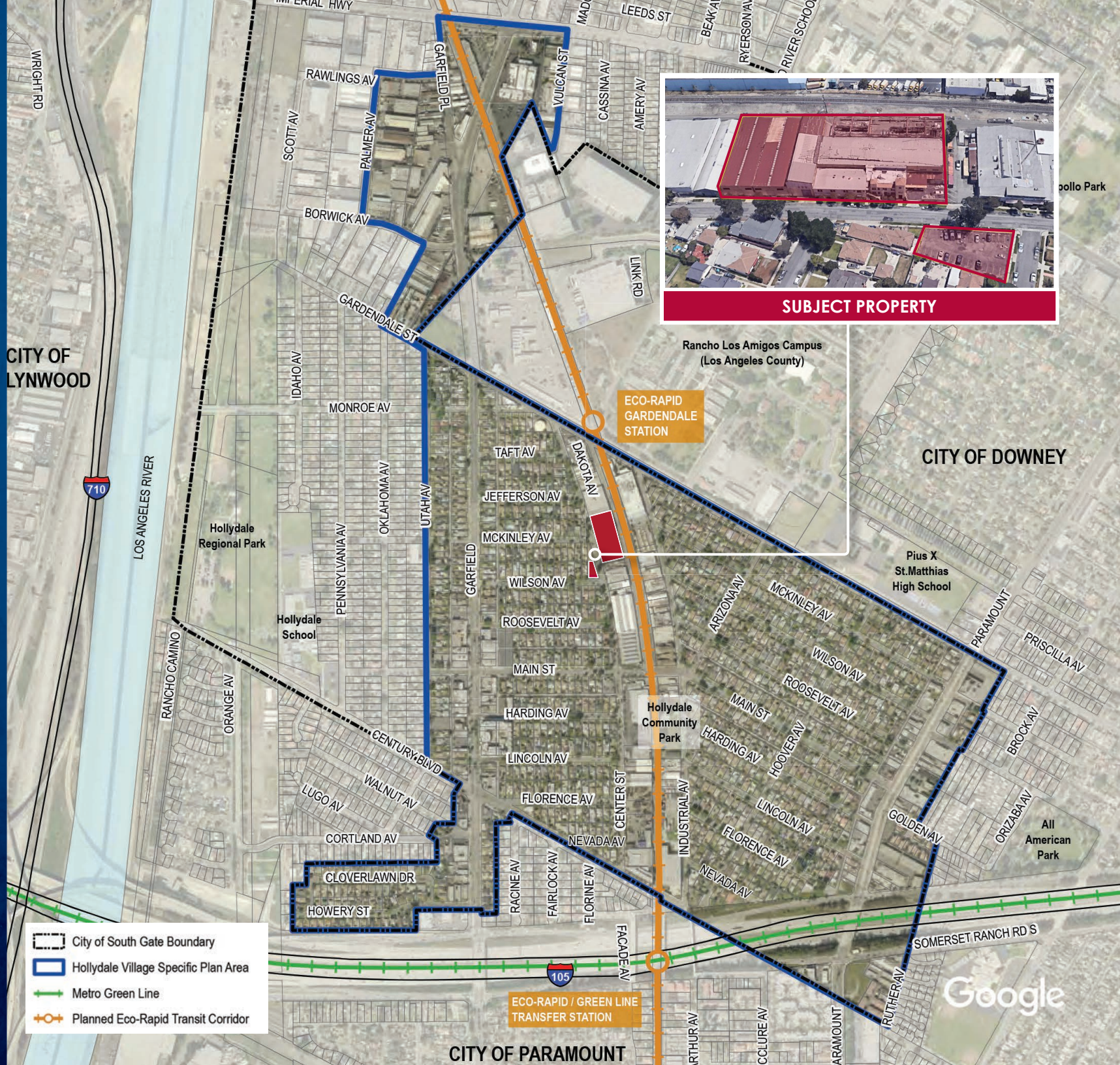

SUBJECT PROPERTY

Rancho Los Amigos Campus
(Los Angeles County)

ECO-RAPID
GARDENDALE
STATION

CITY OF DOWNEY

Pius X
St. Matthias
High School

Hollydale
Community
Park

All
American
Park

ECO-RAPID / GREEN LINE
TRANSFER STATION

CITY OF PARAMOUNT

11810 CENTER STREET

SOUTH GATE | CALIFORNIA

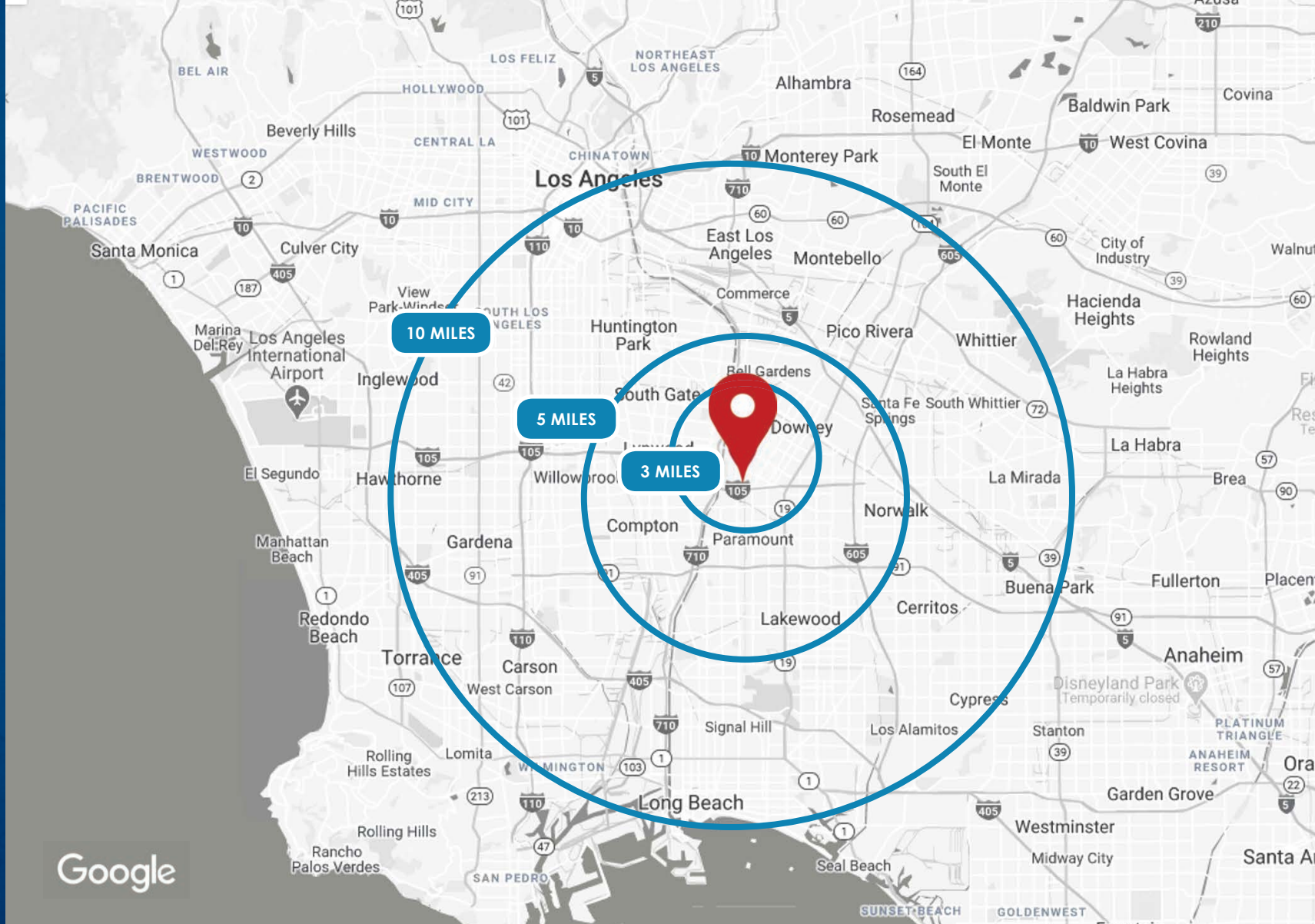

Google

Although all information is furnished regarding for sale, rental or financing is from sources deemed reliable, such information has not been verified and no express representation is made nor is any to be implied as to the accuracy thereof, and it is submitted subject to errors, omissions, changes of price, rental or other conditions, prior sale, lease or financing, or withdrawal without notice. All maps courtesy of Google Maps, Bing, and Google Earth. D/AQ Corp. # 01129558

DEMOGRPAHICS	3 Miles	5 Miles	10 Miles
2020 Total Population:	322,953	908,601	2,964,518
2025 Population:	322,282	904,528	2,952,939
Median Household Inc:	\$58,283	\$57,034	\$58,171
Total Consumer Spending 2020:	\$2,234,055	\$6,292,140	\$22,194,561