



±5,194 SF HIGH-IMAGE INDUSTRIAL SHOWROOM
FOR LEASE 11240-11230 TALBERT AVE.
FOUNTAIN VALLEY | CA

CONTACT EXCLUSIVE LISTING AGENTS:

MIKE BARREIRO
EXECUTIVE V.P. | PRINCIPAL
P: 949.355.8500
E: mbarreiro@daumcre.com
CA DRE License #01712620

DEVIN RAY
ASSOCIATE
P: 949.242.1065
E: dray@daumcre.com
CA DRE License #02018130



2
GROUND LEVEL



18'
CLEARANCE



HIGH TRAFFIC
COUNT



SPRINKLERED



D/AQ Corp. #01129558, Maps Courtesy ©Google & ©Microsoft. Although all information is furnished regarding for sale, rental or financing is from sources deemed reliable, such information has not been verified and no express representation is made nor is any to be implied as to the accuracy thereof, and it is submitted subject to errors, omissions, changes of price, rental or other conditions, prior sale, lease or financing, or withdrawal without notice.

PRIME SOUTH COAST METRO LOCATION

5,194 SF
RETAIL
SHOWROOM



MOUNT WASHINGTON STREET

TALBERT AVENUE



PROPERTY HIGHLIGHTS

- Part of a Larger 31,000 SF Building
- Two (2) GL Doors (12'x14')
- Two (2) Storefront Entrances
- Two (2) Restrooms
- Fully Sprinklered
- 225 Amps (277/480V) Verify
- 18' Clearance
- 2:1 Parking
- Fountain Valley Crossings Specific Plan- Workplace Neighborhood Zoning
- Highly Visible Corner Location, Talbert Avenue across from Costco
- Excellent access to 405, 55 & 73 Freeways

FOR LEASE
11240-11230 TALBERT AVE.
FOUNTAIN VALLEY, CA



ABOUT
THE
PROPERTY

D/AQ Corp. #01129558. Maps Courtesy ©Google & ©Microsoft. Although all information is furnished regarding for sale, rental or financing is from sources deemed reliable, such information has not been verified and no express representation is made nor is any to be implied as to the accuracy thereof, and it is submitted subject to errors, omissions, changes of price, rental or other conditions, prior sale, lease or financing, or withdrawal without notice.

5,194 SF
RETAIL
SHOWROOM

11240-11230 TALBERT AVE.
FOUNTAIN VALLEY, CA

FOR LEASE



CONTACT EXCLUSIVE LISTING AGENTS:

MIKE BARREIRO

EXECUTIVE VICE PRESIDENT | PRINCIPAL

P: 949.355.8500 | E: mbarreiro@daumcre.com

CA DRE License #01712620

DEVIN RAY

ASSOCIATE

P: 949.242.1065 | E: dray@daumcre.com

CA DRE License #02018130

DAUM
COMMERCIAL REAL ESTATE SERVICES

D/AQ Corp. #01129558. Maps Courtesy @Google & @Microsoft. Although all information is furnished regarding for sale, rental or financing is from sources deemed reliable, such information has not been verified and no express representation is made nor is any to be implied as to the accuracy thereof, and it is submitted subject to errors, omissions, changes of price, rental or other conditions, prior sale, lease or financing, or withdrawal without notice.

5,194 SF
RETAIL
SHOWROOM

11240-11230 TALBERT AVE.
FOUNTAIN VALLEY, CA

FOR LEASE



CONTACT EXCLUSIVE LISTING AGENTS:

MIKE BARREIRO

EXECUTIVE VICE PRESIDENT | PRINCIPAL

P: 949.355.8500 | E: mbarreiro@daumcre.com

CA DRE License #01712620

DEVIN RAY

ASSOCIATE

P: 949.242.1065 | E: dray@daumcre.com

CA DRE License #02018130

DAUM
COMMERCIAL REAL ESTATE SERVICES

D/AQ Corp. #01129558. Maps Courtesy @Google & @Microsoft. Although all information is furnished regarding for sale, rental or financing is from sources deemed reliable, such information has not been verified and no express representation is made nor is any to be implied as to the accuracy thereof, and it is submitted subject to errors, omissions, changes of price, rental or other conditions, prior sale, lease or financing, or withdrawal without notice.

5,194 SF
RETAIL
SHOWROOM

11240-11230 TALBERT AVE.
FOUNTAIN VALLEY, CA

FOR LEASE

FLOOR
PLAN

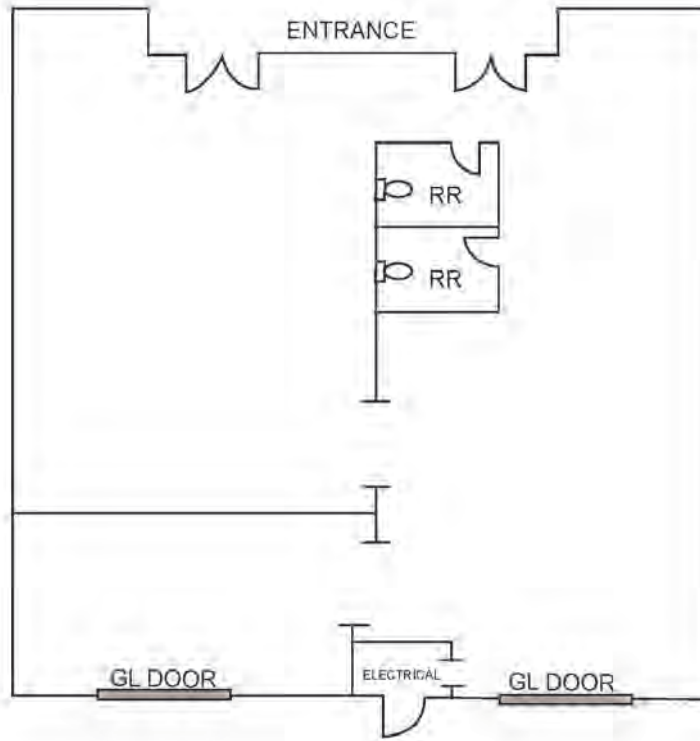

D/AQ Corp. #01129558. Maps Courtesy ©Google & ©Microsoft. Although all information is furnished regarding for sale, rental or financing is from sources deemed reliable, such information has not been verified and no express representation is made nor is any to be implied as to the accuracy thereof, and it is submitted subject to errors, omissions, changes of price, rental or other conditions, prior sale, lease or financing, or withdrawal without notice.

5,194 SF
RETAIL
SHOWROOM

FOUNTAIN VALLEY CROSSINGS SPECIFIC PLAN WORKPLACE NEIGHBORHOOD ZONING

FOR LEASE
11240-11230 TALBERT AVE.
FOUNTAIN VALLEY, CA

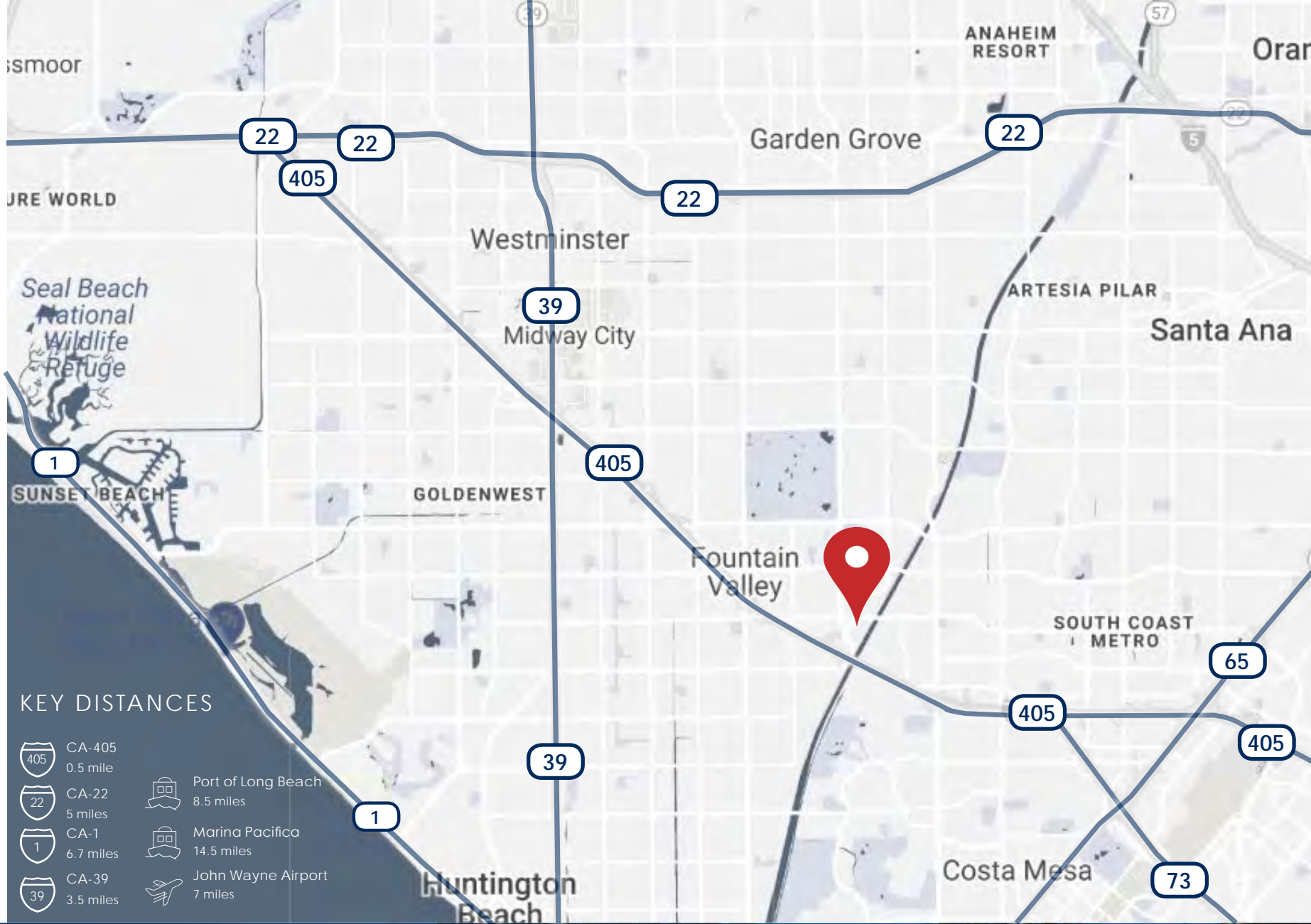

FIG.2.1 DISTRICTS MAP

5,194 SF
RETAIL
SHOWROOM

11240-11230 TALBERT AVE.
FOUNTAIN VALLEY, CA

FOR LEASE



KEY DISTANCES

- | | | | |
|--|--------------------|--|---------------------------------|
| | CA-405
0.5 mile | | Port of Long Beach
8.5 miles |
| | CA-22
5 miles | | Marina Pacifica
14.5 miles |
| | CA-1
6.7 miles | | John Wayne Airport
7 miles |
| | CA-39
3.5 miles | | |

CONTACT EXCLUSIVE LISTING AGENTS:

MIKE BARREIRO

EXECUTIVE VICE PRESIDENT | PRINCIPAL

P: 949.355.8500 | E: mbarreiro@daumcre.com

CA DRE License #01712620

DEVIN RAY

ASSOCIATE

P: 949.242.1065 | E: dray@daumcre.com

CA DRE License #02018130

