

NOW READY FOR OCCUPANCY

FOR LEASE 60,000 SF

PLEASANT VALLEY RD. | CAMARILLO | CA

2385

REFURBISHMENT COMPLETE



MITCHELL CONLEE

Executive Vice President
P: 805.384.8815 | M: 805.443.3346
mconlee@daumcommercial.com
CA License # 00912213

DAVID FREITAG

Executive Vice President
P: 213.270.2235 | M: 310.413.9390
dfreitag@daumcommercial.com
CA License #00855673



FOR LEASE 60,000 SF

PLEASANT VALLEY RD. | CAMARILLO | CA



PROPERTY HIGHLIGHTS

- Now Ready for Occupancy
- Refurbishment Complete
- Corporate Manufacturing R.D. Warehouse Facility
- 60,000 SF Available
- 15,000 SF of Above-Standard Office Space
- 132,858 SF Land
- Extensive Electrical Distribution
- Nicely Improved Glass Lined Offices
- Excellent Location with Corporate Identity
- Close Proximity to 101 Freeway

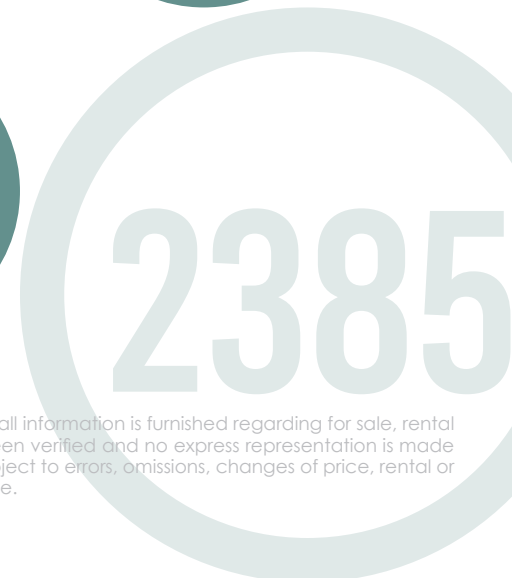
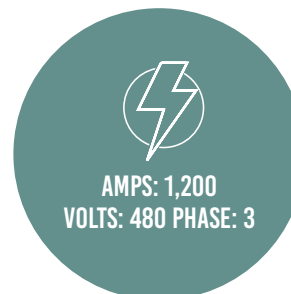

D/AQ Corp. #01129558. Maps Courtesy @Google & @Microsoft. Although all information is furnished regarding for sale, rental or financing is from sources deemed reliable, such information has not been verified and no express representation is made nor is any to be implied as to the accuracy thereof, and it is submitted subject to errors, omissions, changes of price, rental or other conditions, prior sale, lease or financing, or withdrawal without notice.

SITE PLAN

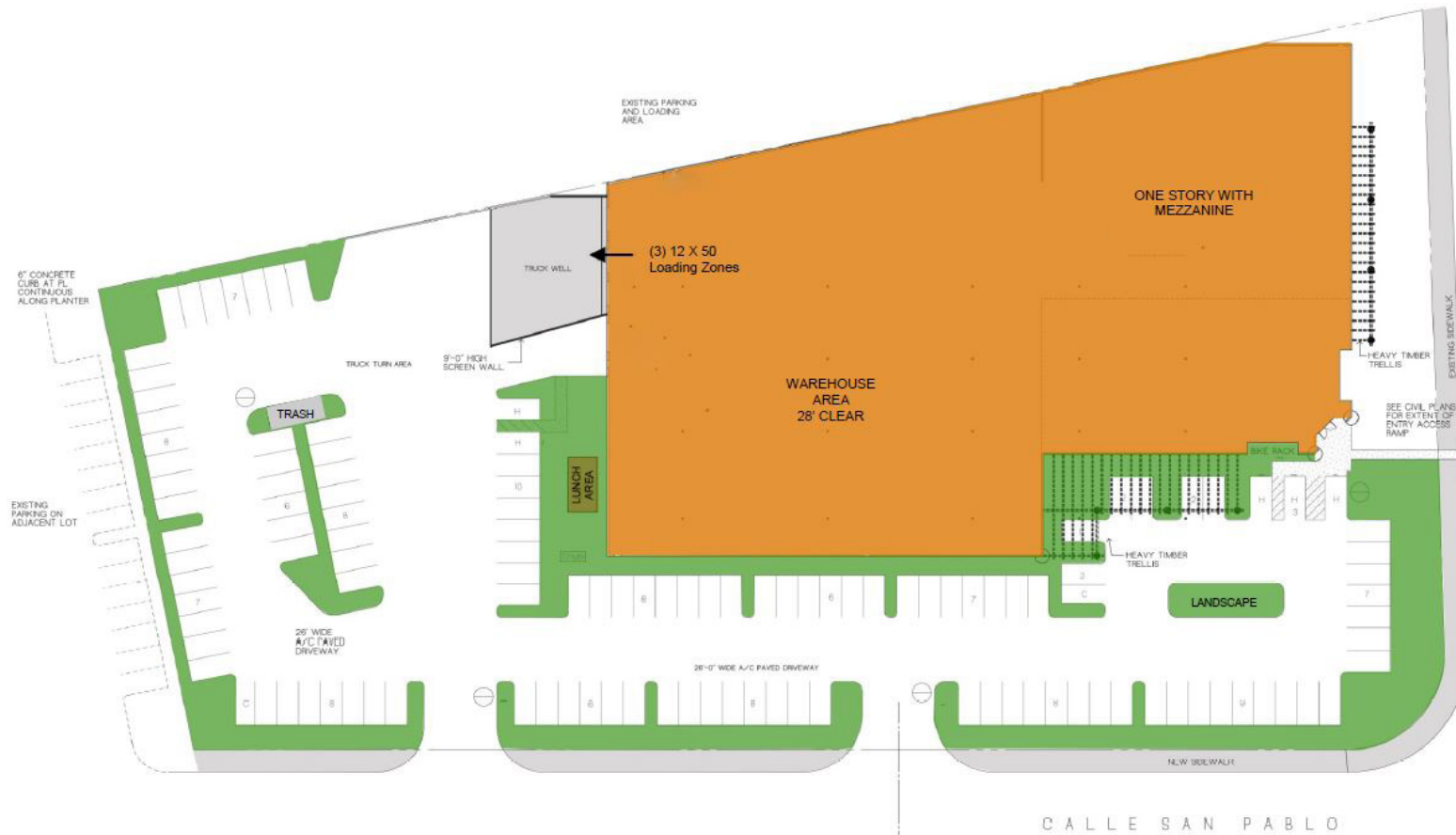

2385

FOR LEASE 60,000 SF
PLEASANT VALLEY RD. | CAMARILLO | CA

DAUM
COMMERCIAL REAL ESTATE SERVICES

EXTERIOR PHOTOS



2385

FOR LEASE 60,000 SF
PLEASANT VALLEY RD. | CAMARILLO | CA

DAUM
COMMERCIAL REAL ESTATE SERVICES

INTERIOR PHOTOS

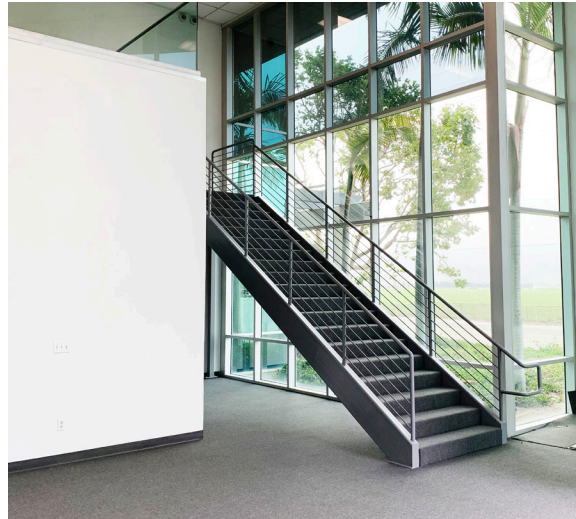

2385

FOR LEASE 60,000 SF
PLEASANT VALLEY RD. | CAMARILLO | CA

DAUM
COMMERCIAL REAL ESTATE SERVICES

AERIAL & LOCATION MAP

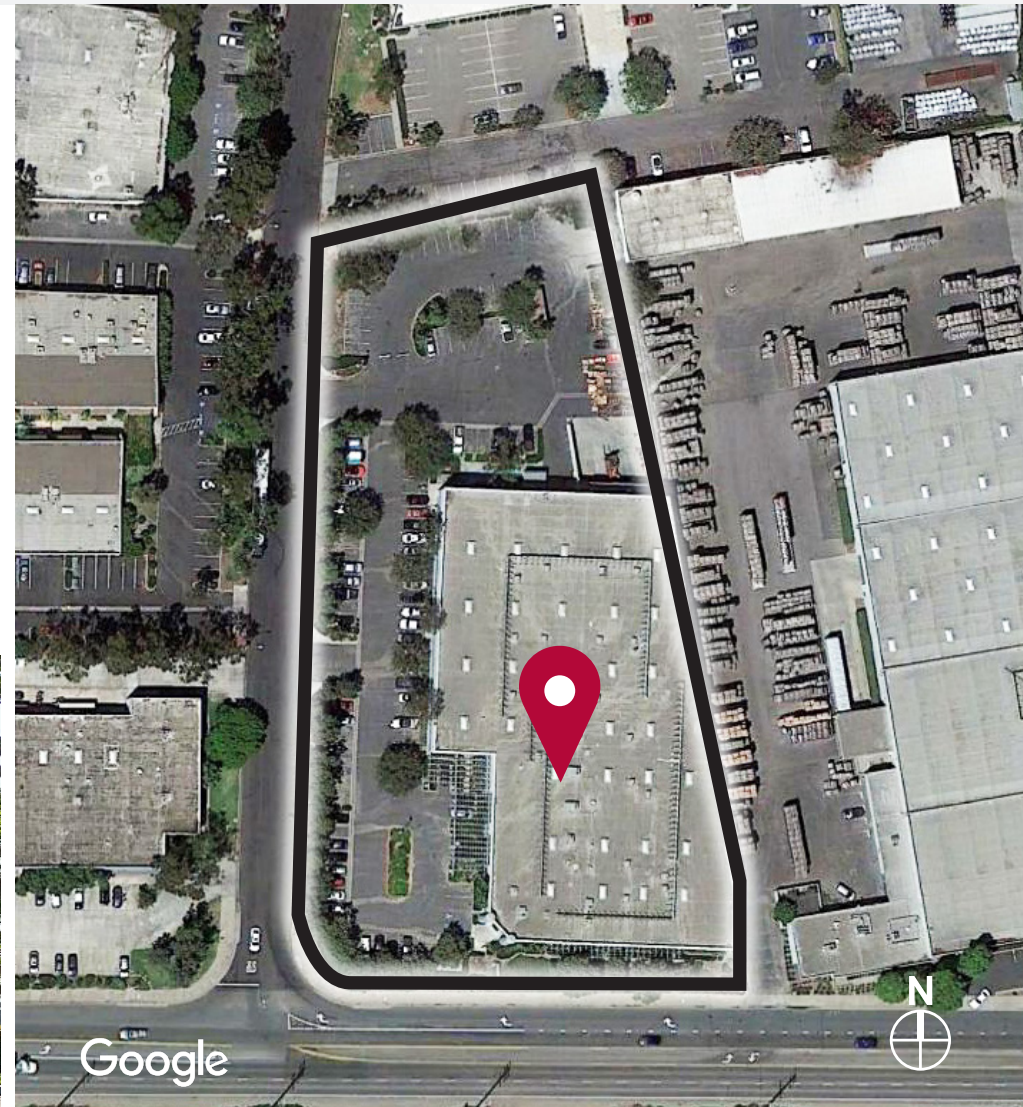
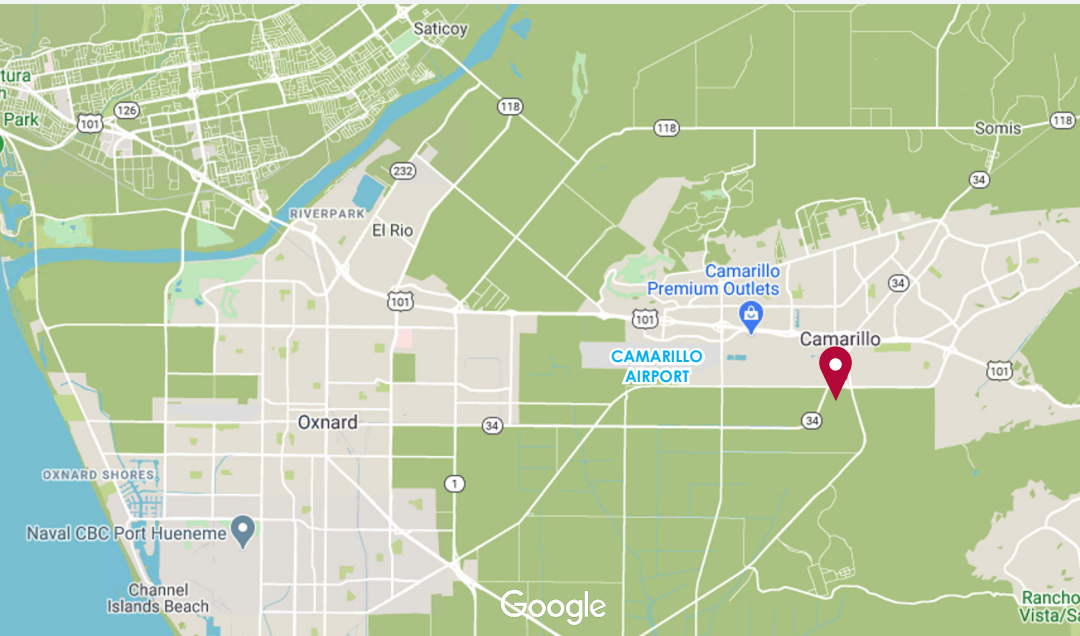

2385

FOR LEASE 60,000 SF
PLEASANT VALLEY RD. | CAMARILLO | CA

DAUM
COMMERCIAL REAL ESTATE SERVICES