



3311

E. MCDOWELL RD.
PHOENIX | AZ

FOR SALE OR LEASE

RETAIL PROPERTY

FOR MORE INFORMATION PLEASE CONTACT:

DAVID WILSON, CCIM

P: 602.575.2306 | M: 602.284.2999

david.wilson@daumcommercial.com

CARTER WILSON, CCIM

P: 602.575.2328 | M: 480.225.1992

carter.wilson@daumcommercial.com

Although all information is furnished regarding for sale, rental or financing is from sources deemed reliable, such information has not been verified and no express representation is made nor is any to be implied as to the accuracy thereof, and it is submitted subject to errors, omissions, changes of price, rental or other conditions, prior sale, lease or financing, or withdrawal without notice.

FOR SALE OR LEASE

RETAIL PROPERTY

3311

E. MCDOWELL RD.
PHOENIX | AZ



PROPERTY HIGHLIGHTS

- ± 16,038 SF Retail / Open Warehouse Space
- ± 39,714 SF Lot / ± 0.912 Acres
- Great Visibility on McDowell Road
- Large Monument Sign
- Truck Well and Dock Loading
- Front and Back Entrances
- 100 % A/C
- Zoned C-2 (Commercial), City of Phoenix
- 1 Mile north of Loop 202
- Parcel No. 121-07-138A
- SRP Power
- Currently Occupied - Contact Brokers for Tour



DAVID WILSON, CCIM

P: 602.575.2306 | M: 602.284.2999
david.wilson@daumcommercial.com

CARTER WILSON, CCIM

P: 602.575.2328 | M: 480.225.1992
carter.wilson@daumcommercial.com

FOR LEASE

RETAIL PROPERTY

3311

E. MCDOWELL RD.
PHOENIX | AZ

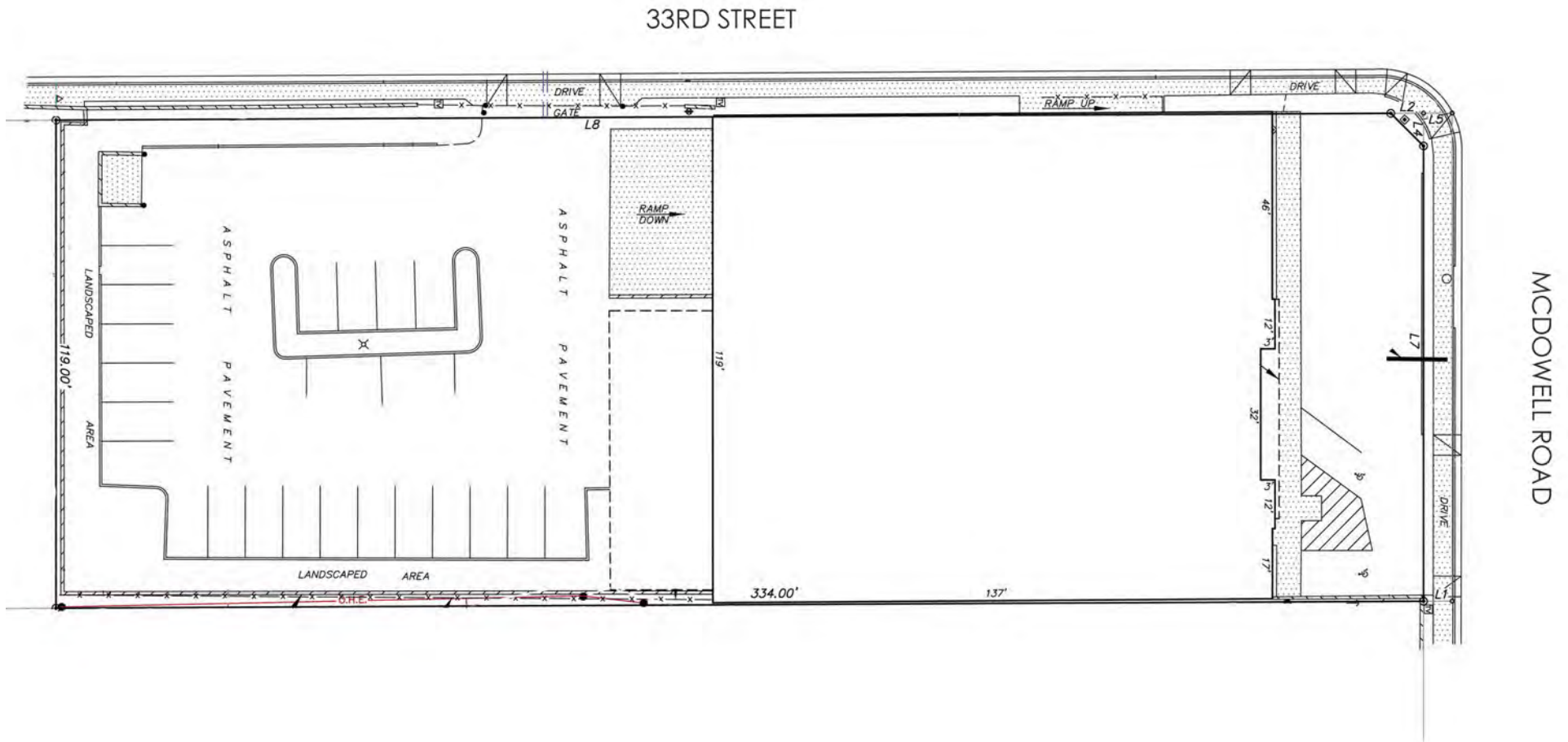

DAVID WILSON, CCIM

P: 602.575.2306 | M: 602.284.2999
david.wilson@daumcommercial.com

CARTER WILSON, CCIM

P: 602.575.2328 | M: 480.225.1992
carter.wilson@daumcommercial.com

FOR SALE OR LEASE

RETAIL PROPERTY

3311

E. MCDOWELL RD.
PHOENIX | AZ



DAVID WILSON, CCIM

P: 602.575.2306 | M: 602.284.2999
david.wilson@daumcommercial.com

CARTER WILSON, CCIM

P: 602.575.2328 | M: 480.225.1992
carter.wilson@daumcommercial.com