

USER / INVESTMENT



FOR SALE
± 16,885 SF

3412 DE FOREST CIRCLE, UNITS A & B
Jurupa Valley, CA 91752

EXCLUSIVE LISTING TEAM:

Noah Samarin
Executive Vice President | Principal
P: 909.912.0007 | M: 714.812.1289
noah.samarin@daumcommercial.com
CADRE #01755814

Paul Gingrich
Executive Vice President
P: 714.941.5333 | M: 949.357.7467
paul.gingrich@daumcommercial.com
CADRE #01299770

Although all information is furnished regarding for sale, rental or financing is from sources deemed reliable, such information has not been verified and no express representation is made nor is any to be implied as to the accuracy thereof, and it is submitted subject to errors, omissions, changes of price, rental or other conditions, prior sale, lease or financing, or withdrawal without notice.





PROPERTY INFO

3412 DE FOREST CIRCLE, UNITS A & B

Freestanding Industrial Warehouse
w/2 Gated Yards & 2 Grade Level
Warehouse Doors

Property Description

+/-16,885 SF Freestanding industrial warehouse. +/-8,742/SF (Unit B is Leased/occupied to 3-31-2025) +/-8,143/SF (Unit A vacant)

Features

- +/-16,885/SF Building (Unit B: 8,742/SF (leased/occupied to 3/31/2025)
- 18' Clear Height
- 2 Fenced & Gated Yards
- Unit A: 8,143/SF (Unit A is vacant)
- 400 Amps 277/480v Power 3 phase, 4 wire (verify)
- 1,000 SF Office Space
- 2 Grade Level Warehouse Roll-up Doors



16,885 SF
2 UNITS 8,143 SF & 8,742 SF



1,000
OFFICE SF



18 ft
CLEAR HEIGHT



In - Common
PARKING

EXCLUSIVE LISTING TEAM:

Noah Samarin
Executive Vice President | Principal
P: 909.912.0007 | M: 714.812.1289
noah.samarin@daumcommercial.com
CADRE #01755814

Paul Gingrich
Executive Vice President
P: 714.941.5333 | M: 949.357.7467
paul.gingrich@daumcommercial.com
CADRE #01299770

Although all information is furnished regarding for sale, rental or financing is from sources deemed reliable, such information has not been verified and no express representation is made nor is any to be implied as to the accuracy thereof, and it is submitted subject to errors, omissions, changes of price, rental or other conditions, prior sale, lease or financing, or withdrawal without notice.



3412 DE FOREST CIRCLE, UNIT A & B

Freestanding Industrial Warehouse w/2 Gated Yards &
2 Grade Level Warehouse Doors

Although all information is furnished regarding for sale, rental or financing is from sources deemed reliable, such information has not been verified and no express representation is made nor is any to be implied as to the accuracy thereof, and it is submitted subject to errors, omissions, changes of price, rental or other conditions, prior sale, lease or financing, or withdrawal without notice.

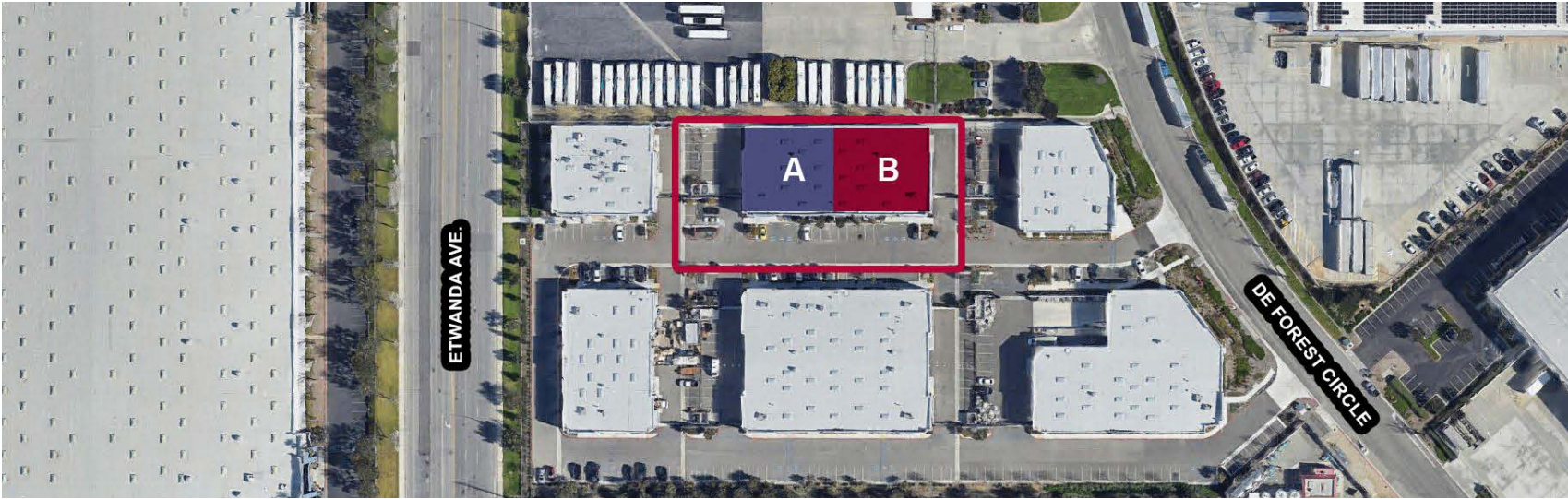

3412 DE FOREST CIRCLE, UNITS A & B

Freestanding Industrial Warehouse w/2 Gated Yards &
2 Grade Level Warehouse Doors

SITE PLAN



Although all information is furnished regarding for sale, rental or financing is from sources deemed reliable, such information has not been verified and no express representation is made nor is any to be implied as to the accuracy thereof, and it is submitted subject to errors, omissions, changes of price, rental or other conditions, prior sale, lease or financing, or withdrawal without notice.

EXCLUSIVE LISTING TEAM:

Noah Samarin
Executive Vice President | Principal
P: 909.912.0007 | M: 714.812.1289
noah.samarin@daumcommercial.com
CADRE #01755814

Paul Gingrich
Executive Vice President
P: 714.941.5333 | M: 949.357.7467
paul.gingrich@daumcommercial.com
CADRE #01299770

3412 DE FOREST CIRCLE, UNITS A & B

Freestanding Industrial Warehouse w/2 Gated Yards &
2 Grade Level Warehouse Doors

FLOOR PLAN

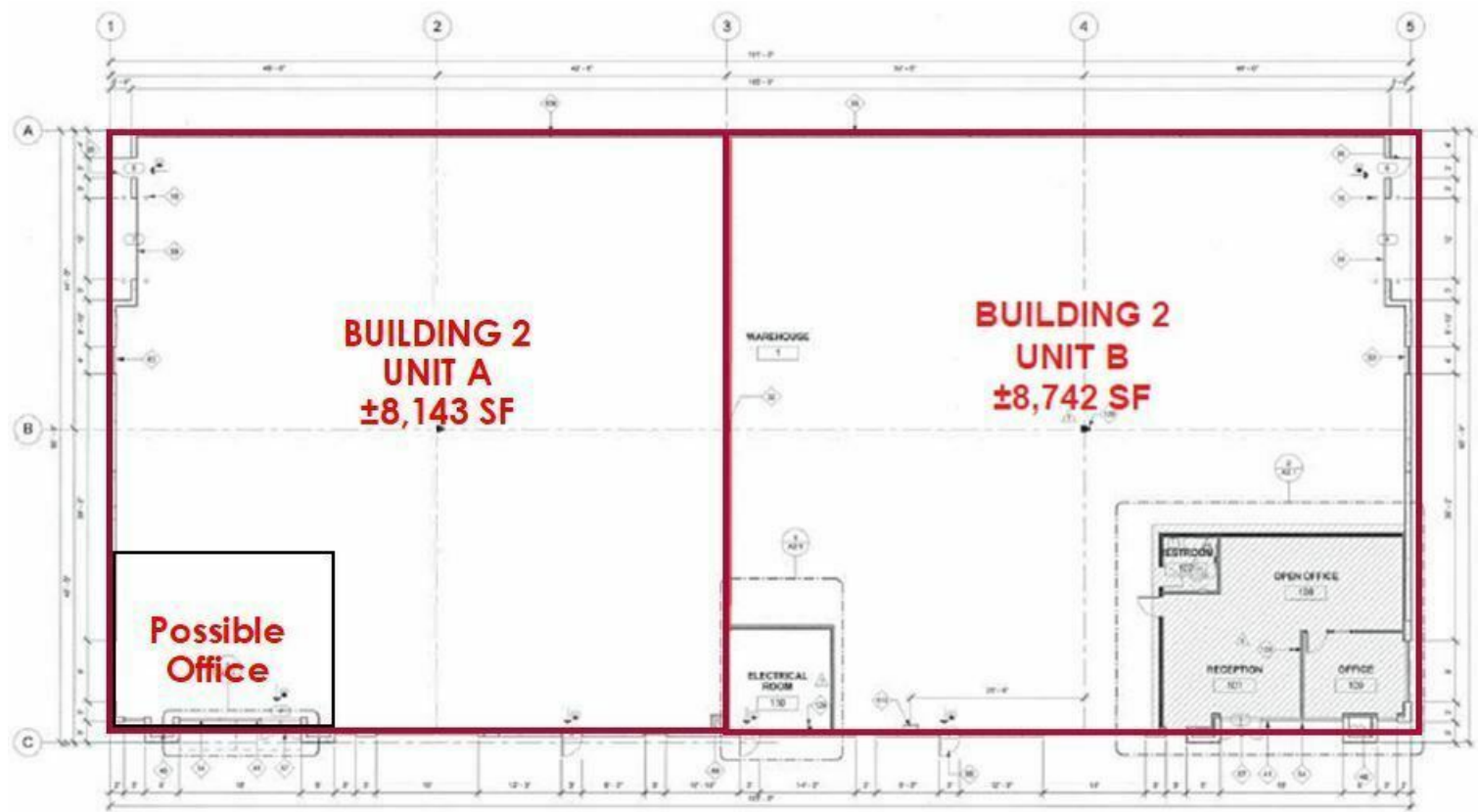

EXCLUSIVE LISTING TEAM:

Noah Samarin
Executive Vice President | Principal
P: 909.912.0007 | M: 714.812.1289
noah.samarin@daumcommercial.com
CADRE #01755814

Paul Gingrich
Executive Vice President
P: 714.941.5333 | M: 949.357.7467
paul.gingrich@daumcommercial.com
CADRE #01299770

Although all information is furnished regarding for sale, rental or financing is from sources deemed reliable, such information has not been verified and no express representation is made nor is any to be implied as to the accuracy thereof, and it is submitted subject to errors, omissions, changes of price, rental or other conditions, prior sale, lease or financing, or withdrawal without notice.

3412 DE FOREST CIRCLE, UNIT A & B

Freestanding Industrial Warehouse w/2 Gated Yards &
2 Grade Level Warehouse Doors

Although all information is furnished regarding for sale, rental or financing is from sources deemed reliable, such information has not been verified and no express representation is made nor is any to be implied as to the accuracy thereof, and it is submitted subject to errors, omissions, changes of price, rental or other conditions, prior sale, lease or financing, or withdrawal without notice.

