

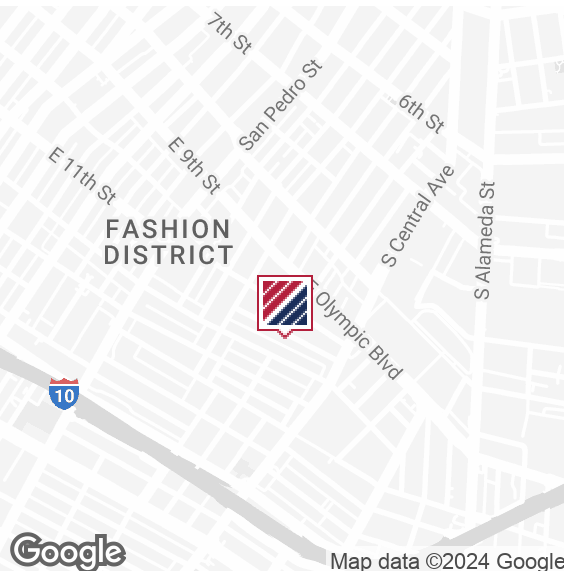



# 1100

E 11TH STREET  
LOS ANGELES | CA



## FOR LEASE

INDUSTRIAL PROPERTY



3,590 SF  
AVAILABLE



300 SF  
OFFICE SPACE



14 ft  
CLEAR HEIGHT



1  
GL LOADING DOOR

### PROPERTY HIGHLIGHTS

- Lease Rate/Mo: \$7,000.00 Gross
- Lease Rate/SF: \$1.95 Gross
- Rear Gated Parking/Loading
- Power: A: 200 V; 240 O; 3 W; 4
- Distributed Power
- LA M2 Zoning
- Clear Span Warehouse
- Electronic Row

FOR MORE INFORMATION PLEASE CONTACT:

**BRYAN ABAYAN**  
ASSOCIATE VICE PRESIDENT  
P: 310.883.8476  
babayan@daumcre.com  
CADRE #02005294

**JERRY SACKLER**  
EXECUTIVE VICE PRESIDENT  
P: 213.270.2267 | M: 310.721.5000  
jsackler@daumcre.com  
CADRE #01098039

Although all information is furnished regarding for sale, rental or financing is from sources deemed reliable, such information has not been verified and no express representation is made nor is any to be implied as to the accuracy thereof, and it is submitted subject to errors, omissions, changes of price, rental or other conditions, prior sale, lease or financing, or withdrawal without notice.



1100 E 11TH STREET  
LOS ANGELES | CA

**FOR LEASE**  
INDUSTRIAL PROPERTY

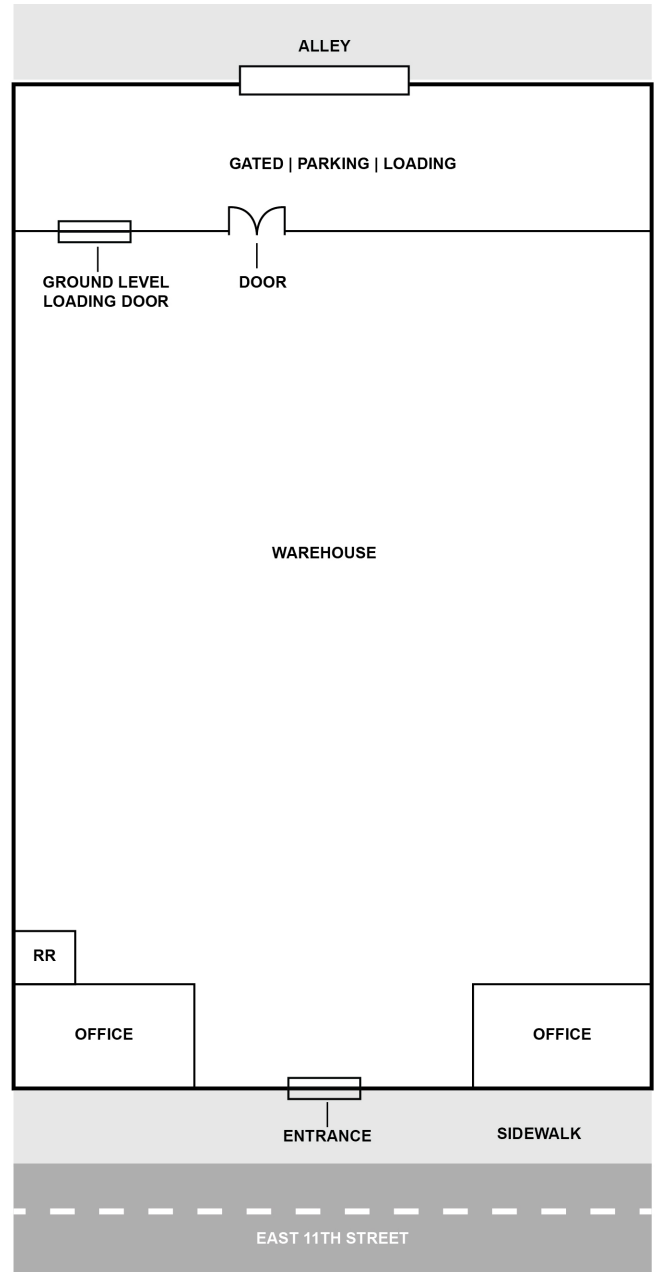

\*NOT TO SCALE

Although all information is furnished regarding for sale, rental or financing is from sources deemed reliable, such information has not been verified and no express representation is made nor is any to be implied as to the accuracy thereof, and it is submitted subject to errors, omissions, changes of price, rental or other conditions, prior sale, lease or financing, or withdrawal without notice.



1100 E 11TH STREET  
LOS ANGELES | CA

**FOR LEASE**  
INDUSTRIAL PROPERTY



Although all information is furnished regarding for sale, rental or financing is from sources deemed reliable, such information has not been verified and no express representation is made nor is any to be implied as to the accuracy thereof, and it is submitted subject to errors, omissions, changes of price, rental or other conditions, prior sale, lease or financing, or withdrawal without notice.

**DAUM**  
COMMERCIAL REAL ESTATE SERVICES

1100 E 11TH STREET  
LOS ANGELES | CA

**FOR LEASE**  
INDUSTRIAL PROPERTY



Although all information is furnished regarding for sale, rental or financing is from sources deemed reliable, such information has not been verified and no express representation is made nor is any to be implied as to the accuracy thereof, and it is submitted subject to errors, omissions, changes of price, rental or other conditions, prior sale, lease or financing, or withdrawal without notice.

**DAUM**  
COMMERCIAL REAL ESTATE SERVICES