



**FOR LEASE**  
±9,400 SF

**21850 VAN BUREN BLVD, BLDG. 10**  
Riverside, CA 92518

**EXCLUSIVE LISTING TEAM:**

Joseph Paredes  
Executive Vice President | Principal  
P: 909.652.9054 | M: 949.566.5186  
joe.paredes@daumcre.com  
CADRE #01895260

Noah Samarin  
Executive Vice President | Principal  
P: 909.912.0007  
noah.samarin@daumcre.com  
CADRE #01755814

Christina Gurdzhyan  
Vice President  
P: 909.912.0010  
christina.gurdzhyan@daumcre.com  
CADRE #02071335

Although all information is furnished regarding for sale, rental or financing is from sources deemed reliable, such information has not been verified and no express representation is made nor is any to be implied as to the accuracy thereof, and it is submitted subject to errors, omissions, changes of price, rental or other conditions, prior sale, lease or financing, or withdrawal without notice.



# PROPERTY INFO 21850 VAN BUREN BLVD, BLDG. 10

Industrial Showroom Property | ± 9,400 SF

## PROPERTY DESCRIPTION

Approximately 9,400 Sf of Industrial Showroom, Part of the Greater MS Van Buren II Business Park

## FEATURES

- 9,400 SF Available
- 37 Auto Parking Spaces
- Visibility from Signalized Intersection
- Office: 1,244 SF (estimated)
- 1 Ground Level Door (10'x14')
- Sprinklers: 20 GPM/1500
- 400 Amps Available (verify)
- 12' Clear Height (verify)

## EXCLUSIVE LISTING TEAM:

Joseph Paredes  
Executive Vice President | Principal  
P: 909.652.9054 | M: 949.566.5186  
joe.paredes@daumcre.com  
CADRE #01895260

Noah Samarin  
Executive Vice President | Principal  
P: 909.912.0007  
noah.samarin@daumcre.com  
CADRE #01755814

Christina Gurdzhyan  
Vice President  
P: 909.912.0010  
christina.gurdzhyan@daumcre.com  
CADRE #02071335

Although all information is furnished regarding for sale, rental or financing is from sources deemed reliable, such information has not been verified and no express representation is made nor is any to be implied as to the accuracy thereof, and it is submitted subject to errors, omissions, changes of price, rental or other conditions, prior sale, lease or financing, or withdrawal without notice.





# 21850 VAN BUREN BLVD, BLDG. 10

Industrial Showroom Property | ± 9,400 SF

Although all information is furnished regarding for sale, rental or financing is from sources deemed reliable, such information has not been verified and no express representation is made nor is any to be implied as to the accuracy thereof, and it is submitted subject to errors, omissions, changes of price, rental or other conditions, prior sale, lease or financing, or withdrawal without notice.

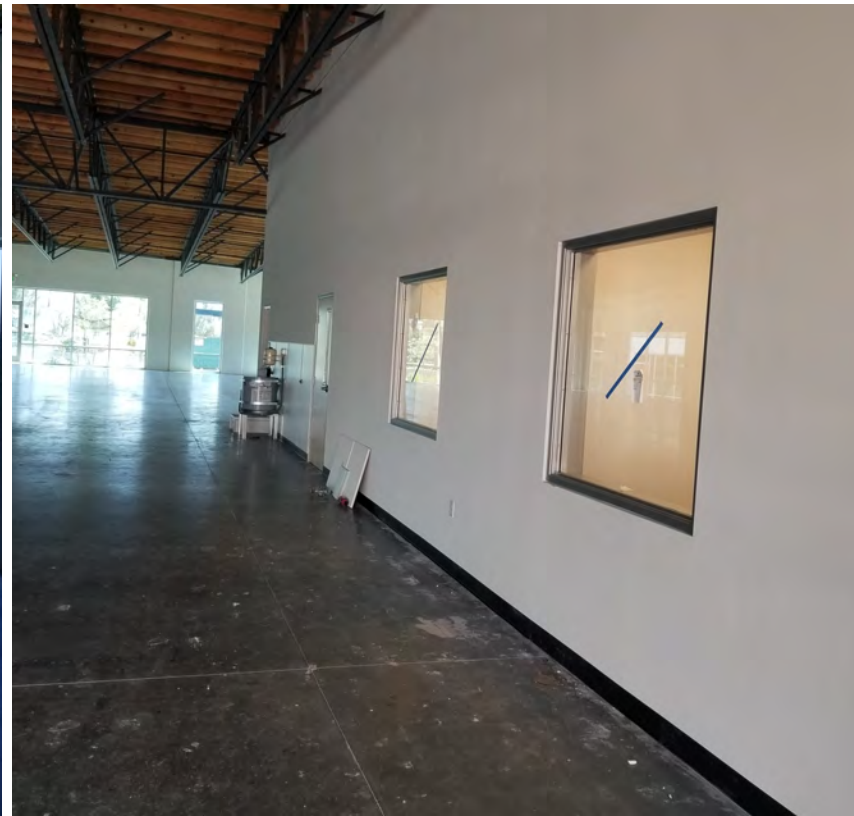



# 21850 VAN BUREN BLVD, BLDG. 10

Industrial Showroom Property | ± 9,400 SF

## FLOOR PLAN

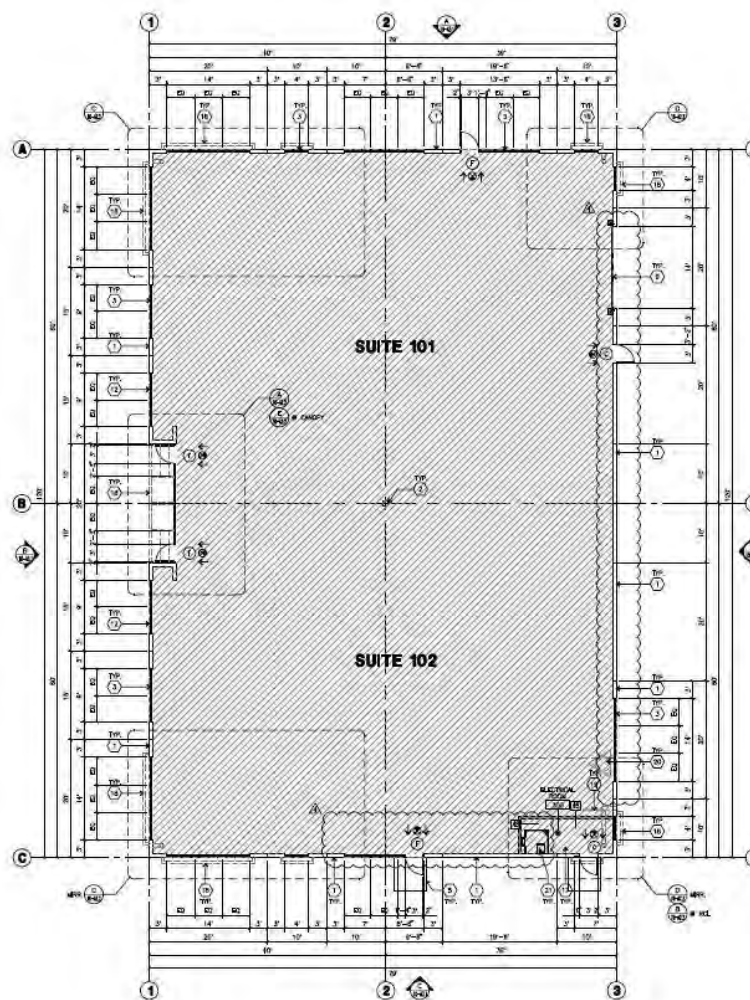

### EXCLUSIVE LISTING TEAM:

Joseph Paredes  
Executive Vice President | Principal  
P: 909.652.9054 | M: 949.566.5186  
joe.paredes@daumcre.com  
CADRE #01895260

Noah Samarin  
Executive Vice President | Principal  
P: 909.912.0007  
noah.samarin@daumcre.com  
CADRE #01755814

Christina Gurdzhyan  
Vice President  
P: 909.912.0010  
christina.gurdzhyan@daumcre.com  
CADRE #02071335

Although all information is furnished regarding for sale, rental or financing is from sources deemed reliable, such information has not been verified and no express representation is made nor is any to be implied as to the accuracy thereof, and it is submitted subject to errors, omissions, changes of price, rental or other conditions, prior sale, lease or financing, or withdrawal without notice.

# 21850 VAN BUREN BLVD, BLDG. 10

Industrial Showroom Property | ± 9,400 SF

## SITE PLAN

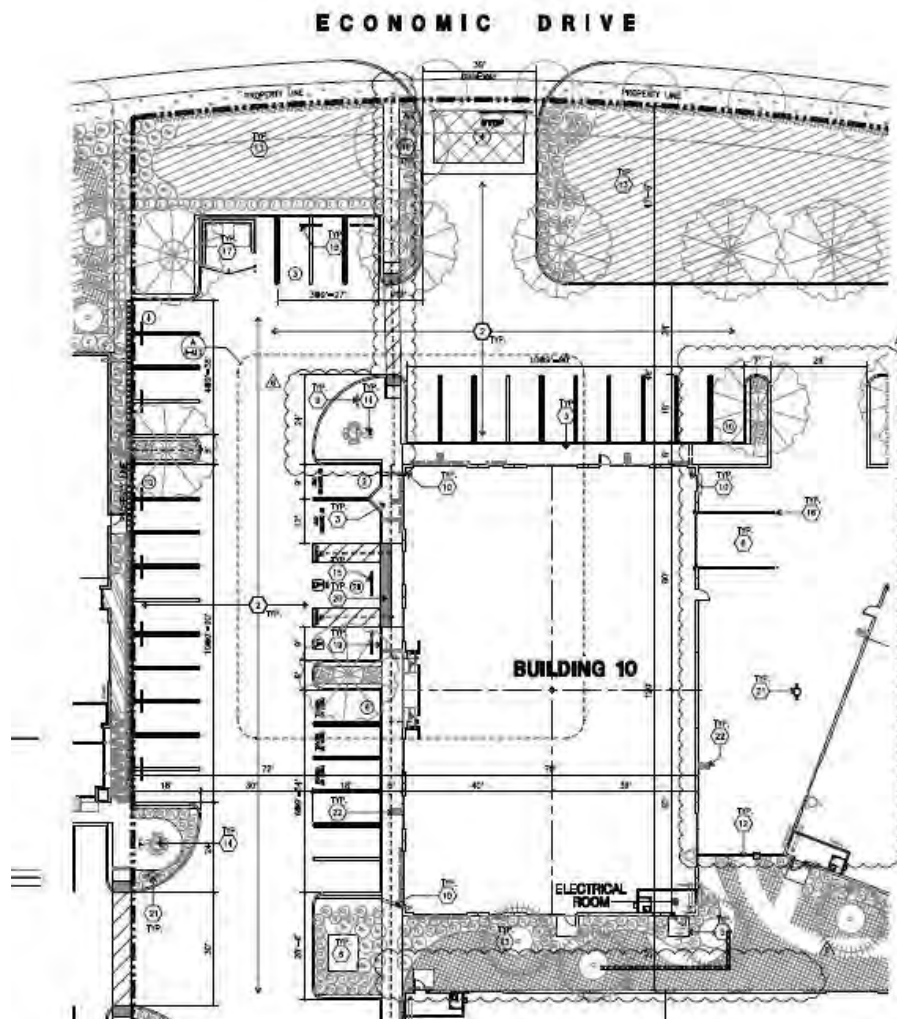

### EXCLUSIVE LISTING TEAM:

Joseph Paredes  
Executive Vice President | Principal  
P: 909.652.9054 | M: 949.566.5186  
joe.paredes@daumcre.com  
CADRE #01895260

Noah Samarin  
Executive Vice President | Principal  
P: 909.912.0007  
noah.samarin@daumcre.com  
CADRE #01755814

Christina Gurdzhyan  
Vice President  
P: 909.912.0010  
christina.gurdzhyan@daumcre.com  
CADRE #02071335

Although all information is furnished regarding for sale, rental or financing is from sources deemed reliable, such information has not been verified and no express representation is made nor is any to be implied as to the accuracy thereof, and it is submitted subject to errors, omissions, changes of price, rental or other conditions, prior sale, lease or financing, or withdrawal without notice.



# 21850 VAN BUREN BLVD, BLDG. 10

Industrial Showroom Property | ± 9,400 SF

Although all information is furnished regarding for sale, rental or financing is from sources deemed reliable, such information has not been verified and no express representation is made nor is any to be implied as to the accuracy thereof, and it is submitted subject to errors, omissions, changes of price, rental or other conditions, prior sale, lease or financing, or withdrawal without notice.



Google

Map data ©2022