

HIGH QUALITY INDUSTRIAL BUILDING UNDER CONSTRUCTION

FOR LEASE | ±192,903 SF (BUILDING B)



CARSON AGUA MANSA

1176 HALL AVENUE
JURUPA VALLEY | CA

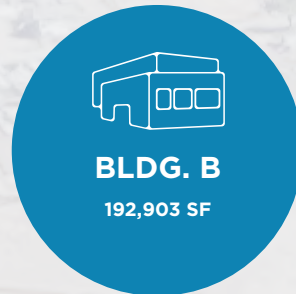

FOR MORE
INFORMATION,
CONTACT:

RICK JOHN, SIOR
EXECUTIVE VICE PRESIDENT
P: 909.912.0001 | F: 909.980.3775
RJ@DAUMCOMMERCIAL.COM
CA LICENSE # 00800783

GUS ANDROS, SIOR
EXECUTIVE VICE PRESIDENT
P: 909.912.0003 | F: 909.912.0013
GANDROS@DAUMCOMMERCIAL.COM
CA LICENSE # 01010235

D/AQ Corp. #01129558. Maps Courtesy ©Google & ©Microsoft. Although all information is furnished regarding for sale, rental or financing is from sources deemed reliable, such information has not been verified and no express representation is made nor is any to be implied as to the accuracy thereof, and it is submitted subject to errors, omissions, changes of price, rental or other conditions, prior sale, lease or financing, or withdrawal without notice.



SITE PLAN

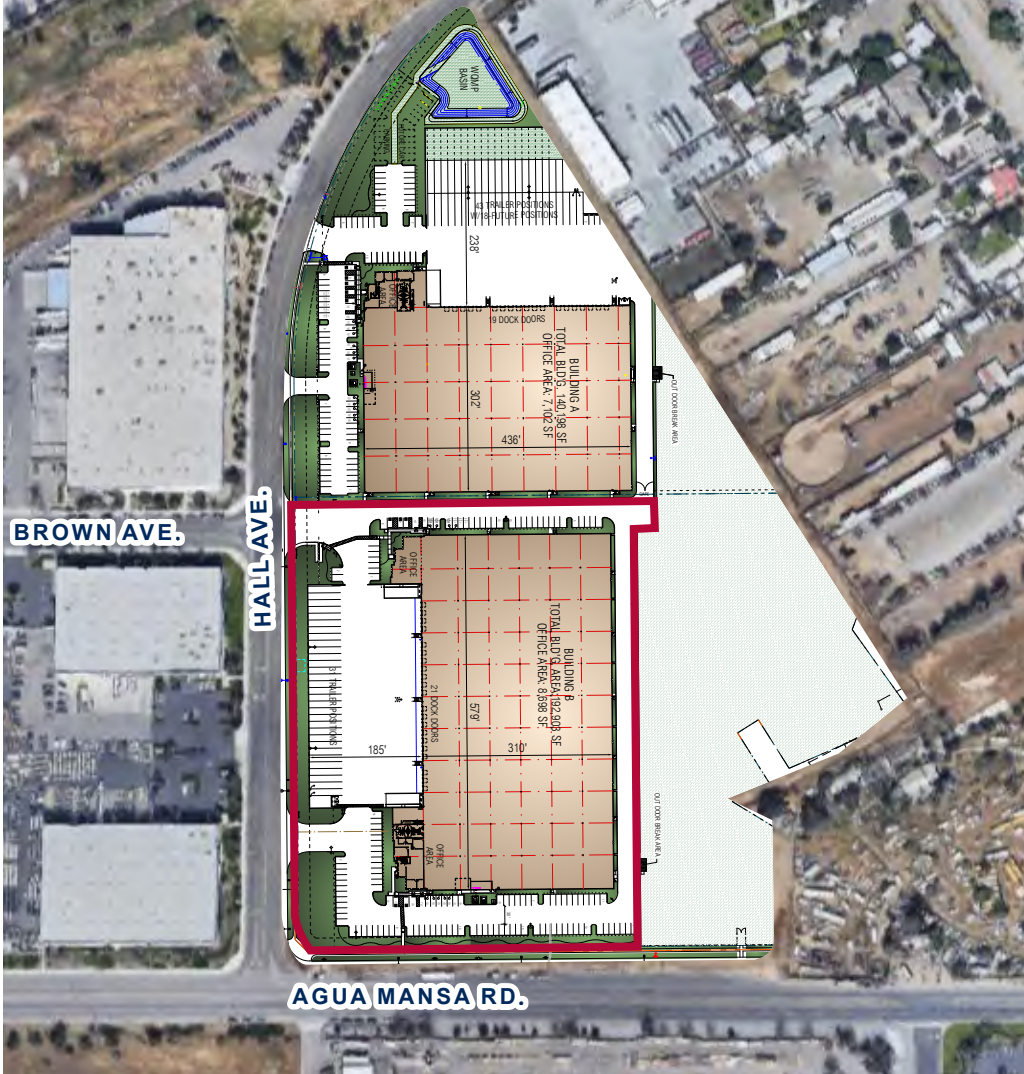

BUILDING SPECIFICATIONS

Bldg B	1176 Hall Avenue Jurupa Valley CA
Total SF:	192,903 SF <ul style="list-style-type: none"> Includes 8,698 SF of finished, open concept office, with 4,099 SF mezzanine with bathrooms and a wet bar
Dock Doors:	21 Dock Doors (9' x 10') <ul style="list-style-type: none"> 11 docks will include 40,000 lb mechanical pit levelers Electrical quad outlets at every other door Z-guards at every position Dock Bumpers at every position
Ground Level:	2 (12' x 14')
Big Ass Fans:	2
Truck Court:	185'
Clear Height:	32'
Trailer Parking Stalls:	31 Off Dock
Car Parking Stalls:	144 Parking Stalls (Including 5 Handicap)
Charging:	Conduit for EV Charging Stations in the Truck Court and Parking Stalls
Yard:	Fully Secured Site
Power:	2,000 Amps (expandable to 4,000 amps) 277/480 Volt 3 Phase, 4 Wire
Sprinkler:	ESFR K-25 Sprinkler Heads
Lighting:	30 ft Candle LED Lighting (3-4 fixtures per Bay)
Other:	7" Concrete Slab
	Built to LEED Standards
	Brine Line Access

±192,903 SF FOR LEASE

1176 HALL AVENUE | JURUPA VALLEY | CA

FOR MORE INFORMATION, CONTACT:

RICK JOHN, SIOR
EXECUTIVE VICE PRESIDENT
P: 909.912.0001 | F: 909.980.3775
RJ@DAUMCOMMERCIAL.COM
CA LICENSE # 00800783

GUS ANDROS, SIOR
EXECUTIVE VICE PRESIDENT
P: 909.912.0003 | F: 909.912.0013
GANDROS@DAUMCOMMERCIAL.COM
CA LICENSE # 01010235

D/AQ Corp. #01129558. Maps Courtesy ©Google & ©Microsoft. Although all information is furnished regarding for sale, rental or financing is from sources deemed reliable, such information has not been verified and no express representation is made nor is any to be implied as to the accuracy thereof, and it is submitted subject to errors, omissions, changes of price, rental or other conditions, prior sale, lease or financing, or withdrawal without notice.



FOR LEASE BUILDING B

1176 HALL AVENUE | JURUPA VALLEY | CA

PROPERTY HIGHLIGHTS



±14.26 Acres
Total Net Acres



2 (12' x 14')
Ground Level Loading



BRINE LINE ACCESS

<https://sawpa.org/inland-empire-brine-line/>
(Non-Reclaimable Waste Water Line)
Located in Hall Avenue



±192,903 SF
Building B



144
Parking Stalls
(Including 5 Handicap)



±8,698 SF / ±4,099 SF
Total Office / Mezzanine
with bathrooms + wet bar



Power
2,000 Amps (expandable to 4,000
amps) 277/480 Volt 3 Phase, 4 Wire



31
Trailer Parking Off Dock

Conduit for EV Charging
Stations in the Truck Court
and Parking Stalls



21 (9'x10')
Dock High Doors



ESFR | K-25
Sprinkler Heads



32'
Clear Height



(3-4 Fixtures per Bay)
30 ft Candle LED Lighting



2
Big Ass Fans



7"
Concrete Slab



185'
Fully Secure Truck Court



**Built to LEED
Standards**

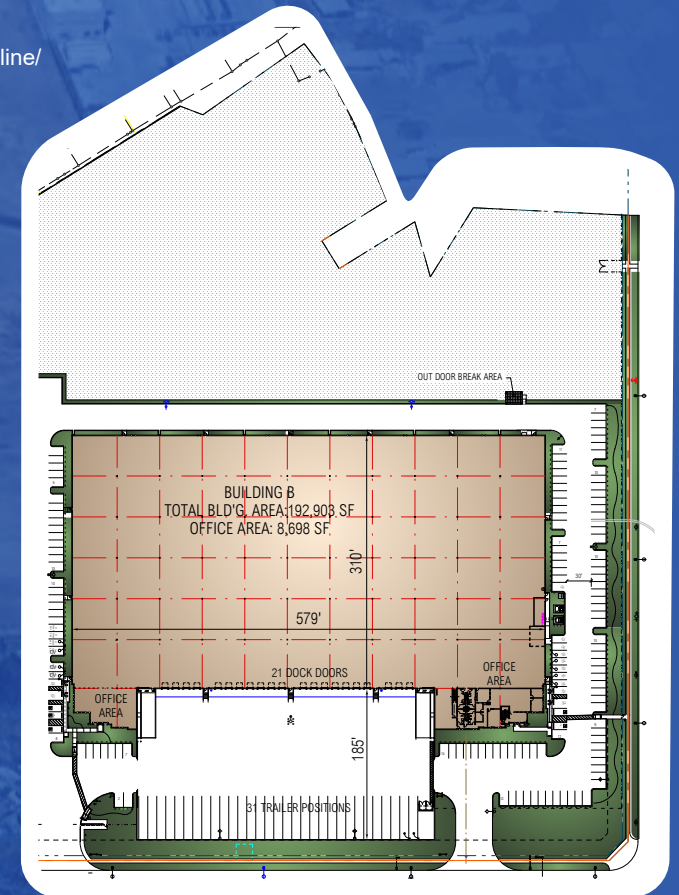
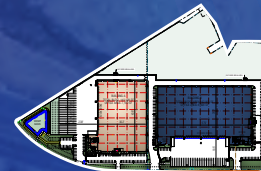

FOR MORE INFORMATION, CONTACT:

RICK JOHN, SIOR
EXECUTIVE VICE PRESIDENT
P: 909.912.0001 | F: 909.980.3775
RJ@DAUMCOMMERCIAL.COM
CA LICENSE # 00800783

GUS ANDROS, SIOR
EXECUTIVE VICE PRESIDENT
P: 909.912.0003 | F: 909.912.0013
GANDROS@DAUMCOMMERCIAL.COM
CA LICENSE # 01010235



LOCATION



±192,903 SF FOR LEASE

1176 HALL AVENUE | JURUPA VALLEY | CA

FOR MORE INFORMATION, CONTACT:

RICK JOHN, SIOR
EXECUTIVE VICE PRESIDENT
P: 909.912.0001 | F: 909.980.3775
RJ@DAUMCOMMERCIAL.COM
CA LICENSE # 00800783

GUS ANDROS, SIOR
EXECUTIVE VICE PRESIDENT
P: 909.912.0003 | F: 909.912.0013
GANDROS@DAUMCOMMERCIAL.COM
CA LICENSE # 01010235

D/AQ Corp. #01129558. Maps Courtesy ©Google & ©Microsoft. Although all information is furnished regarding for sale, rental or financing is from sources deemed reliable, such information has not been verified and no express representation is made nor is any to be implied as to the accuracy thereof, and it is submitted subject to errors, omissions, changes of price, rental or other conditions, prior sale, lease or financing, or withdrawal without notice.



FOR LEASE

1176 HALL AVENUE | JURUPA VALLEY | CA

LOCATION MAP



FOR MORE INFORMATION, CONTACT:

RICK JOHN, SIOR
EXECUTIVE VICE PRESIDENT
P: 909.912.0001 | F: 909.980.3775
RJ@DAUMCOMMERCIAL.COM
CA LICENSE # 00800783

GUS ANDROS, SIOR
EXECUTIVE VICE PRESIDENT
P: 909.912.0003 | F: 909.912.0013
GANDROS@DAUMCOMMERCIAL.COM
CA LICENSE # 01010235



FOR LEASE

1176 HALL AVENUE | JURUPA VALLEY | CA

LOCATION MAP

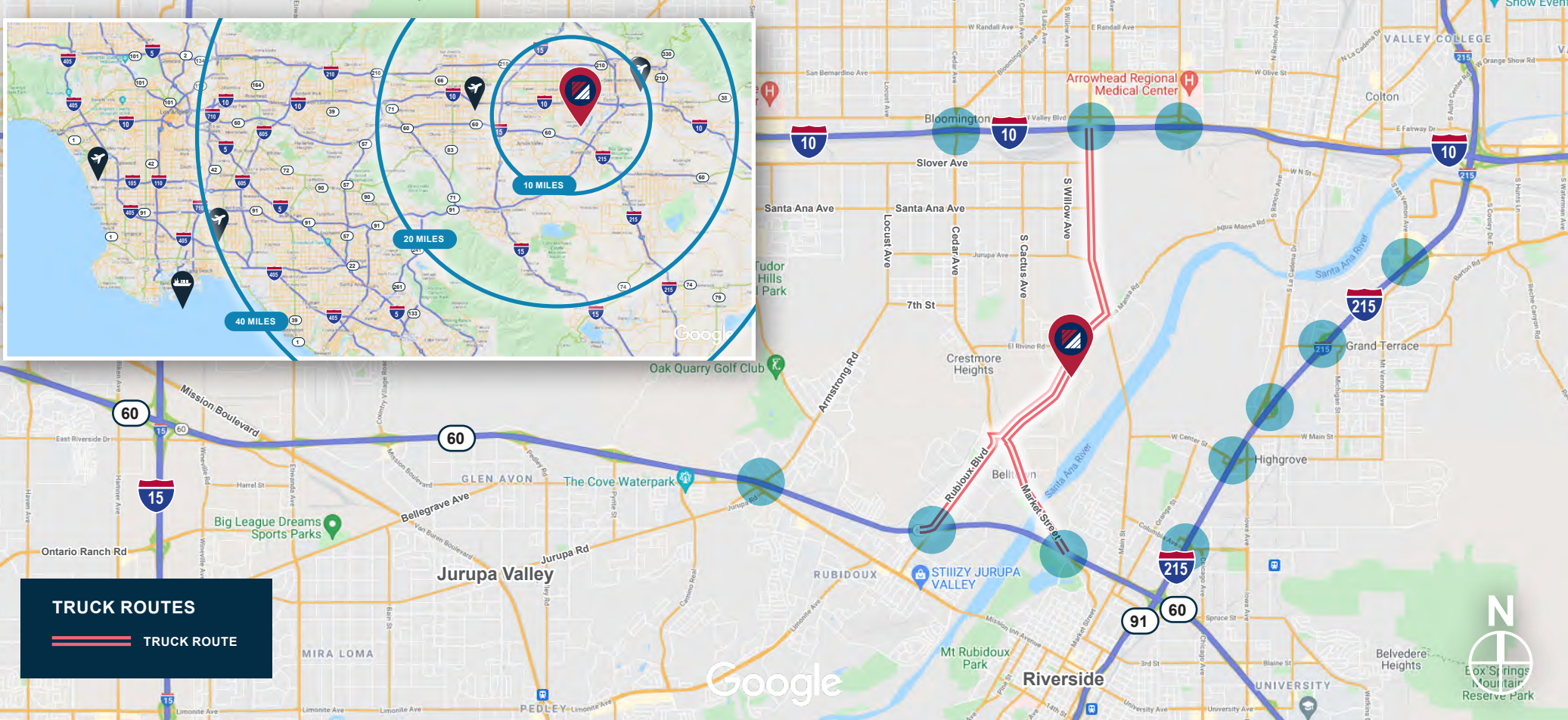

FOR MORE INFORMATION, CONTACT:

RICK JOHN, SIOR
EXECUTIVE VICE PRESIDENT
P: 909.912.0001 | F: 909.980.3775
RJ@DAUMCOMMERCIAL.COM
CA LICENSE # 00800783

GUS ANDROS, SIOR
EXECUTIVE VICE PRESIDENT
P: 909.912.0003 | F: 909.912.0013
GANDROS@DAUMCOMMERCIAL.COM
CA LICENSE # 01010235



D/QA Corp. #01129558. Maps Courtesy ©Google & ©Microsoft. Although all information is furnished regarding for sale, rental or financing is from sources deemed reliable, such information has not been verified and no express representation is made nor is any to be implied as to the accuracy thereof, and it is submitted subject to errors, omissions, changes of price, rental or other conditions, prior sale, lease or financing, or withdrawal without notice.