

FULLY ENTITLED FOR WAREHOUSE AND DISTRIBUTION USES

TWO (2) BUILDINGS TO BE CONSTRUCTED ON 23.1 NET ACRES

INDUSTRIAL | ±333,002 SF FOR LEASE



CARSON AGUA MANSA

12340 AGUA MANSA RD.
JURUPA VALLEY | CA

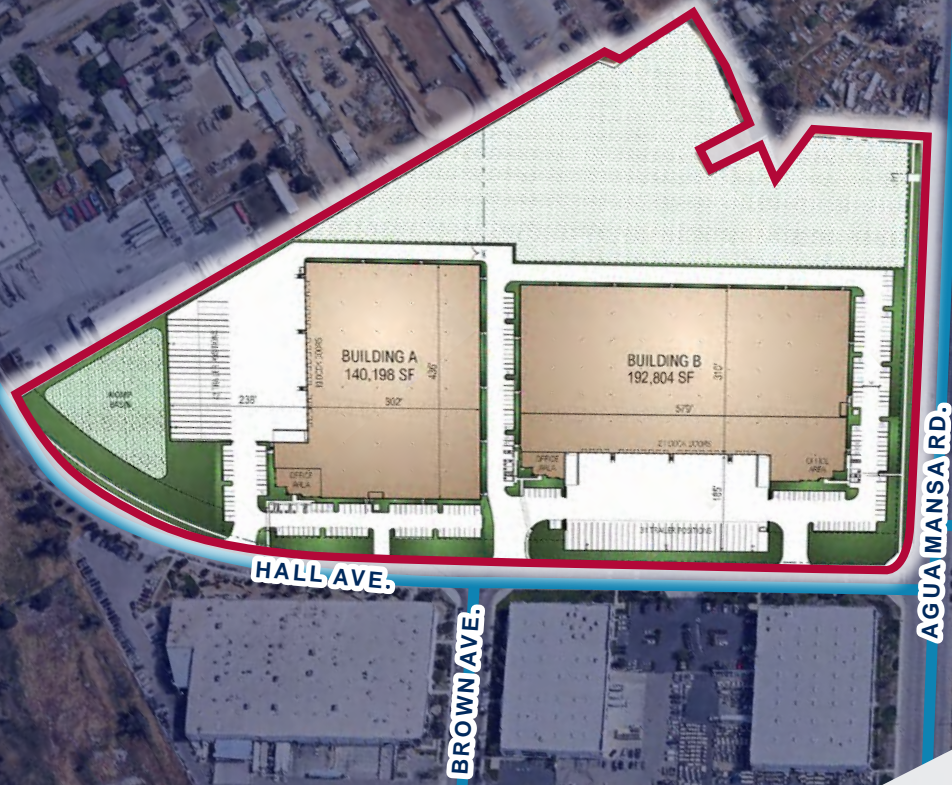

**GROUND
BREAKING
2Q 22**

**10, 215 & 60 FWYS
CLOSE PROXIMITY**

**TWO (2)
BUILDINGS**

FOR MORE INFORMATION, CONTACT:

RICK JOHN, SIOR
EXECUTIVE VICE PRESIDENT
P: 909.912.0001 | F: 909.980.3775
RJ@DAUMCOMMERCIAL.COM
CA LICENSE # 00800783

JOE PAREDES
EXECUTIVE VICE PRESIDENT
P: 909.652.9054 | F: 909.980.3775
JPAREDES@DAUMCOMMERCIAL.COM
CA LICENSE # 01895260

D/AQ Corp. #01129558. Maps Courtesy ©Google & ©Microsoft. Although all information is furnished regarding for sale, rental or financing is from sources deemed reliable, such information has not been verified and no express representation is made nor is any to be implied as to the accuracy thereof, and it is submitted subject to errors, omissions, changes of price, rental or other conditions, prior sale, lease or financing, or withdrawal without notice.



SITE PLAN



BUILDING SPECIFICATIONS

	Bldg A	Bldg B
Total SF:	140,198 SF • Includes 6,000 SF of finished, open concept office, including 3,000 SF mezzanine with bathrooms and a wet bar	192,804 SF • Includes 8,000 SF of finished, open concept office, including 4,000 SF mezzanine with bathrooms and a wet bar
Dock Doors:	19 Dock Doors (9' x 10') • 10 docks will include 35,000 lb mechanical pit levelers • Electrical quad outlets at every other door • Z-guards at every position • Dock Bumpers at every position	21 Dock Doors (9' x 10') • 11 docks will include 35,000 lb mechanical pit levelers • Electrical quad outlets at every other door • Z-guards at every position • Dock Bumpers at every position
Ground Level:	1 (12' x 14')	2 (12' x 14')
Big Ass Fans:	2	2
Truck Court:	238'	185'
Clear Height:	32'	32'
Trailer Parking Stalls:	41	31
Charging:	Conduit for EV Charging Stations in the Truck Court and Parking Stalls	Conduit for EV Charging Stations in the Truck Court and Parking Stalls
Yard:	Fully Secured Site	Fully Secured Site
Power:	2,000 Amps (expandable to 4,000 amps) 277/480 Volt 3 Phase, 4 Wire	2,000 Amps (expandable to 4,000 amps) 277/480 Volt 3 Phase, 4 Wire
Sprinkler:	ESFR K-17 Sprinkler Heads	ESFR K-17 Sprinkler Heads
Lighting:	Warehouse Lighting (2 Fixtures per Bay)	Warehouse Lighting (2 Fixtures per Bay)
Other:	7" Concrete Slab	7" Concrete Slab
	Built to LEED Standards	Built to LEED Standards

±333,002 SF FOR LEASE

12340 AGUA MANSÁ RD. | JURUPA VALLEY | CA

FOR MORE INFORMATION, CONTACT:

RICK JOHN, SIOR
EXECUTIVE VICE PRESIDENT
P: 909.912.0001 | F: 909.980.3775
RJ@DAUMCOMMERCIAL.COM
CA LICENSE # 00800783

JOE PAREDES
EXECUTIVE VICE PRESIDENT
P: 909.652.9054 | F: 909.980.3775
JPAREDES@DAUMCOMMERCIAL.COM
CA LICENSE # 01895260

D/AQ Corp. #01129558. Maps Courtesy ©Google & ©Microsoft. Although all information is furnished regarding for sale, rental or financing is from sources deemed reliable, such information has not been verified and no express representation is made nor is any to be implied as to the accuracy thereof, and it is submitted subject to errors, omissions, changes of price, rental or other conditions, prior sale, lease or financing, or withdrawal without notice.



FOR LEASE BUILDING A

PROPERTY HIGHLIGHTS

12340 AGUA MANSA RD | JURUPA VALLEY | CA



±8.82 Acres
Total Net Acres



1 (12' x 14')
Ground Level Loading



±140,198 SF
Building A



Power
2,000 Amps (expandable to 4,000
amps) 277/480 Volt 3 Phase, 4 Wire



±6,000 SF / ±3,000 SF
Total Office / Mezzanine
with bathrooms + wet bar

Conduit for EV Charging
Stations in the Truck Court
and Parking Stalls



41
Trailer Parking



ESFR | K-17
Sprinkler Heads



19 (9'x10')
Dock High Doors



(2 Fixtures per Bay)
Warehouse Lighting



32'
Clear Height



7"
Concrete Slab



2
Big Ass Fans



**Built to LEED
Standards**



238'
Fully Secure Truck Court

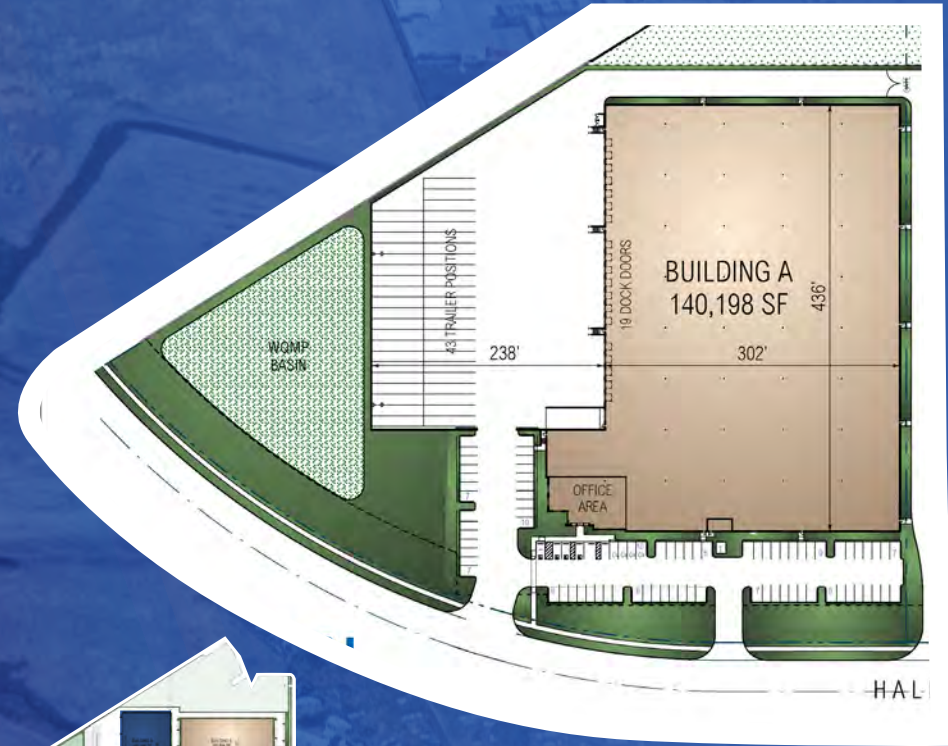

FOR MORE INFORMATION, CONTACT:

RICK JOHN, SIOR
EXECUTIVE VICE PRESIDENT
P: 909.912.0001 | F: 909.980.3775
RJ@DAUMCOMMERCIAL.COM
CA LICENSE # 00800783

JOE PAREDES
EXECUTIVE VICE PRESIDENT
P: 909.652.9054 | F: 909.980.3775
JPAREDES@DAUMCOMMERCIAL.COM
CA LICENSE # 01895260



CARSON
COMPANIES

DAUM
COMMERCIAL REAL ESTATE SERVICES

FOR LEASE BUILDING B

PROPERTY HIGHLIGHTS

12340 AGUA MANSA RD | JURUPA VALLEY | CA



±14.26 Acres
Total Net Acres



2 (12' x 14')
Ground Level Loading



±192,804 SF
Building B



Power
2,000 Amps (expandable to 4,000
amps) 277/480 Volt 3 Phase, 4 Wire



±8,000 SF / ±4,000 SF
Total Office / Mezzanine
with bathrooms + wet bar

Conduit for EV Charging
Stations in the Truck Court
and Parking Stalls



31
Trailer Parking



ESFR | K-17
Sprinkler Heads



21 (9'x10')
Dock High Doors



(2 Fixtures per Bay)
Warehouse Lighting



32'
Clear Height



7"
Concrete Slab



2
Big Ass Fans



**Built to LEED
Standards**



185'
Fully Secure Truck Court

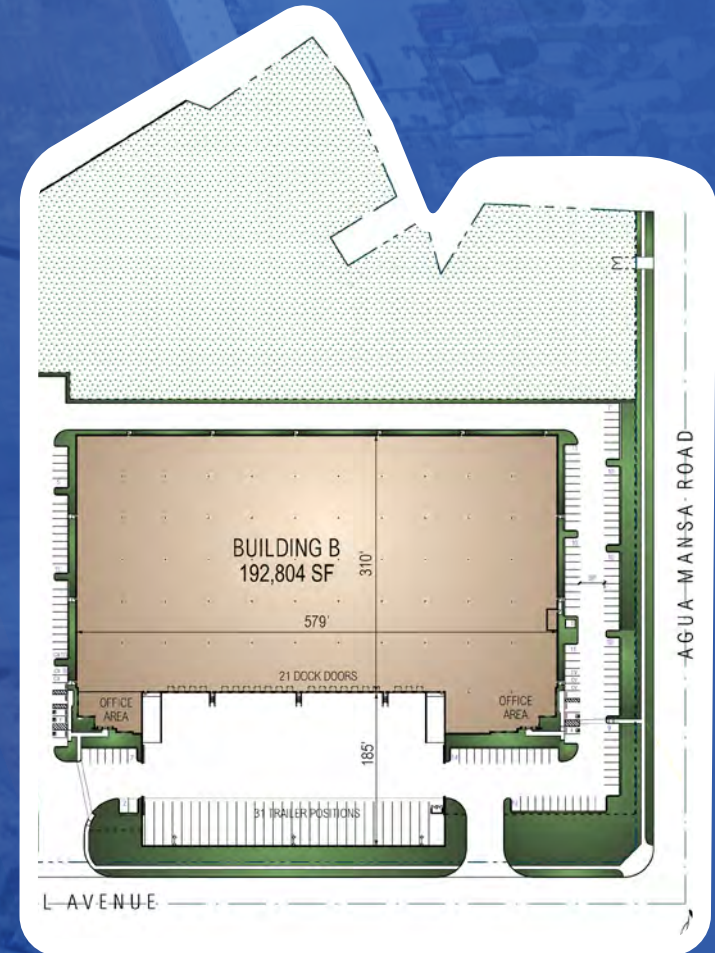

FOR MORE INFORMATION, CONTACT:

RICK JOHN, SIOR
EXECUTIVE VICE PRESIDENT
P: 909.912.0001 | F: 909.980.3775
RJ@DAUMCOMMERCIAL.COM
CA LICENSE # 00800783

JOE PAREDES
EXECUTIVE VICE PRESIDENT
P: 909.652.9054 | F: 909.980.3775
JPAREDES@DAUMCOMMERCIAL.COM
CA LICENSE # 01895260



LOCATION

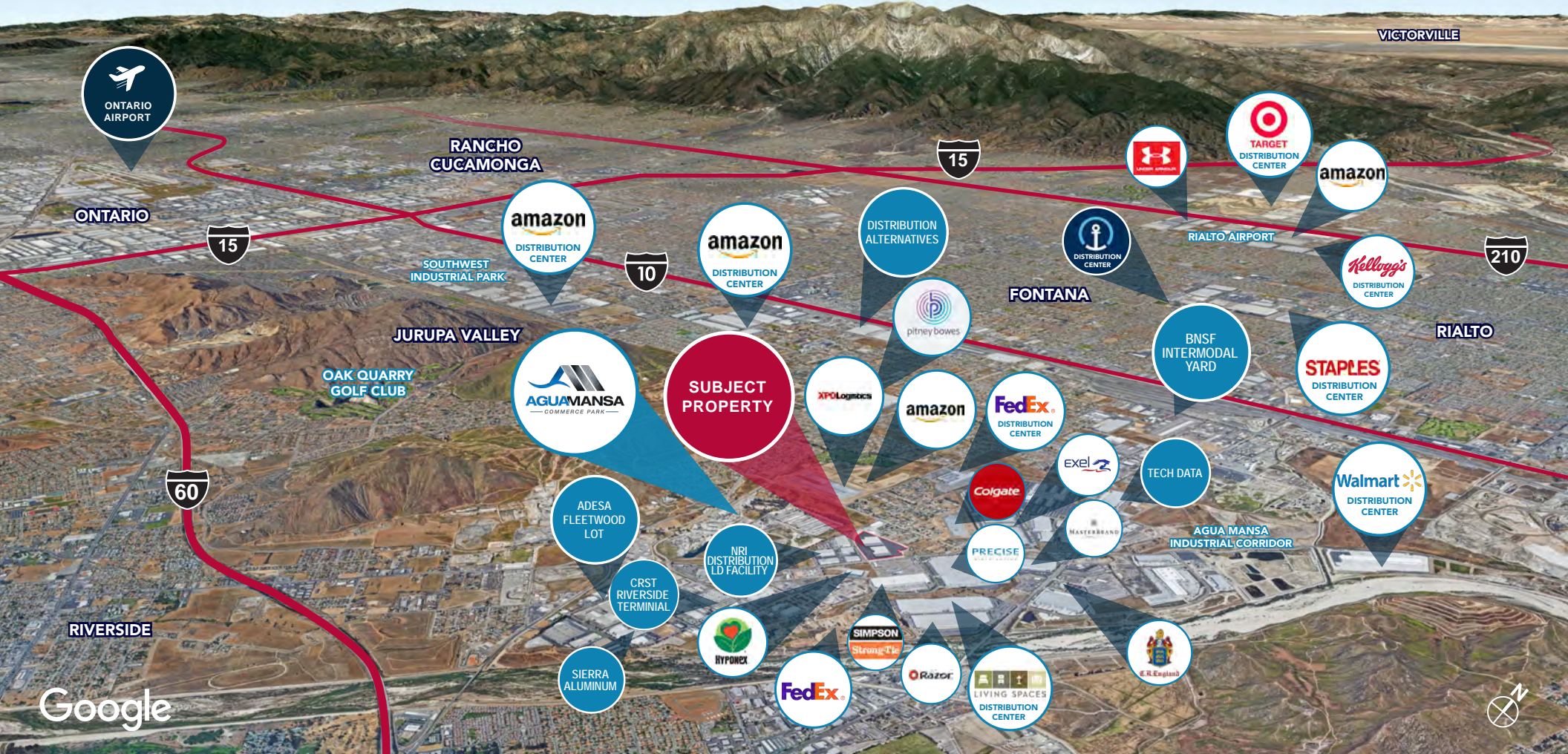

±335,002 SF FOR LEASE

12340 AGUA MANSA RD. | JURUPA VALLEY | CA

FOR MORE INFORMATION, CONTACT:

RICK JOHN, SIOR
 EXECUTIVE VICE PRESIDENT
 P: 909.912.0001 | F: 909.980.3775
 RJ@DAUMCOMMERCIAL.COM
 CA LICENSE # 00800783

JOE PAREDES
 EXECUTIVE VICE PRESIDENT
 P: 909.652.9054 | F: 909.980.3775
 JPAREDES@DAUMCOMMERCIAL.COM
 CA LICENSE # 01895260

D/AQ Corp. #01129558. Maps Courtesy ©Google & ©Microsoft. Although all information is furnished regarding to sale, rental or financing is from sources deemed reliable, such information has not been verified and no express representation is made nor is any to be implied as to the accuracy thereof, and it is submitted subject to errors, omissions, changes of price, rental or other conditions, prior sale, lease or financing, or withdrawal without notice.



FOR LEASE

12340 AGUA MANSARD | JURUPA VALLEY | CA

LOCATION MAP



FOR MORE INFORMATION, CONTACT:

RICK JOHN, SIOR
EXECUTIVE VICE PRESIDENT
P: 909.912.0001 | F: 909.980.3775
RJ@DAUMCOMMERCIAL.COM
CA LICENSE # 00800783

JOE PAREDES
EXECUTIVE VICE PRESIDENT
P: 909.652.9054 | F: 909.980.3775
JPAREDES@DAUMCOMMERCIAL.COM
CA LICENSE # 01895260



FOR LEASE

12340 AGUA MANSA RD | JURUPA VALLEY | CA

LOCATION MAP

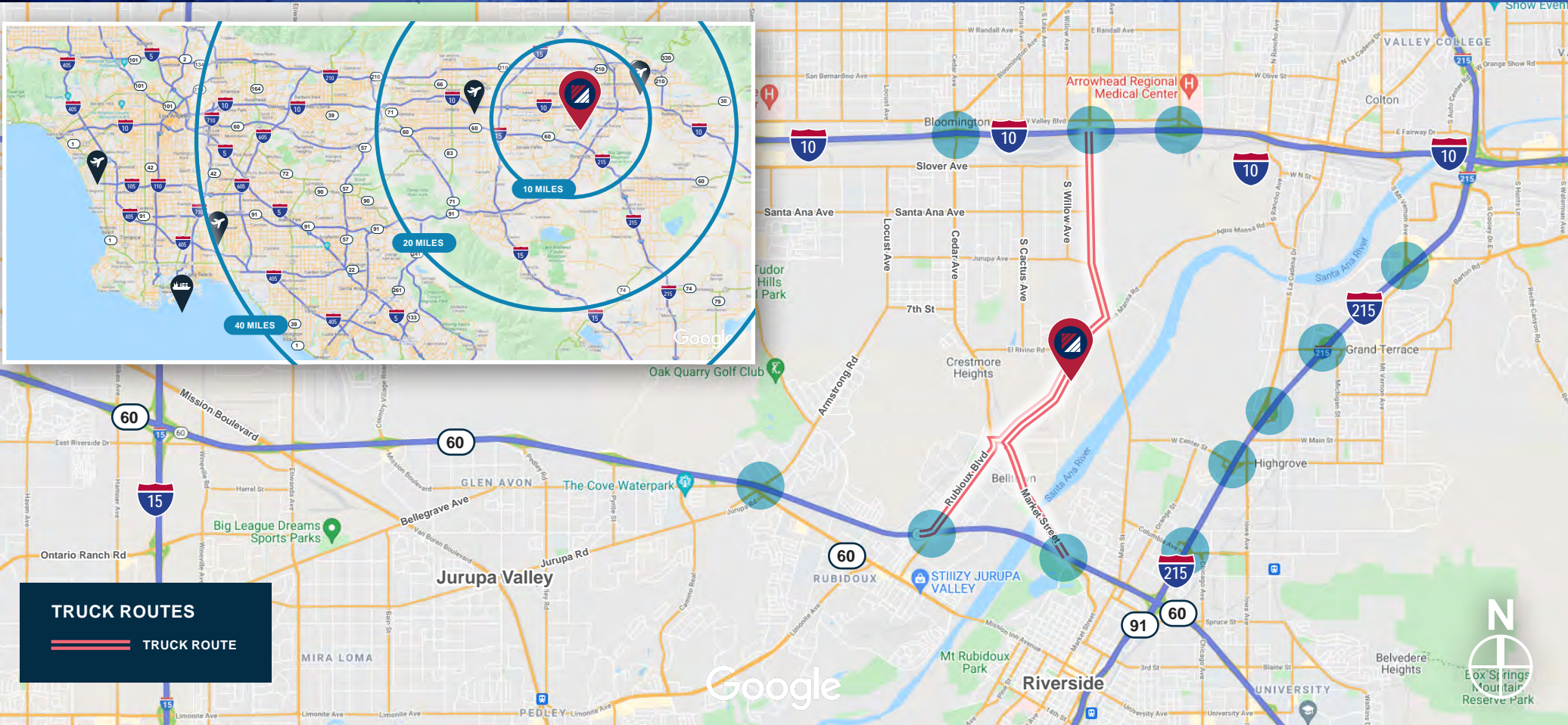

TRUCK ROUTES
TRUCK ROUTE

FOR MORE INFORMATION, CONTACT:

RICK JOHN, SIOR
EXECUTIVE VICE PRESIDENT
P: 909.912.0001 | F: 909.980.3775
RJ@DAUMCOMMERCIAL.COM
CA LICENSE # 00800783

JOE PAREDES
EXECUTIVE VICE PRESIDENT
P: 909.652.9054 | F: 909.980.3775
JPAREDES@DAUMCOMMERCIAL.COM
CA LICENSE # 01895260

