



2619 E. 8TH STREET
LOS ANGELES | CA

FOR SALE | 8,128 SF
INDUSTRIAL MANUFACTURING

FOR MORE INFORMATION, CONTACT:

BRYAN ABAYAN
ASSOCIATE
P: 310.883.8476
babayan@daumcre.com
CA Lic # 02005294

JERRY SACKLER
EXECUTIVE VICE PRESIDENT
O: 213.270.2267
jsackler@daumcre.com
CA Lic # 01098039



PROPERTY FEATURES



8,128 SF
BUILDING



0.18 SF
LOT SIZE



1,600 SF
OFFICE SPACE



12-14'
CLEAR HEIGHT



M2
ZONING



800 V: 240/240
0: 3 W: 0 POWER



10 PARKING
SPACES

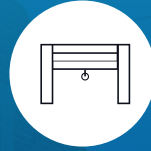

1 GL DOOR
& 1 DH DOOR



1930
YEAR BUILT



FENCED
YARD



BRICK
CONSTRUCTION



S. SOTO ST/E. 8TH ST
CROSS STREET

- \$3,251,200.00 Sale Price
- \$400.00 Per Square Foot
- Functional Building
- Dock High Loading
- Excellent Location/High Traffic Area / Great Signage
- Two Five Ton Air Conditioning Systems

- Immediate Access to 5, 10 & 60 Freeways
- Ideal For Creative Uses
- Minutes From Arts District and 6th Street Viaduct Bridge

FOR SALE | 8,128 SF

INDUSTRIAL MANUFACTURING

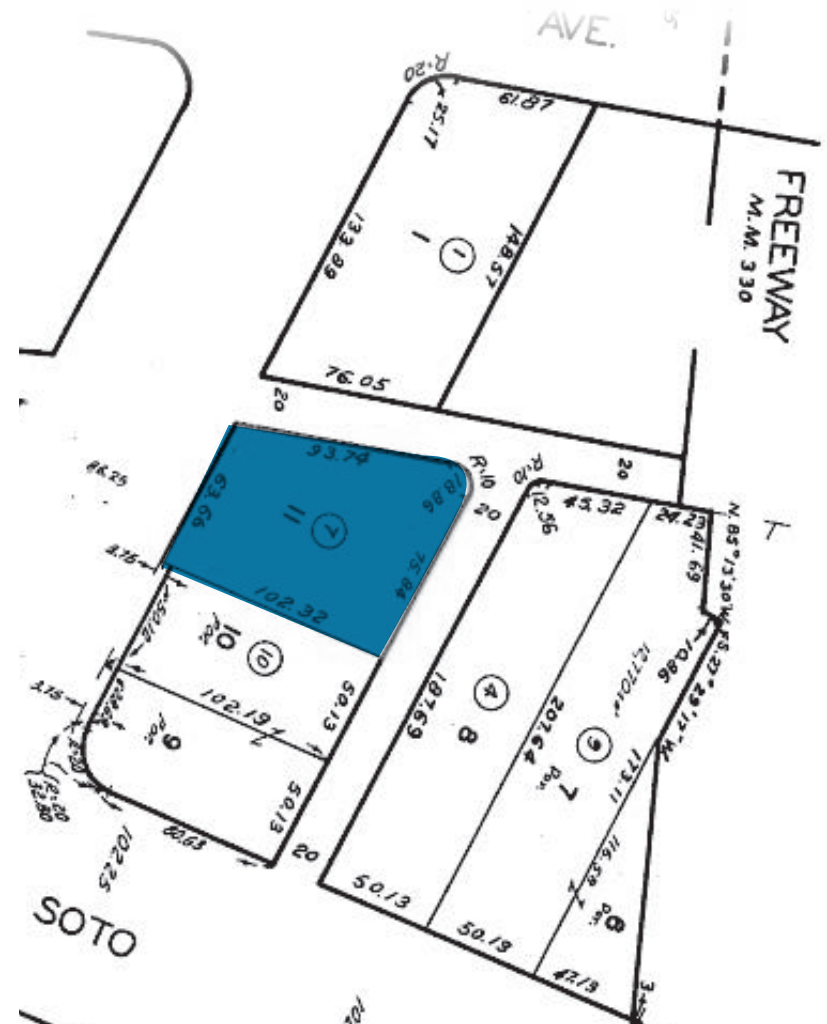

2619 E. 8TH STREET

LOS ANGELES | CA

FOR MORE INFORMATION, PLEASE CONTACT

BRYAN ABAYAN
ASSOCIATE
P: 310.883.8476
babayan@daumcre.com
CA Lic # 02005294

JERRY SACKLER
EXECUTIVE VICE PRESIDENT
O: 213.270.2267
jsackler@daumcre.com
CA Lic # 01098039

PARCEL MAP

DAUM
COMMERCIAL REAL ESTATE SERVICES

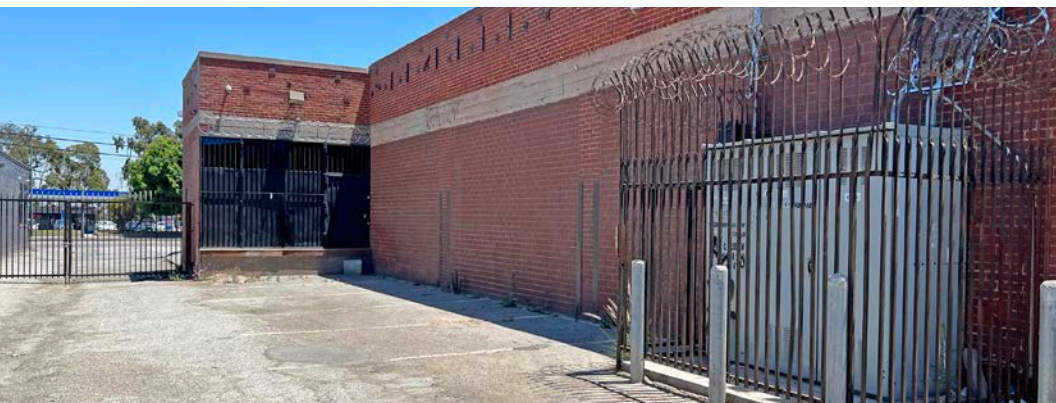

2619 E. 8TH STREET

LOS ANGELES | CA

FOR MORE INFORMATION, PLEASE CONTACT

BRYAN ABAYAN
ASSOCIATE
P: 310.883.8476
babayan@daumcre.com
CA Lic # 02005294

JERRY SACKLER
EXECUTIVE VICE PRESIDENT
O: 213.270.2267
jsackler@daumcre.com
CA Lic # 01098039

PROPERTY PHOTOS



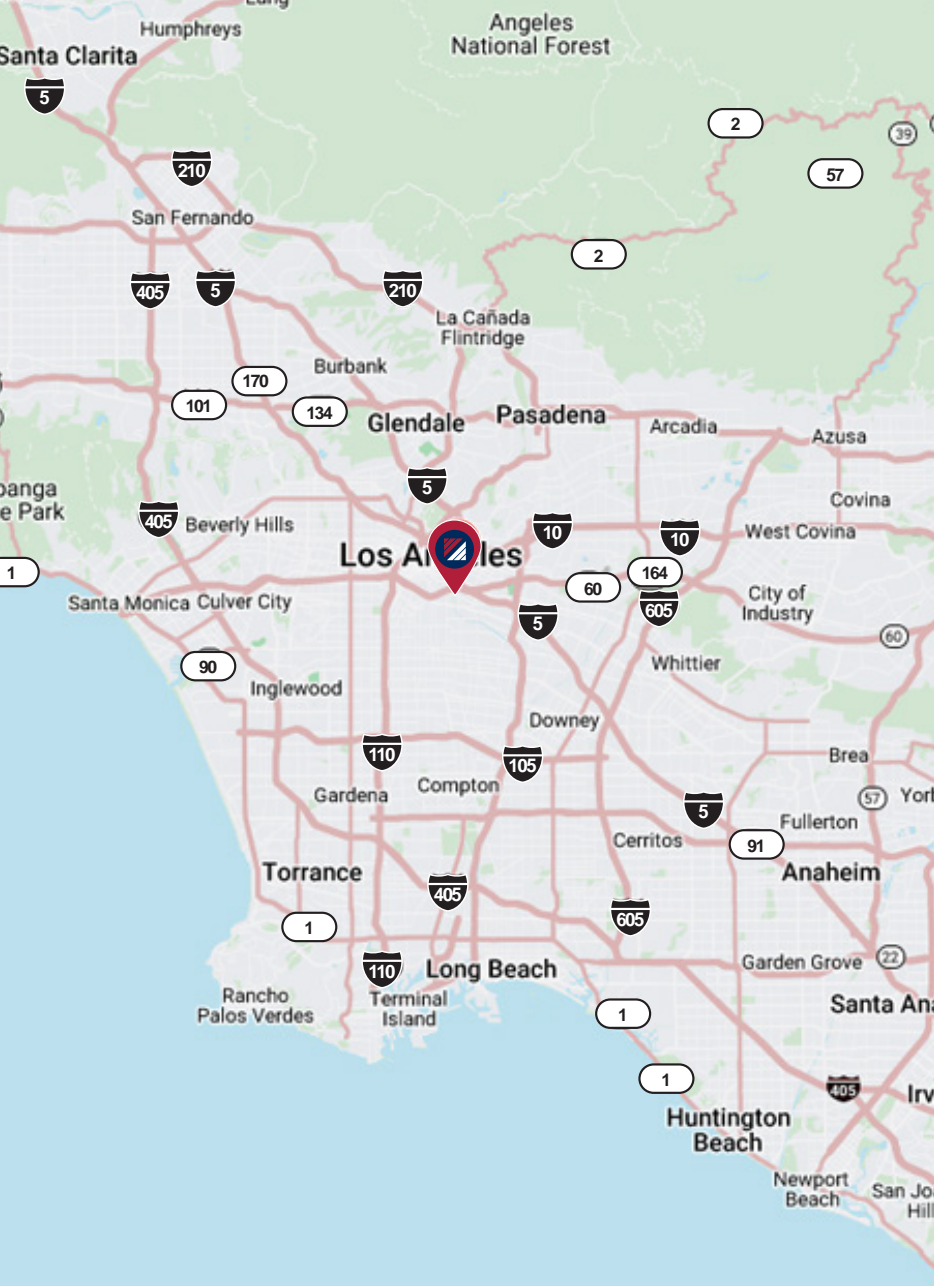

2619 E. 8TH STREET

LOS ANGELES | CA

FOR MORE INFORMATION, PLEASE CONTACT

BRYAN ABAYAN
 ASSOCIATE
 P: 310.883.8476
 babayan@daumcre.com
 CA Lic # 02005294

JERRY SACKLER
 EXECUTIVE VICE PRESIDENT
 O: 213.270.2267
 jsackler@daumcre.com
 CA Lic # 01098039

LOCAL AMENITIES
DAUM
 COMMERCIAL REAL ESTATE SERVICES

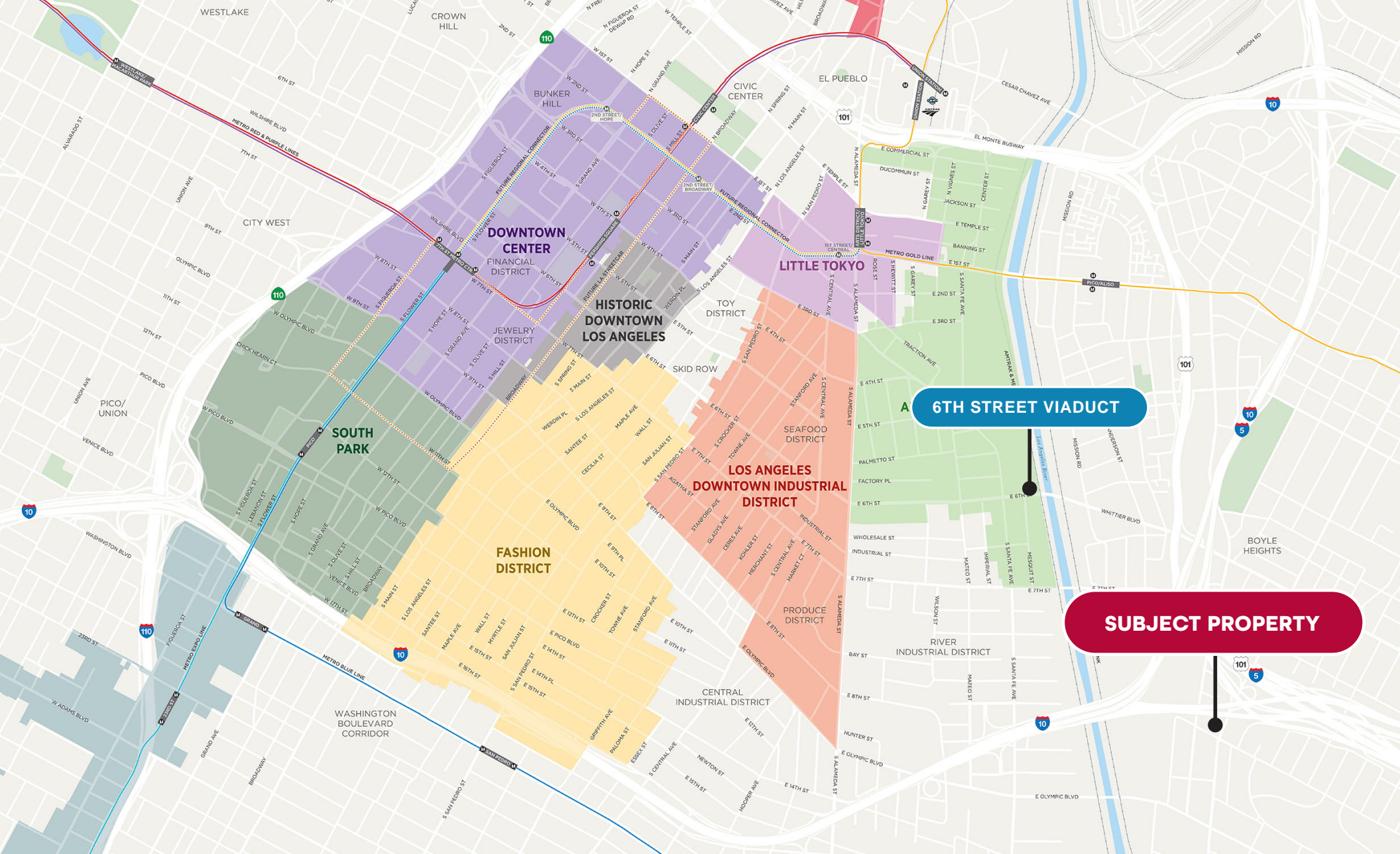

2619 E. 8TH STREET

LOS ANGELES | CA

FOR MORE INFORMATION, PLEASE CONTACT

BRYAN ABAYAN
 ASSOCIATE
 P: 310.883.8476
 babayan@daumcre.com
 CA Lic # 02005294

JERRY SACKLER
 EXECUTIVE VICE PRESIDENT
 O: 213.270.2267
 jsackler@daumcre.com
 CA Lic # 01098039

LOCATION MAP



D/AQ Corp. #01129558. Maps Courtesy ©Google & ©Microsoft. Although all information is furnished regarding for sale, rental or financing is from sources deemed reliable, such information has not been verified and no express representation is made nor is any to be implied as to the accuracy thereof, and it is submitted subject to errors, omissions, changes of price, rental or other conditions, prior sale, lease or financing, or withdrawal without notice.



2619

2619 E. 8TH STREET

LOS ANGELES | CA

FOR SALE | 8,128 SF INDUSTRIAL MANUFACTURING

FOR MORE INFORMATION, CONTACT:

JERRY SACKLER
EXECUTIVE VICE PRESIDENT
O: 213.270.2267
jsackler@daumcre.com
CA Lic # 01098039

BRYAN ABAYAN
ASSOCIATE
P: 310.883.8476
babayan@daumcre.com
CA Lic # 02005294

