



FOR LEASE

±11,172 SF WAREHOUSE

5455 E. LA PALMA AVE. | UNIT C-2 | ANAHEIM, CA

PROPERTY HIGHLIGHTS

- ±11,172 SF Available
- Warehouse (±8,745 SF)
- Office/Showroom (±2,427 SF)
- POL Multi-Tenant Warehouse
- 1 Dock High door
- 26' Clear Height
- Sprinkler: .33/3,000 SF (Verify)
- Power: 400 Amps 277/480 Volt 3-Phase (Verify)
- Available with 30 Days' Notice

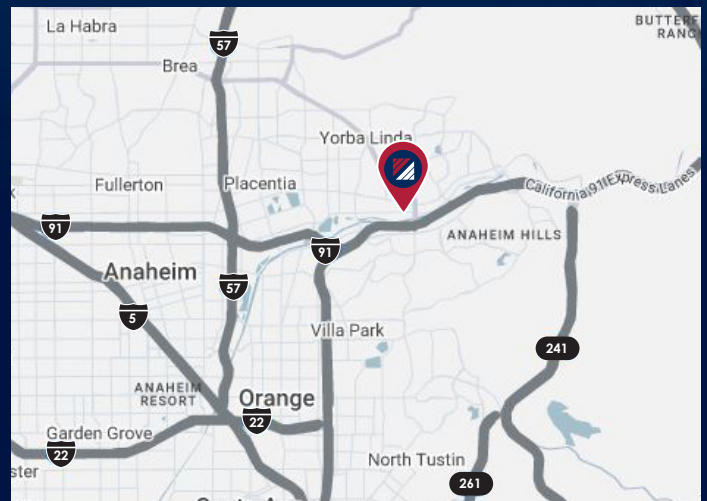

FOR MORE INFORMATION, PLEASE CONTACT:

NOAH SAMARIN
EXECUTIVE VICE PRESIDENT | PRINCIPAL
P: 909.912.0007 | M: 714.812.1289
noah.samarin@daumcommercial.com
CADRE #01755814

TIM TANG
ASSOCIATE
P: 909.912.0019 | M: 949.648.1650
ttang@daumcommercial.com
CADRE # 02237441

DAUM
COMMERCIAL REAL ESTATE SERVICES

FOR LEASE

±11,172 SF WAREHOUSE

5455 E. LA PALMA AVE. | UNIT C-2 | ANAHEIM, CA



FOR MORE INFORMATION, PLEASE CONTACT:

NOAH SAMARIN
EXECUTIVE VICE PRESIDENT | PRINCIPAL
P: 909.912.0007 | M: 714.812.1289
noah.samarin@daumcommercial.com
CADRE #01755814

TIM TANG
ASSOCIATE
P: 909.912.0019 | M: 949.648.1650
ttang@daumcommercial.com
CADRE # 02237441

DAUM
COMMERCIAL REAL ESTATE SERVICES

Although all information is furnished regarding for sale, rental or financing from sources deemed reliable, such information has not been verified and no express representation is made nor is any to be implied as to the accuracy thereof, and it is submitted subject to errors, omissions, changes of price, rental or other conditions, prior sale, lease or financing, or withdrawal without notice. All Maps provided courtesy of Google Maps, Bing Maps, and Google Earth. D/AQ Corp. # 01129558

FOR LEASE

±11,172 SF WAREHOUSE

5455 E. LA PALMA AVE. | UNIT C-2 | ANAHEIM, CA

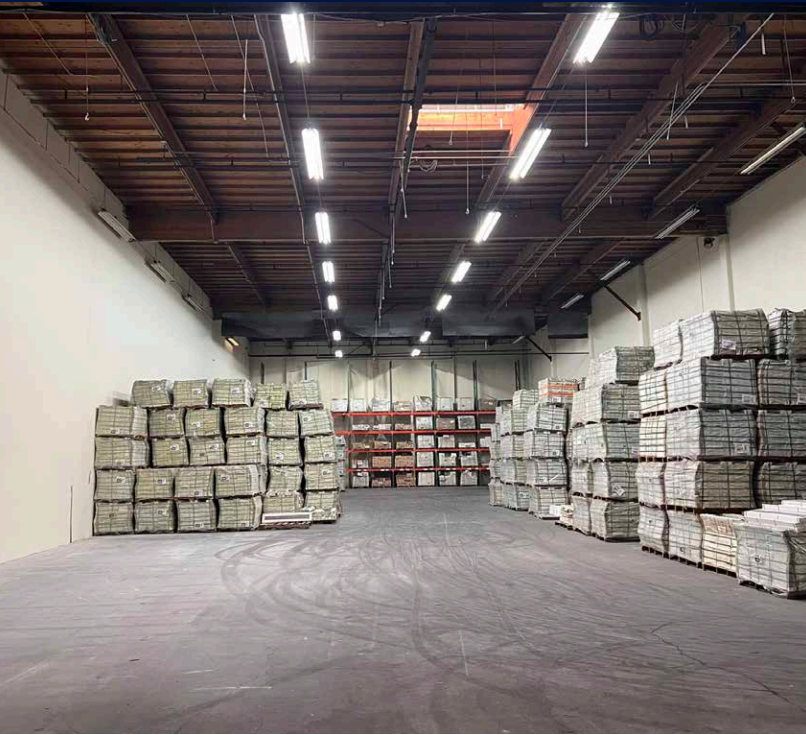

FOR MORE INFORMATION, PLEASE CONTACT:

NOAH SAMARIN
EXECUTIVE VICE PRESIDENT | PRINCIPAL
P: 909.912.0007 | M: 714.812.1289
noah.samarin@daumcommercial.com
CADRE #01755814

TIM TANG
ASSOCIATE
P: 909.912.0019 | M: 949.648.1650
ttang@daumcommercial.com
CADRE # 02237441

DAUM
COMMERCIAL REAL ESTATE SERVICES

Although all information is furnished regarding for sale, rental or financing from sources deemed reliable, such information has not been verified and no express representation is made nor is any to be implied as to the accuracy thereof, and it is submitted subject to errors, omissions, changes of price, rental or other conditions, prior sale, lease or financing, or withdrawal without notice. All Maps provided courtesy of Google Maps, Bing Maps, and Google Earth. D/AQ Corp. # 01129558

FOR LEASE

±11,172 SF WAREHOUSE

5455 E. LA PALMA AVE. | UNIT C-2 | ANAHEIM, CA

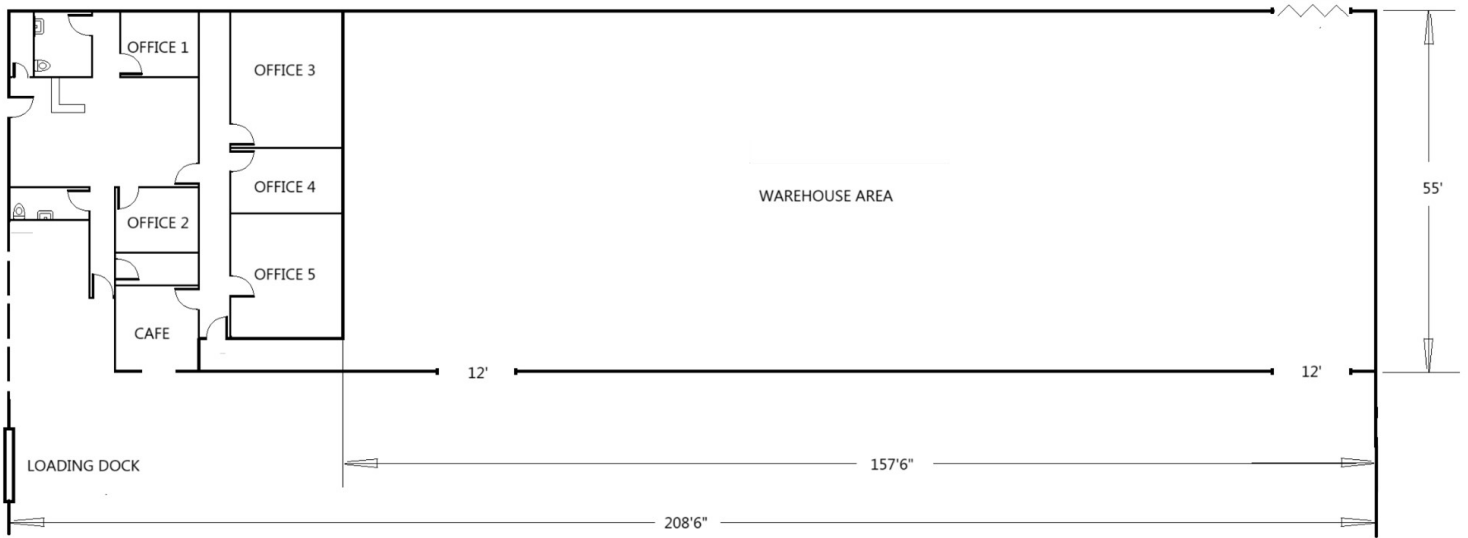

FOR MORE INFORMATION, PLEASE CONTACT:

NOAH SAMARIN
EXECUTIVE VICE PRESIDENT | PRINCIPAL
P: 909.912.0007 | M: 714.812.1289
noah.samarin@daumcommercial.com
CADRE #01755814

TIM TANG
ASSOCIATE
P: 909.912.0019 | M: 949.648.1650
ttang@daumcommercial.com
CADRE # 02237441

DAUM
COMMERCIAL REAL ESTATE SERVICES

Although all information is furnished regarding for sale, rental or financing from sources deemed reliable, such information has not been verified and no express representation is made nor is any to be implied as to the accuracy thereof, and it is submitted subject to errors, omissions, changes of price, rental or other conditions, prior sale, lease or financing, or withdrawal without notice. All Maps provided courtesy of Google Maps, Bing Maps, and Google Earth. D/AQ Corp. # 01129558

