



# FOR LEASE

## ±16,772 SF WAREHOUSE

5455 E. LA PALMA AVE. | UNIT C-2 | ANAHEIM, CA

### PROPERTY HIGHLIGHTS

- ±16,772 SF Available
- Warehouse (±13,917 SF)
- Office/Showroom (±2,805 SF)
- POL Multi-Tenant Warehouse
- 1 Dock High door
- 26' Clear Height
- Sprinkler: .33/3,000 SF (Verify)
- Power: 400 Amps 277/480 Volt 3-Phase (Verify)
- Available with 30 Days' Notice

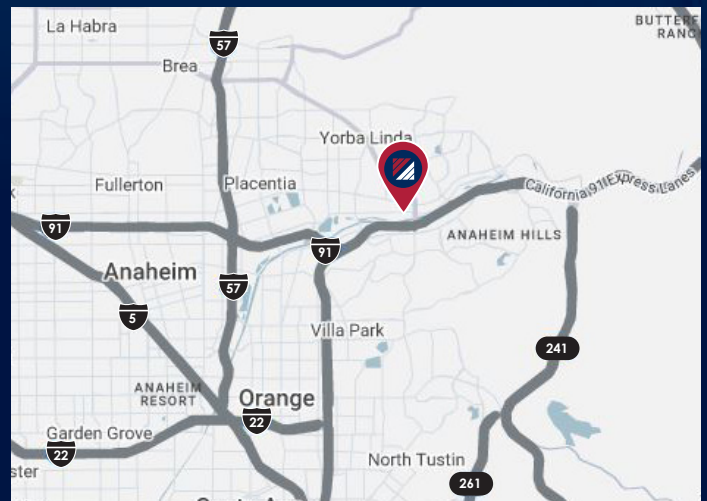

### FOR MORE INFORMATION, PLEASE CONTACT:

**NOAH SAMARIN**  
EXECUTIVE VICE PRESIDENT | PRINCIPAL  
P: 909.912.0007 | M: 714.812.1289  
noah.samarin@daumcommercial.com  
CADRE #01755814

**TIM TANG**  
ASSOCIATE  
P: 909.912.0019 | M: 949.648.1650  
ttang@daumcommercial.com  
CADRE # 02237441

**DAUM**  
COMMERCIAL REAL ESTATE SERVICES

# FOR LEASE

## ±16,772 SF WAREHOUSE

5455 E. LA PALMA AVE. | UNIT C-2 | ANAHEIM, CA



### FOR MORE INFORMATION, PLEASE CONTACT:

**NOAH SAMARIN**  
EXECUTIVE VICE PRESIDENT | PRINCIPAL  
P: 909.912.0007 | M: 714.812.1289  
noah.samarin@daumcommercial.com  
CADRE #01755814

**TIM TANG**  
ASSOCIATE  
P: 909.912.0019 | M: 949.648.1650  
ttang@daumcommercial.com  
CADRE # 02237441

### PHOTOS

**DAUM**  
COMMERCIAL REAL ESTATE SERVICES

Although all information is furnished regarding for sale, rental or financing from sources deemed reliable, such information has not been verified and no express representation is made nor is any to be implied as to the accuracy thereof, and it is submitted subject to errors, omissions, changes of price, rental or other conditions, prior sale, lease or financing, or withdrawal without notice. All Maps provided courtesy of Google Maps, Bing Maps, and Google Earth. D/AQ Corp. # 01129558

# FOR LEASE

## ±16,772 SF WAREHOUSE

5455 E. LA PALMA AVE. | UNIT C-2 | ANAHEIM, CA

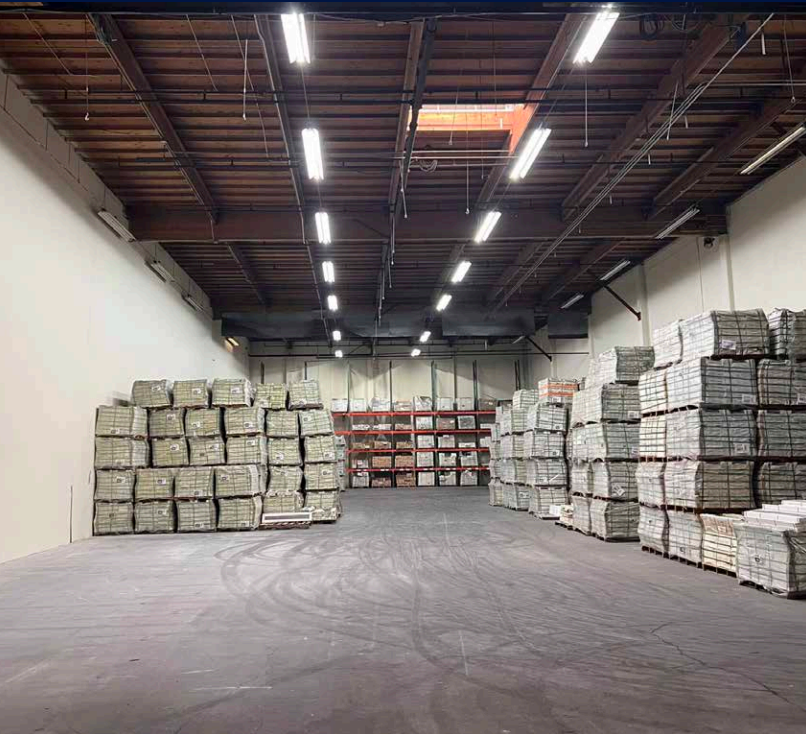

### FOR MORE INFORMATION, PLEASE CONTACT:

**NOAH SAMARIN**  
EXECUTIVE VICE PRESIDENT | PRINCIPAL  
P: 909.912.0007 | M: 714.812.1289  
noah.samarin@daumcommercial.com  
CADRE #01755814

**TIM TANG**  
ASSOCIATE  
P: 909.912.0019 | M: 949.648.1650  
ttang@daumcommercial.com  
CADRE # 02237441

### PHOTOS

**DAUM**  
COMMERCIAL REAL ESTATE SERVICES

Although all information is furnished regarding for sale, rental or financing from sources deemed reliable, such information has not been verified and no express representation is made nor is any to be implied as to the accuracy thereof, and it is submitted subject to errors, omissions, changes of price, rental or other conditions, prior sale, lease or financing, or withdrawal without notice. All Maps provided courtesy of Google Maps, Bing Maps, and Google Earth. D/AQ Corp. # 01129558

# FOR LEASE

## ±16,772 SF WAREHOUSE

5455 E. LA PALMA AVE. | UNIT C-2 | ANAHEIM, CA

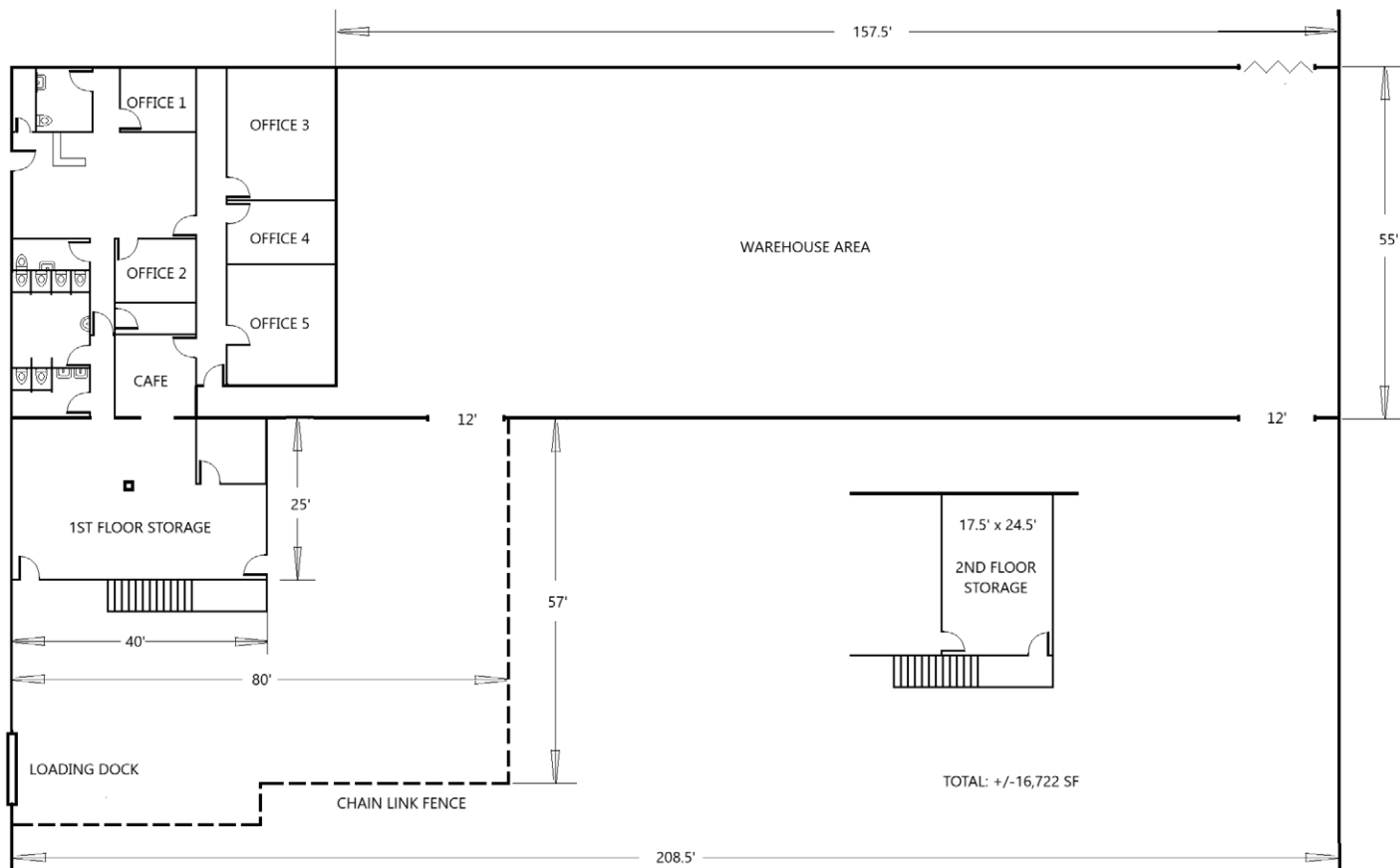

Total Space:	±16,722 SF
Warehouse/Storage:	±13,917 SF
Office:	±2,805 SF
Loading Dock:	1

\*NOT TO SCALE

### FOR MORE INFORMATION, PLEASE CONTACT:

**NOAH SAMARIN**  
 EXECUTIVE VICE PRESIDENT | PRINCIPAL  
 P: 909.912.0007 | M: 714.812.1289  
 noah.samarin@daumcommercial.com  
 CADRE #01755814

**TIM TANG**  
 ASSOCIATE  
 P: 909.912.0019 | M: 949.648.1650  
 ttang@daumcommercial.com  
 CADRE # 02237441

### FLOOR PLAN



Although all information is furnished regarding for sale, rental or financing from sources deemed reliable, such information has not been verified and no express representation is made nor is any to be implied as to the accuracy thereof, and it is submitted subject to errors, omissions, changes of price, rental or other conditions, prior sale, lease or financing, or withdrawal without notice. All Maps provided courtesy of Google Maps, Bing Maps, and Google Earth. D/AQ Corp. # 01129558

# FOR LEASE

## ±16,772 SF WAREHOUSE

5455 E. LA PALMA AVE. | UNIT C-2 | ANAHEIM, CA



FOR MORE INFORMATION, PLEASE CONTACT:

**NOAH SAMARIN**  
EXECUTIVE VICE PRESIDENT | PRINCIPAL  
P: 909.912.0007 | M: 714.812.1289  
noah.samarin@daumcommercial.com  
CADRE #01755814

**TIM TANG**  
ASSOCIATE  
P: 909.912.0019 | M: 949.648.1650  
ttang@daumcommercial.com  
CADRE # 02237441

PHOTO & AERIAL

**DAUM**  
COMMERCIAL REAL ESTATE SERVICES

Although all information is furnished regarding for sale, rental or financing from sources deemed reliable, such information has not been verified and no express representation is made nor is any to be implied as to the accuracy thereof, and it is submitted subject to errors, omissions, changes of price, rental or other conditions, prior sale, lease or financing, or withdrawal without notice. All Maps provided courtesy of Google Maps, Bing Maps, and Google Earth. D/AQ Corp. # 01129558

