



LARGE FENCED YARD

1196

N. GROVE ST., UNIT A
ANAHEIM | CA

7,050 SF FOR LEASE

INDUSTRIAL UNIT

PROPERTY HIGHLIGHTS

- ±1,500 Square Feet of Office Space
- 200 Amps, 120/208V (verify)
- ±4,000 Square Foot Fenced Yard
- 17' Warehouse Clearance
- Part of Larger 15,000 Square Foot Freestanding Building
- Cul-de-sac Location
- 2.5:1 Parking Ratio
- Two (2) Office Restrooms
- Built in 1977, CTU Construction
- One (1) Shop Restroom
- Excellent East Anaheim Location
- Two (2) 12'x14' Ground Level Doors
- Convenient Access to the 91, 57 & 55 Freeways

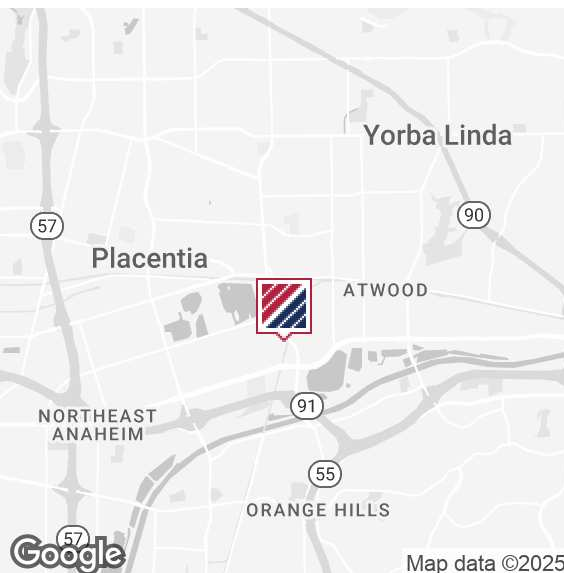

FOR MORE INFORMATION PLEASE CONTACT:

PAUL GINGRICH

EXECUTIVE VICE PRESIDENT

P: 714.941.5333 | M: 949.357.7467

paul.gingrich@daumcommercial.com
CADRE #01299770

CHRIS MIGLIORI

EXECUTIVE VICE PRESIDENT | PRINCIPAL

P: 714.941.5320

chris.migliori@daumcommercial.com
CADRE #00972843

DENNIS HOLT

EXECUTIVE VICE PRESIDENT

P: 949.242.1714 | M: 714.423.0169

dennis.holt@daumcommercial.com
CADRE #01948978

Although all information is furnished regarding for sale, rental or financing is from sources deemed reliable, such information has not been verified and no express representation is made nor is any to be implied as to the accuracy thereof, and it is submitted subject to errors, omissions, changes of price, rental or other conditions, prior sale, lease or financing, or withdrawal without notice.



1196

N. GROVE ST., UNIT A
ANAHEIM | CA

FOR LEASE
7,050 SF INDUSTRIAL UNIT

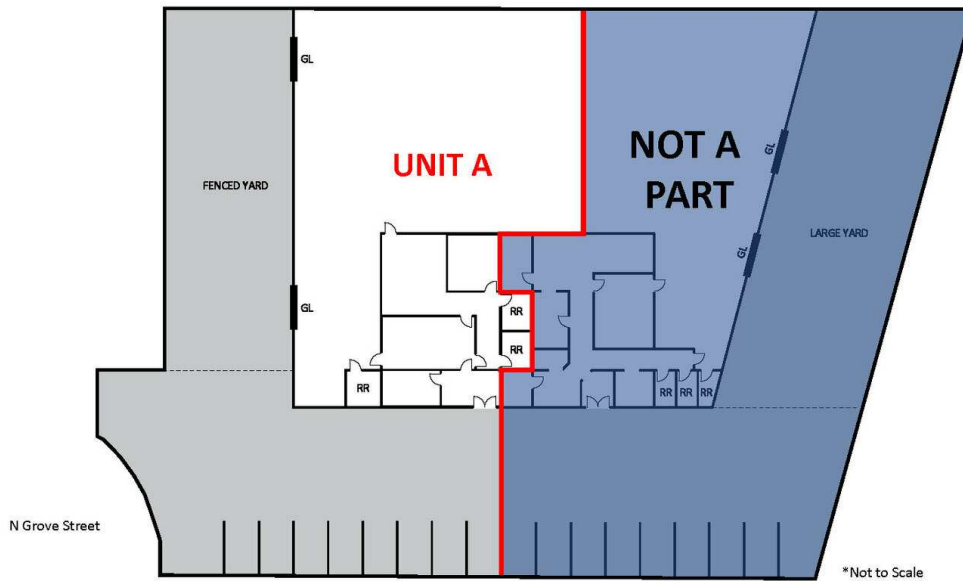

Although all information is furnished regarding for sale, rental or financing is from sources deemed reliable, such information has not been verified and no express representation is made nor is any to be implied as to the accuracy thereof, and it is submitted subject to errors, omissions, changes of price, rental or other conditions, prior sale, lease or financing, or withdrawal without notice.

DAUM
COMMERCIAL REAL ESTATE SERVICES