



±7,947 SF ON A 1.36 ACRES FOR LEASE

1 4 9 4 5 L A P A L M A D R I V E | C H I N O | C A

PROPERTY HIGHLIGHTS

- ±7,947 SF Freestanding Industrial Building
- ±4,700 SF of Deluxe Offices
- 1.36 Acre Lot (59,242 SF)
- Four (4) Office Restrooms
- Two (2) Shop Restrooms
- 18' Warehouse Clearance
- Fully Fire Sprinklered
- 800 Amps 277/480V 3ph4w
- Two (2) Oversized Automatic GL Doors (24'w x 14'h)
- ±1,600 SF Bonus Mezzanine
- Large Concrete Fenced Yard
- Corner Location
- Drive-Thru Lot (2 Gates)
- M2 Industrial Zoned
- Concrete Tilt-Up Construction

FOR MORE INFORMATION, PLEASE CONTACT:

PAUL GINGRICH
EXECUTIVE V.P.
O: 714.941.5333
M: 949.357.7467
pgingrich@daumcre.com
CADRE: 01299770

DENNIS HOLT
VICE PRESIDENT
O: 714.941.5333
M: 949.242.1714
dholt@daumcre.com
CADRE: 01948978

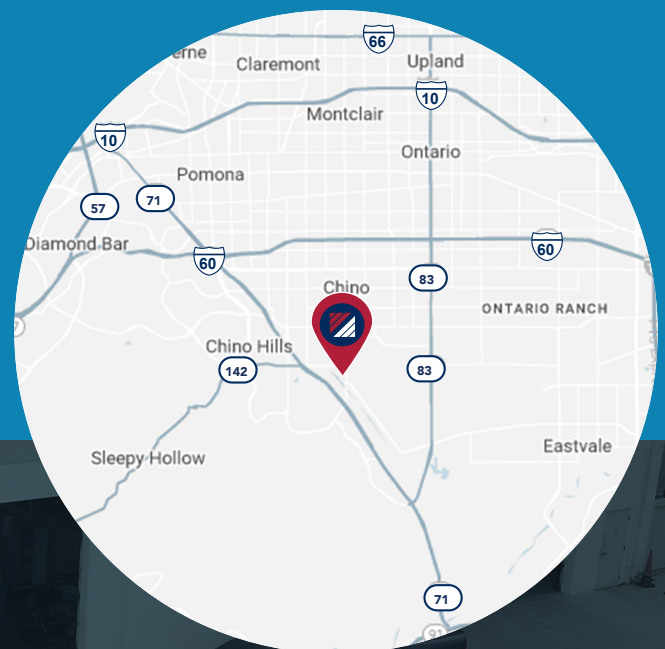

Although all information is furnished regarding for sale, rental or financing is from sources deemed reliable, such information has not been verified and no express representation is made nor is any to be implied as to the accuracy thereof, and it is submitted subject to errors, omissions, changes of price, rental or other conditions, prior sale, lease or financing, or withdrawal without notice. D/AQ Corp. # 01129558

DAUM
COMMERCIAL REAL ESTATE SERVICES

±7,947 SF ON 1.36 ACRES

14945 LA PALMA DRIVE | CHINO | CA | FOR LEASE

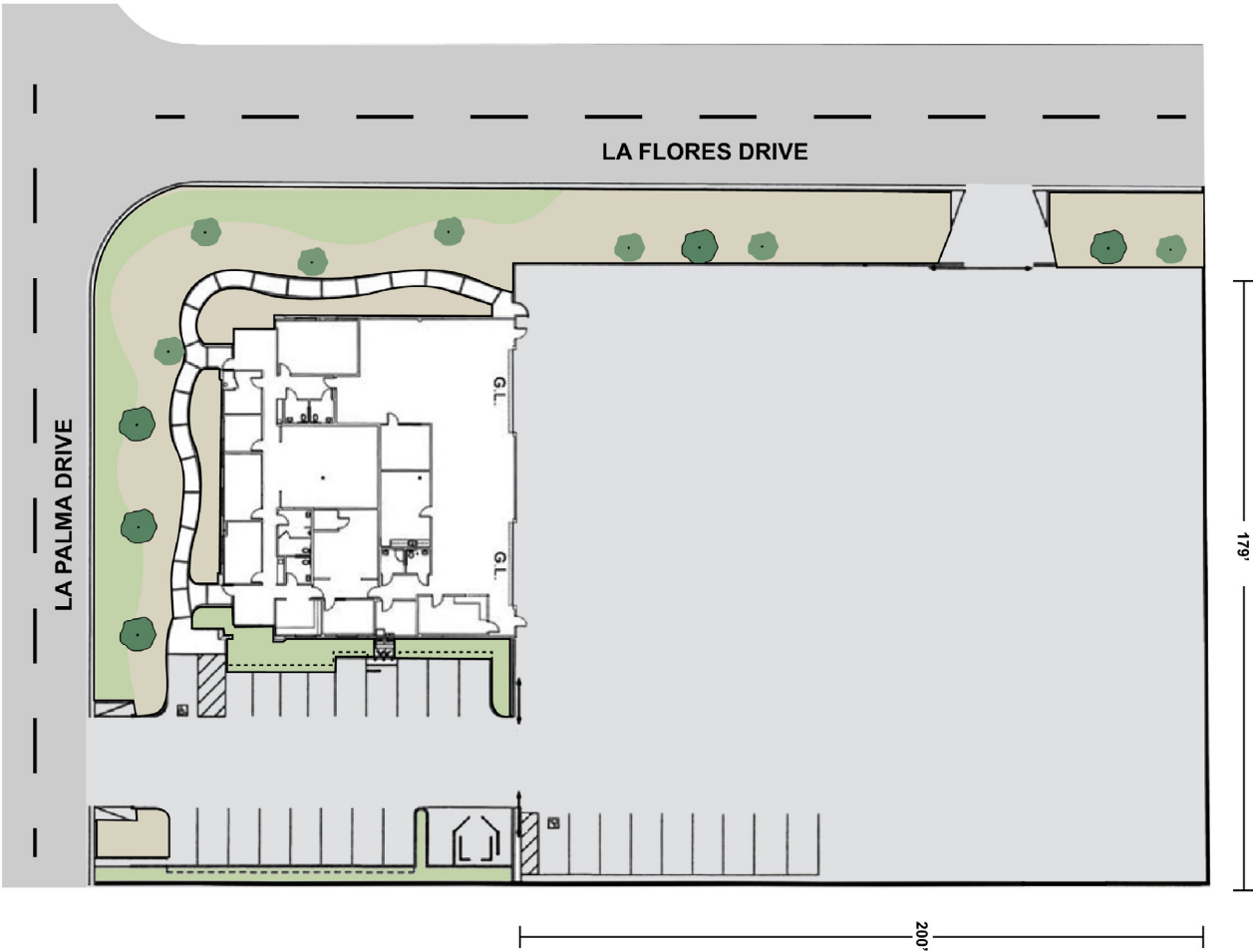

Although all information is furnished regarding for sale, rental or financing is from sources deemed reliable, such information has not been verified and no express representation is made nor is any to be implied as to the accuracy thereof, and it is submitted subject to errors, omissions, changes of price, rental or other conditions, prior sale, lease or financing, or withdrawal without notice. D/AQ Corp. # 01129558

DAUM COMMERCIAL REAL ESTATE SERVICES | 4400 MACARTHUR BLVD, #950 | NEWPORT BEACH, CA | 92660

DAUM
COMMERCIAL REAL ESTATE SERVICES

±7,947 SF ON 1.36 ACRES

14945 LA PALMA DRIVE | CHINO | CA | FOR LEASE



Although all information is furnished regarding for sale, rental or financing is from sources deemed reliable, such information has not been verified and no express representation is made nor is any to be implied as to the accuracy thereof, and it is submitted subject to errors, omissions, changes of price, rental or other conditions, prior sale, lease or financing, or withdrawal without notice. D/AQ Corp. # 01129558

DAUM COMMERCIAL REAL ESTATE SERVICES | 4400 MACARTHUR BLVD, #950 | NEWPORT BEACH, CA | 92660

DAUM
COMMERCIAL REAL ESTATE SERVICES

±7,947 SF ON 1.36 ACRES

14945 LA PALMA DRIVE | CHINO | CA | FOR LEASE



Although all information is furnished regarding for sale, rental or financing is from sources deemed reliable, such information has not been verified and no express representation is made nor is any to be implied as to the accuracy thereof, and it is submitted subject to errors, omissions, changes of price, rental or other conditions, prior sale, lease or financing, or withdrawal without notice. D/AQ Corp. # 01129558

DAUM COMMERCIAL REAL ESTATE SERVICES | 4400 MACARTHUR BLVD, #950 | NEWPORT BEACH, CA | 92660

DAUM
COMMERCIAL REAL ESTATE SERVICES

±7,947 SF ON 1.36 ACRES

14945 LA PALMA DRIVE | CHINO | CA | FOR LEASE

CORPORATE NEIGHBORS

- Spectrum
- Target
- Kaiser Permanente
- Adelco
- Quest Diagnostics
- Petco
- Navy Exchange
- Walmart Distribution Center
- Brenntag
- Olive Garden
- Kohl's
- Amazon Logistics



Corporate neighbors callout 1:

- PARTY KINGDOM
- petco
- TARGET
- Spectrum
- DICK'S SPORTING GOODS
- KAISER PERMANENTE
- adelco
- Quest Diagnostics

SUBJECT PROPERTY

Corporate neighbors callout 2:

- PELICAN
- NFI
- Walmart Distribution Center
- amazonlogistics
- RNDC

Corporate neighbors callout 3:

- amcor
- Walmart
- Olive Garden ITALIAN KITCHEN
- NEX Navy Exchange
- CDC CALIFORNIA DISTRIBUTION CENTER
- THE HOME DEPOT
- BRENNTAG
- KOHL'S
- SAM'S CLUB

Although all information is furnished regarding for sale, rental or financing is from sources deemed reliable, such information has not been verified and no express representation is made nor is any to be implied as to the accuracy thereof, and it is submitted subject to errors, omissions, changes of price, rental or other conditions, prior sale, lease or financing, or withdrawal without notice. D/AQ Corp. # 01129558

