



FOR LEASE

±8,050 SF | FREESTANDING INDUSTRIAL

8311 STANDUSTRIAL STREET | STANTON | CA



±8,050 SF
BUILDING SIZE



3
GROUND LEVEL
DOORS



14'-16'
CEILING CLEAR
HEIGHT



RECENTLY
REFURBISHED



SMALL PRIVATE
GATED YARD



400 AMPS
3 PHASE, 480V

FOR MORE INFORMATION, CONTACT:



NATE ORTEGA

P: 562.544.8258 | M: 562.544.8258
E: nortega@daumcre.com
CA DRE #01989242



MIKE BARREIRO, SIOR

P: 949.242.1706
E: mbarreiro@daumcre.com
CA DRE #01989242



DEVIN RAY

P: 949.242.1065
E: devin.ray@daumcommercial.com
CA DRE #02018130

PROPERTY HIGHLIGHTS:

- Bonus Enclosed Outdoor Storage (297 SF)
- Distributed power and air lines
- Gas-served building
- Private, fenced yard area (with more possible)
- Desirable industrial area of Stanton
- Close Proximity to 91, 22, and 5 Freeways

Although all information is furnished regarding for sale, rental or financing from sources deemed reliable, such information has not been verified and no express representation is made nor is any to be implied as to the accuracy thereof, and it is submitted subject to errors, omissions, changes of price, rental or other conditions, prior sale, lease or financing, or withdrawal without notice. D/AQ Corp. # 01129558



NATE ORTEGA

P: 562.544.8258 | M: 562.544.8258
E: nortega@daumcre.com
CA DRE #01989242



DEVIN RAY

P: 949.242.1065
E: dray@daumcre.com
CA DRE # 02018130



MIKE BARREIRO

P: 949.242.1706
E: mbarreiro@daumcre.com
CA DRE #01712620



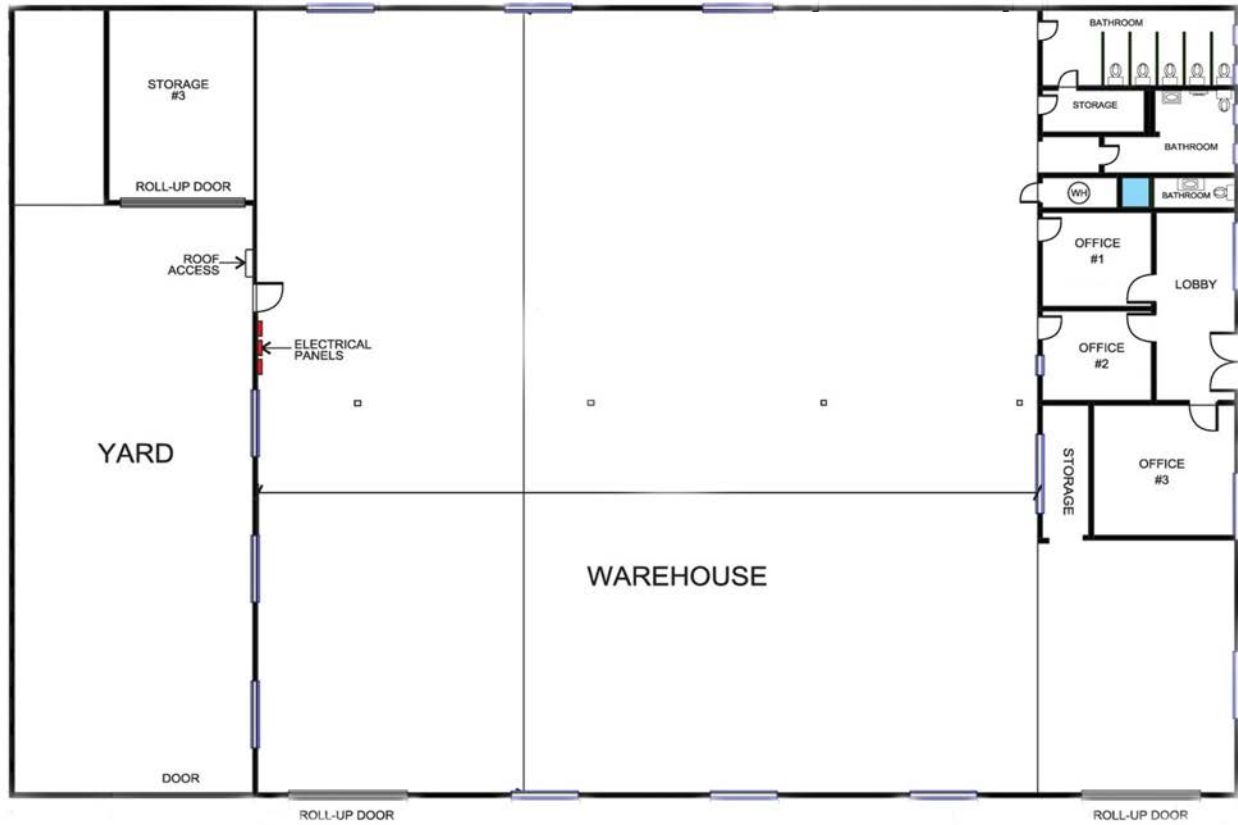

*NOT TO SCALE

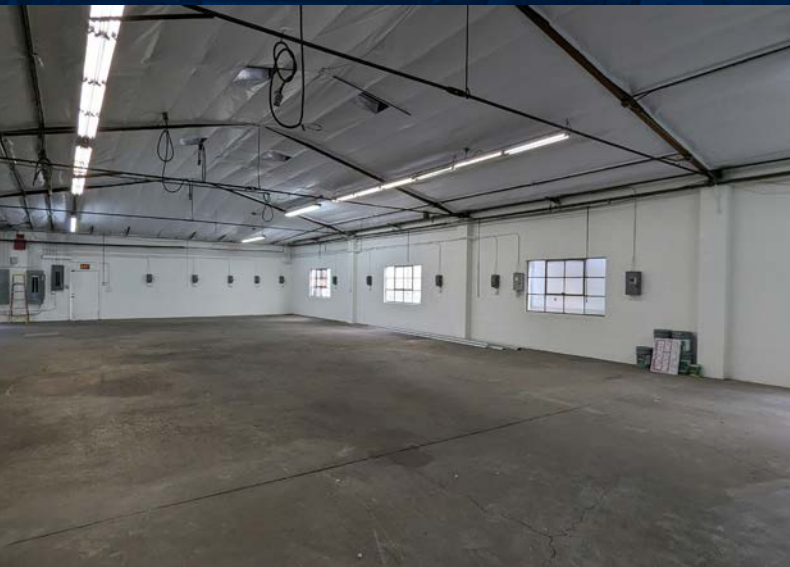

NATE ORTEGA

P: 562.544.8258 | M: 562.544.8258
 E: nortega@daumcre.com
 CA DRE #01989242



DEVIN RAY

P: 949.242.1065
 E: dray@daumcre.com
 CA DRE # 02018130



MIKE BARREIRO

P: 949.242.1706
 E: mbarreiro@daumcre.com
 CA DRE #01712620

