

INDUSTRIAL WAREHOUSE

**±22,778 SF
INDUSTRIAL BUILDING
FOR LEASE**

1137 W. BRADFORD CIR. | CORONA, CA

FOR MORE INFORMATION, PLEASE CONTACT:

KEVIN FREJLACH

Vice President

P: 909.912.0005 | M: 909.225.5592

kfrejlach@daumcommercial.com

CADRE #01210292

**DAUM**
COMMERCIAL REAL ESTATE SERVICES

Although all information is furnished regarding for sale, rental or financing is from sources deemed reliable, such information has not been verified and no express representation is made nor is any to be implied as to the accuracy thereof, and it is submitted subject to errors, omissions, changes of price, rental or other conditions, prior sale, lease or financing, or withdrawal without notice. D/AQ Corp. # 01129558

INDUSTRIAL WAREHOUSE

**22,778 SF
FOR LEASE**
1137 W. BRADFORD CIR.
CORONA | CA

PROPERTY FEATURES

- ±1.22 Acre Site / Corner Location
- Large Drive Around Yard
- ±3,056 SF of 2-Story Office
- SP81 - 1 Zoning
- Two (2) Position True DH Doors
- One (1) GL Doors
- 24' Clear Height
- 800 Amp, 277/480 Volt Service
- Fully Sprinklered
- Forty-Five (45) Car Parking
- Existing Air Supply Lines
- Two (2) Shop Restrooms

FOR MORE INFORMATION, PLEASE CONTACT:

KEVIN FREJLACH

Vice President

P: 909.912.0005 | M: 909.225.5592

kfrejlach@daumcommercial.com

CADRE #01210292



Although all information is furnished regarding for sale, rental or financing is from sources deemed reliable, such information has not been verified and no express representation is made nor is any to be implied as to the accuracy thereof, and it is submitted subject to errors, omissions, changes of price, rental or other conditions, prior sale, lease or financing, or withdrawal without notice. D/AQ Corp. # 01129558

DAUM
COMMERCIAL REAL ESTATE SERVICES

INDUSTRIAL WAREHOUSE

**22,778 SF
FOR LEASE**
1137 W. BRADFORD CIR.
CORONA | CA

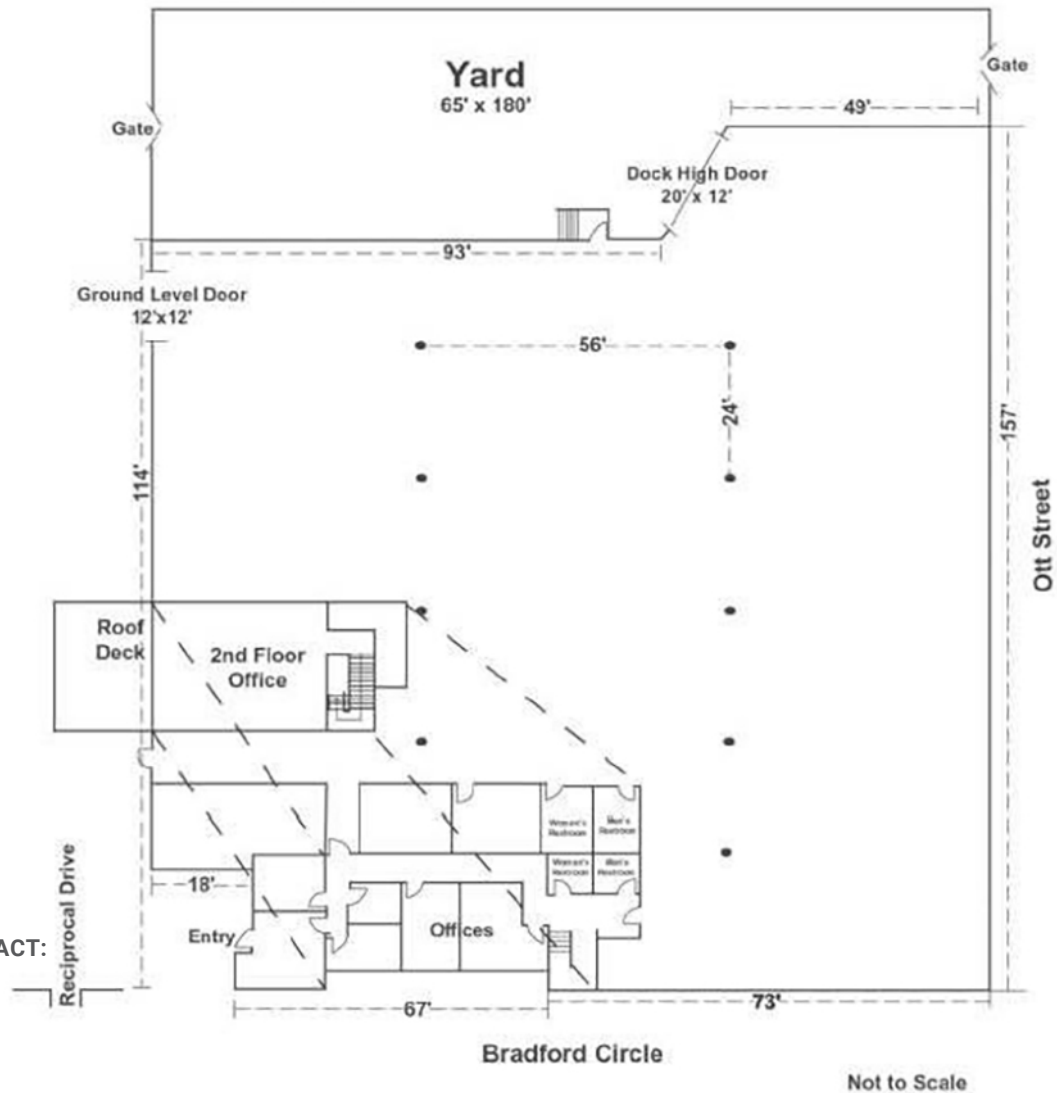

FOR MORE INFORMATION, PLEASE CONTACT:

KEVIN FREJLACH
Vice President
P: 909.912.0005 | M: 909.225.5592
kfrejlach@daumcommercial.com
CADRE #01210292

Although all information is furnished regarding for sale, rental or financing is from sources deemed reliable, such information has not been verified and no express representation is made nor is any to be implied as to the accuracy thereof, and it is submitted subject to errors, omissions, changes of price, rental or other conditions, prior sale, lease or financing, or withdrawal without notice. D/AQ Corp. # 01129558

INDUSTRIAL WAREHOUSE

22,778 SF
FOR LEASE
1137 W. BRADFORD CIR.
CORONA | CA









Although all information is furnished regarding for sale, rental or financing is from sources deemed reliable, such information has not been verified and no express representation is made nor is any to be implied as to the accuracy thereof, and it is submitted subject to errors, omissions, changes of price, rental or other conditions, prior sale, lease or financing, or withdrawal without notice. D/AQ Corp. # 01129558

DAUM
COMMERCIAL REAL ESTATE SERVICES

INDUSTRIAL WAREHOUSE

**22,778 SF
FOR LEASE
1137 W. BRADFORD CIR.
CORONA | CA**

Key Distances

-  91 Freeway
0.3 miles
-  15 Freeway
2.3 miles
-  Ontario Airport
17.1 miles
-  SBD Airport
28.1 miles
-  LAX
55.2 miles
-  Port of Long Beach
48.3 miles
-  Port of Los Angeles
49.7 miles

Demographic

POPULATION	3 MILE RADIUS
2023	116,981
2028 Projection	116,219

INCOME	3 MILE RADIUS
Average Household Income	\$109,113



Although all information is furnished regarding for sale, rental or financing is from sources deemed reliable, such information has not been verified and no express representation is made nor is any to be implied as to the accuracy thereof, and it is submitted subject to errors, omissions, changes of price, rental or other conditions, prior sale, lease or financing, or withdrawal without notice. D/AQ Corp. # 01129558



22,778 SF
FOR LEASE

1137 W. BRADFORD CIR.
CORONA | CA



SUBJECT
PROPERTY

SILVERCREST

ZUMIEZ
DISTRIBUTION
CENTER

STARDECK
INDUSTRIES

R & J FABRI-
CATORS

COLUMBIA
ALUMINUM
PROD.

TALCO
PLASTICS

RAILROAD ST.

N. LINCOLN AVE.

Westlake
Royal Roofing Solutions™

WHITE CAP
DISTRIBUTION
CENTER

ADS

DOLLAR
SELF
STORAGE

UM

RAILROAD ST.

FRANCHERE
FABRICATION

BRADFORD CIR.

LESSO

WEST COAST
WOODSIDE CONTRACTORS

RODSAL BUILDERS

SPREEN
HONDA
CORONA

PUBLIC STOR-
AGE

91

91

FOR MORE INFORMATION, PLEASE CONTACT:

KEVIN FREJLACH
Vice President
P: 909.912.0005 | M: 909.225.5592
kfrejlach@daumcommercial.com
CADRE #01210292

Although all information is furnished regarding for sale, rental or financing is from sources deemed reliable, such information has not been verified and no express representation is made nor is any to be implied as to the accuracy thereof, and it is submitted subject to errors, omissions, changes of price, rental or other conditions, prior sale, lease or financing, or withdrawal without notice. D/AQ Corp. # 01129558

DAUM
COMMERCIAL REAL ESTATE SERVICES