

Prime Industrial Land | For Lease  
AVAILABLE IMMEDIATELY



# 12801 MAGNOLIA AVE

RIVERSIDE | CA

1.44 ACRE INDUSTRIAL LAND FOR LEASE



## PROPERTY HIGHLIGHTS

- Unincorporated Riverside County
- 1.44 Acre Site
- New 8" Concrete Paving
- New 1,000 SF Modular Office/Restroom Facility Being Fabricated For Installation
- 100,000 Pound Scale On-Site
- Zoning MSC - Manufacturing-Service Commercial
- Multiple Outside Storage Uses Permissible

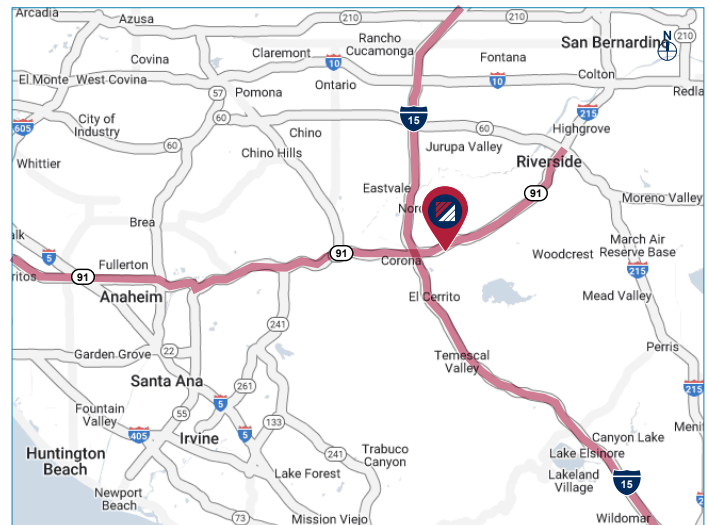

## CONTACT US

### NOAH SAMARIN

Executive Vice President / Principal  
C: 714.812.1289  
noah.samarin@daumcommercial.com  
CADRE #01755814

### DUSTIN HULLINGER

Associate Vice President  
P: 949.341.4514  
dustin.hullinger@daumcommercial.com  
CADRE #02078021

### MICHAEL COLLINS

Vice Chairman  
P: 949.341.4510  
michael.collins@daumcommercial.com  
CADRE #00463740

D/AQ Corp. #01129558. Maps Courtesy ©Google & ©Microsoft. Although all information is furnished regarding for sale, rental or financing is from sources deemed reliable, such information has not been verified and no express representation is made nor is any to be implied as to the accuracy thereof, and it is submitted subject to errors, omissions, changes of price, rental or other conditions, prior sale, lease or financing, or withdrawal without notice.

Prime Industrial Land | For Lease

Prime Industrial Land | For Lease

# 12801 MAGNOLIA AVE

RIVERSIDE | CA

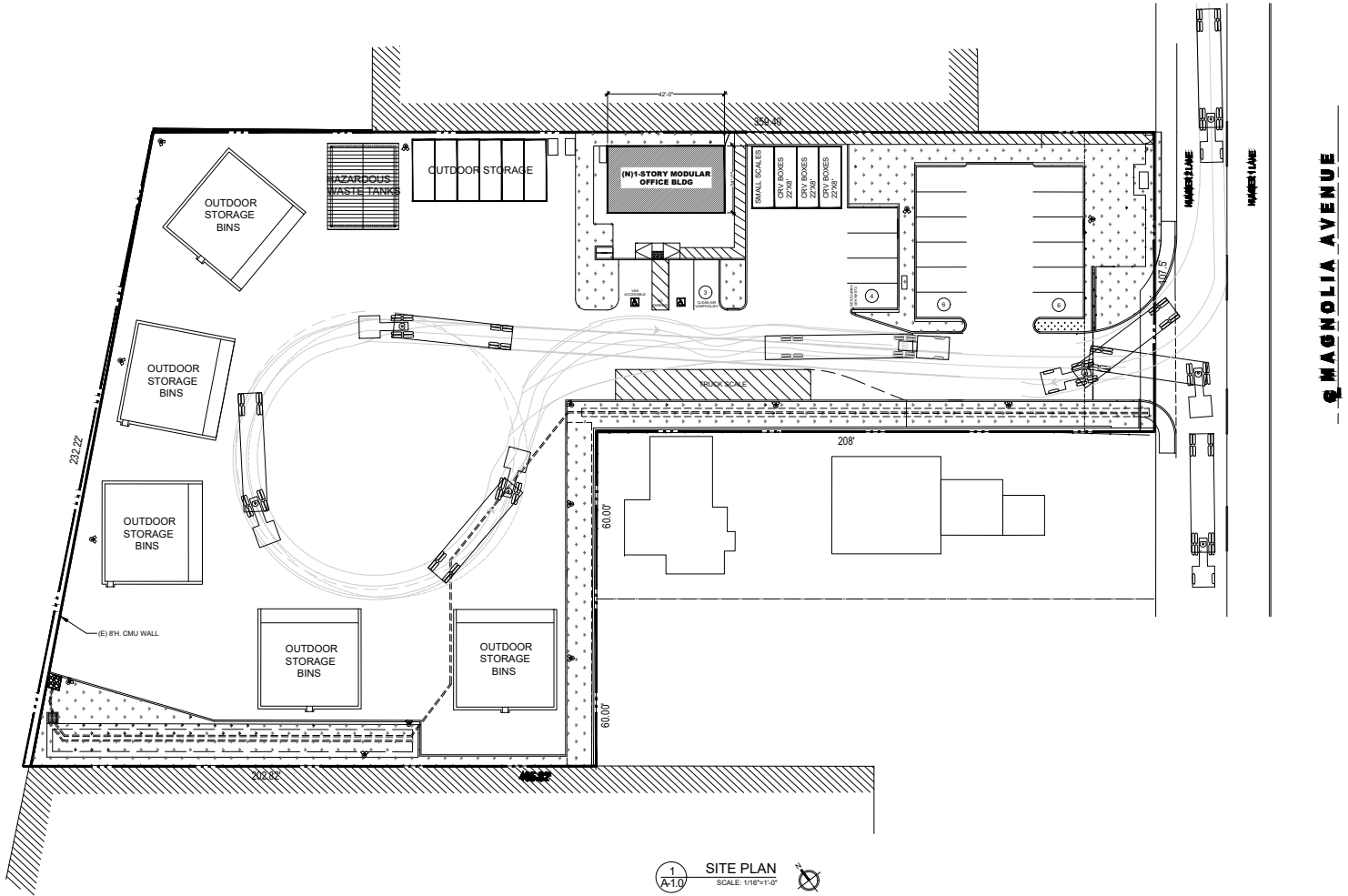

\*NOT TO SCALE

## CONTACT US

### NOAH SAMARIN

Executive Vice President / Principal  
C: 714.812.1289  
noah.samarin@daumcommercial.com  
CADRE #01755814

### DUSTIN HULLINGER

Associate Vice President  
P: 949.341.4514  
dustin.hullinger@daumcommercial.com  
CADRE #02078021

### MICHAEL COLLINS

Vice Chairman  
P: 949.341.4510  
michael.collins@daumcommercial.com  
CADRE #00463740

D/AQ Corp. #01129558. Maps Courtesy ©Google & ©Microsoft. Although all information is furnished regarding for sale, rental or financing is from sources deemed reliable, such information has not been verified and no express representation is made nor is any to be implied as to the accuracy thereof, and it is submitted subject to errors, omissions, changes of price, rental or other conditions, prior sale, lease or financing, or withdrawal without notice.

Prime Industrial Land | For Lease

Prime Industrial Land | For Lease

# 12801 MAGNOLIA AVE

RIVERSIDE | CA



## CONTACT US

### NOAH SAMARIN

Executive Vice President / Principal  
C: 714.812.1289  
noah.samarin@daumcommercial.com  
CADRE #01755814

### DUSTIN HULLINGER

Associate Vice President  
P: 949.341.4514  
dustin.hullinger@daumcommercial.com  
CADRE #02078021

### MICHAEL COLLINS

Vice Chairman  
P: 949.341.4510  
michael.collins@daumcommercial.com  
CADRE #00463740

D/AQ Corp. #01129558. Maps Courtesy ©Google & ©Microsoft. Although all information is furnished regarding for sale, rental or financing is from sources deemed reliable, such information has not been verified and no express representation is made nor is any to be implied as to the accuracy thereof, and it is submitted subject to errors, omissions, changes of price, rental or other conditions, prior sale, lease or financing, or withdrawal without notice.

Prime Industrial Land | For Lease