



±6,000 SF INDUSTRIAL UNIT
FOR LEASE 15422 ELECTRONIC LANE,
 HUNTINGTON BEACH | CA

-  ±1,500 SF OFFICE SPACE
-  P.O.L. 45,000 SF BUILDING
-  RETAIL AMENITIES NEARBY
-  405 FWY ACCESS

FOR MORE INFORMATION, CONTACT US:

MIKE BARREIRO
 E.V.P. | PRINCIPAL
 P: 949.355.8500
 mbarreiro@daumcre.com
 CA DRE License #01712620



DEVIN RAY
 VICE PRESIDENT
 M: 714.322.1252
 dray@daumcre.com
 CA DRE License #02018130



DOUGLAS A. CLAMAN
 FOUNDER & MANAGING PRINCIPAL
 P: 424.288.7072
 daclaman@jaadpartners.com
 CA DRE License #01871655





D/AQ Corp. #01129558. Maps Courtesy ©Google & ©Microsoft. Although all information is furnished regarding for sale, rental or financing from sources deemed reliable, such information has not been verified and no express representation is made nor is any to be implied as to the accuracy thereof, and it is submitted subject to errors, omissions, changes of price, rental or other conditions, prior sale, lease or financing, or withdrawal without notice.

FOR LEASE: 6,000 SF INDUSTRIAL UNIT

±6,000 SF
INDUSTRIAL
UNIT

15422 ELECTRONIC LANE
HUNTINGTON BEACH | CA

FOR LEASE

PROPERTY HIGHLIGHTS

- 6,000 SF Industrial Unit
- Approximately 1,500 SF Office
- Office Restroom
- Shop Restroom
- 15'-16' Warehouse Clear Height
- 200 amps (120/208v) * Verify
- One (1) GL Door (12w x 14h)
- POL 45,000 SF Industrial Park
- Professionally managed business park
- Ample Parking
- Additional Office Units Available for Lease

Suite 201 - 6,250 SF

Suite 205 - 3,382 SF

DAUM
COMMERCIAL REAL ESTATE SERVICES

ELECTRONIC LANE

Google



±6,000 SF
INDUSTRIAL
UNIT

15422 ELECTRONIC LANE
HUNTINGTON BEACH | CA

FOR LEASE



FOR MORE INFORMATION, CONTACT US:



MIKE BARREIRO
E.V.P. | PRINCIPAL
P: 949.355.8500
mbarreiro@daumcre.com
CA DRE License #01712620



DEVIN RAY
VICE PRESIDENT
M: 714.322.1252
dray@daumcre.com
CA DRE License #02018130



DOUGLAS A. CLAMAN
FOUNDER & MANAGING PRINCIPAL
P: 424.288.7072
daclaman@jaadpartners.com
CA DRE License #01871655



DAUM
COMMERCIAL REAL ESTATE SERVICES

D/AQ Corp. #01129558. Maps Courtesy ©Google & ©Microsoft. Although all information is furnished regarding for sale, rental or financing from sources deemed reliable, such information has not been verified and no express representation is made nor is any to be implied as to the accuracy thereof, and it is submitted subject to errors, omissions, changes of price, rental or other conditions, prior sale, lease or financing, or withdrawal without notice.

±6,000 SF
INDUSTRIAL
UNIT

FLOOR PLAN

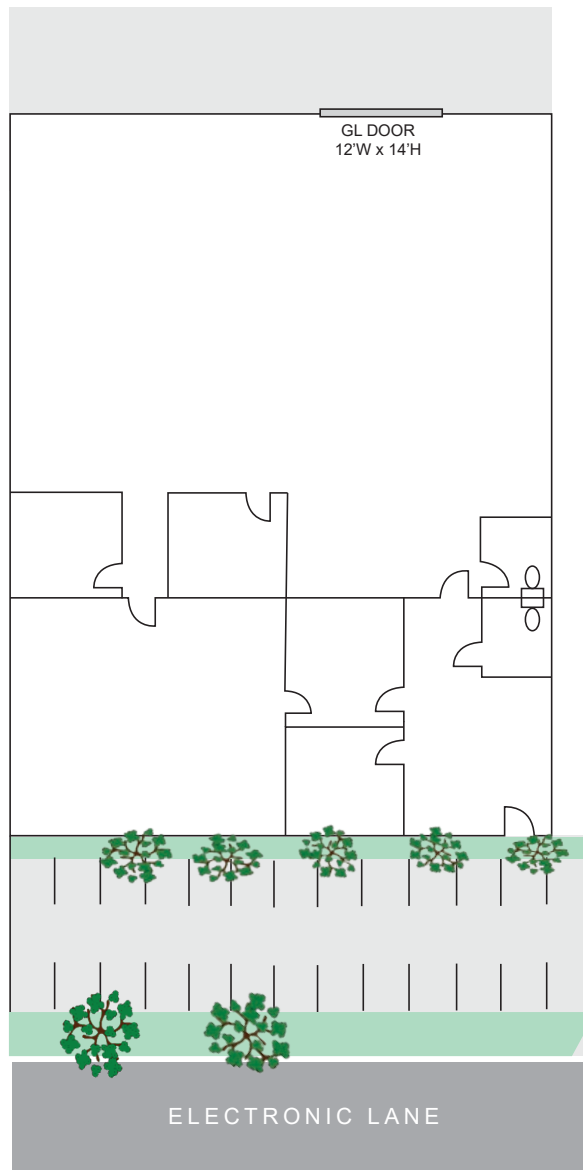

15422 ELECTRONIC LANE
HUNTINGTON BEACH | CA

FOR LEASE

FOR MORE INFORMATION, CONTACT US:



MIKE BARREIRO
E.V.P. | PRINCIPAL
P: 949.355.8500
mbarreiro@daumcre.com
CA DRE License #01712620



DEVIN RAY
VICE PRESIDENT
M: 714.322.1252
dray@daumcre.com
CA DRE License #02018130



DOUGLAS A. CLAMAN
FOUNDER & MANAGING PRINCIPAL
P: 424.288.7072
daclaman@jaadpartners.com
CA DRE License #01871655



DAUM
COMMERCIAL REAL ESTATE SERVICES

±6,000 SF
INDUSTRIAL
UNIT

SITE PLAN

15422 ELECTRONIC LANE
HUNTINGTON BEACH | CA

FOR LEASE

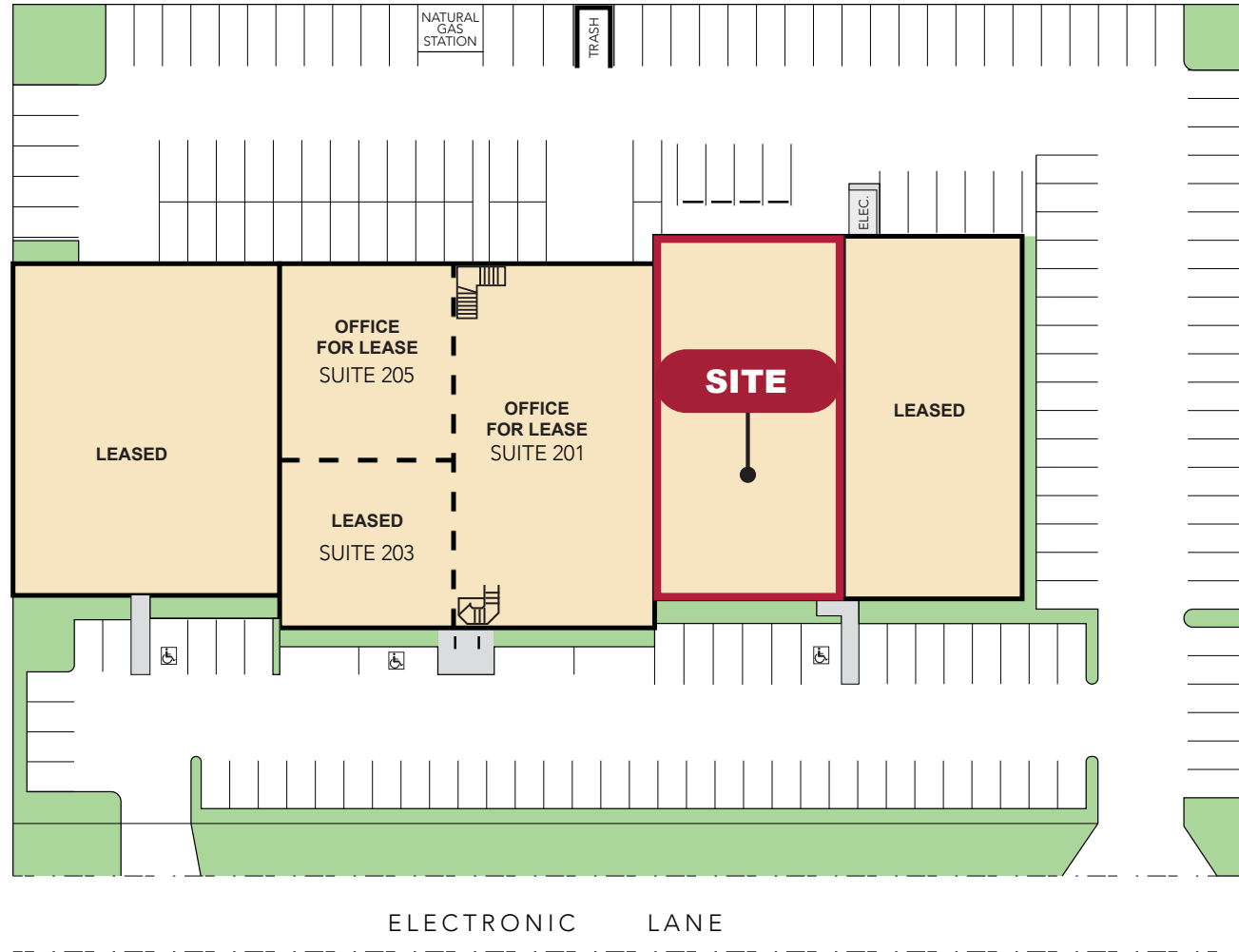

FOR MORE INFORMATION, CONTACT US:



MIKE BARREIRO
E.V.P. | PRINCIPAL
P: 949.355.8500
mbarreiro@daumcre.com
CA DRE License #01712620



DEVIN RAY
VICE PRESIDENT
M: 714.322.1252
dray@daumcre.com
CA DRE License #02018130



DOUGLAS A. CLAMAN
FOUNDER & MANAGING PRINCIPAL
P: 424.288.7072
daclaman@jaadpartners.com
CA DRE License #01871655



±6,000 SF
INDUSTRIAL
UNIT

15422 ELECTRONIC LANE
HUNTINGTON BEACH | CA

FOR LEASE



FOR MORE INFORMATION, CONTACT US:



MIKE BARREIRO
E.V.P. | PRINCIPAL
P: 949.355.8500
mbarreiro@daumcre.com
CA DRE License #01712620



DEVIN RAY
VICE PRESIDENT
M: 714.322.1252
dray@daumcre.com
CA DRE License #02018130



DOUGLAS A. CLAMAN
FOUNDER & MANAGING PRINCIPAL
P: 424.288.7072
daclaman@jaadpartners.com
CA DRE License #01871655



DAUM
COMMERCIAL REAL ESTATE SERVICES