

COMPTON 1810 S. CALIFORNIA  
Santa Fe Ave.



± 46,980 SF FREE-STANDING BUILDING FOR SALE

EXCLUSIVE LISTING AGENTS

DAVID FREITAG  
P: 213.270.2235 | M: 310.413.9390  
E: dfreitag@daumcre.com  
CA License #00855673

BRIAN JORGE  
D: 310.538.6702  
E: bjorge@daumcre.com  
CA License #01947601

JEFF JORGE  
D: 310.538.6703  
E: jjorge@daumcre.com  
CA License #01947947

KRIS COONTZ  
D: 213.270.2231 | M: 626.660.5514  
E: kcoontz@daumcre.com  
CA License #02216169

WWW.THELAININDUSTRIAL.COM

**DAUM**  
COMMERCIAL REAL ESTATE SERVICES



COMPTON 1810 S. CALIFORNIA  
**Santa Fe Ave.**



## About the Property



**Prime Alameda Corridor  
Location**



**MH Zoning Heavy**



**Metal Industrial Warehouse**



**Twelve Miles from Ports**



**Excellent Access to Major  
Freeways 91, 710, 110, and 405**



**Development Opportunity**



COMPTON 1810 S. CALIFORNIA  
**Santa Fe Ave.**

### Offering Price

Asking Sale Price: \$9,325,000

PSF: \$104.99 Land | \$198.49 BLDG.

### Property Highlights



±46,980 Available SF



± 2.04 AC  
± 88,819 SF



1952 Year Built



To Be Verified



Metal Construction



16' Clear Height



APN: 7318-004-021



To Be Verified



PROPERTY INFORMATION

# 1810 S. Santa Fe Ave.

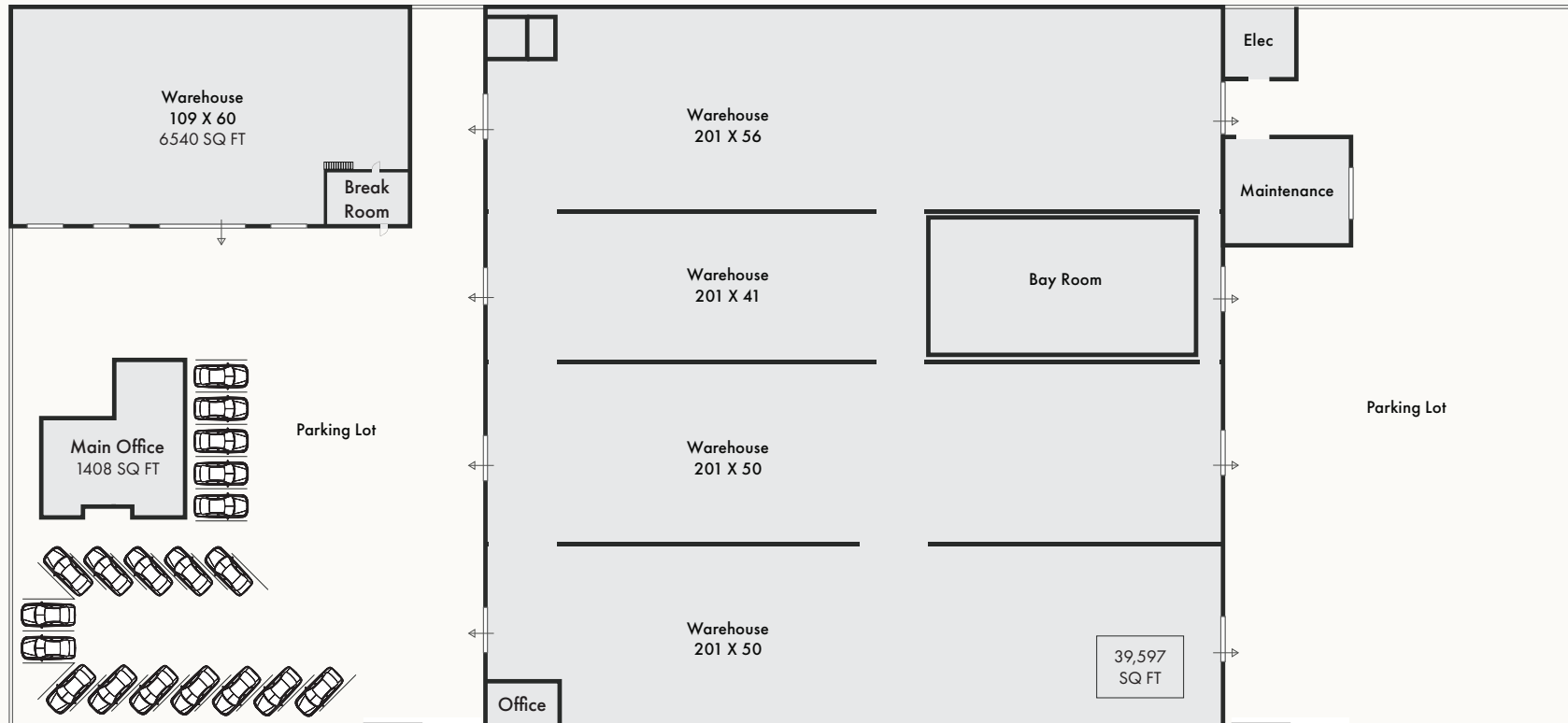

SANTA FE AVE.

NOT TO SCALE\*

COMPTON | CALIFORNIA



# AMENITIES + TRAFFIC COUNT

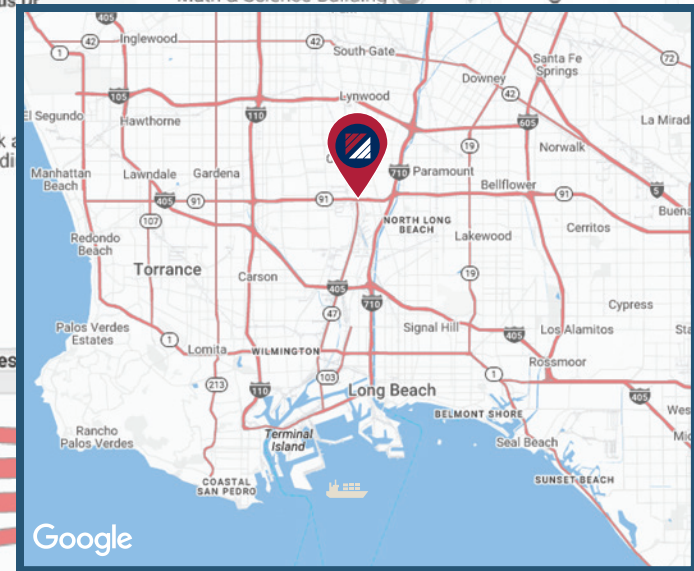
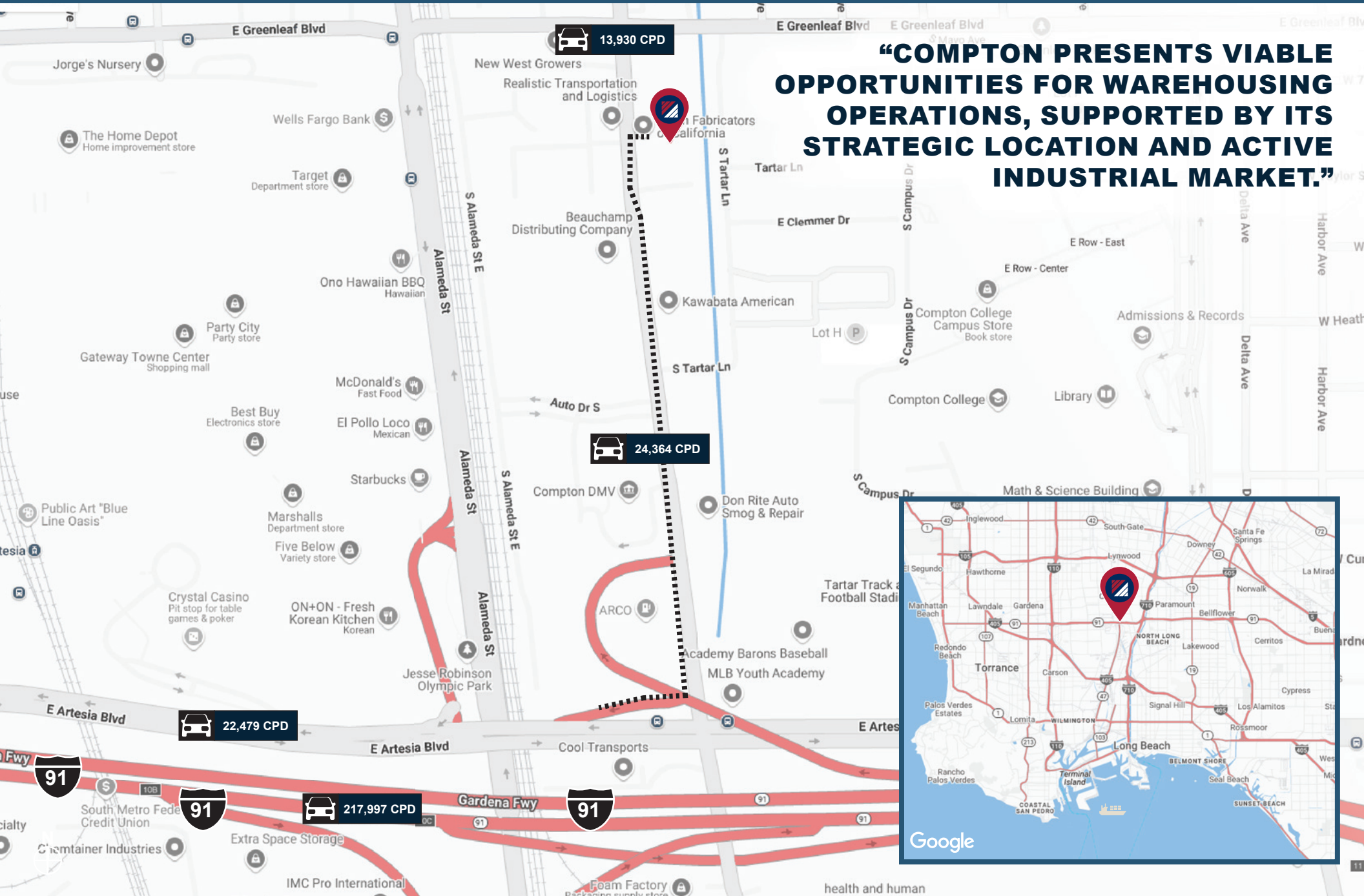



# LOCATION



**EXCELLENT  
ACCESS  
TO MAJOR  
FREEWAYS 91,  
710, 110, AND 405**



**17 MILES FROM  
DOWNTOWN  
LOS ANGELES**



**LONG BEACH AIRPORT  
13 MIN | 7.7 MI**

**LOS ANGELES  
INTERNATIONAL AIRPORT  
23 MIN | 15.6 MI**



**ARTESIA STATION (BLUE LINE - LOS  
ANGELES COUNTY METROPOLITAN  
TRANSPORTATION AUTHORITY  
(METRO))  
3 MIN | 17 MIN | 0.8 MI**



COMPTON 1810 S. CALIFORNIA  
**Santa Fe Ave.**

**S. SANTA FE AVE.**



COMPTON 1810 S. CALIFORNIA  
**Santa Fe Ave.**

**EXCLUSIVE LISTING AGENTS**

**DAVID FREITAG**  
P: 213.270.2235 | M: 310.413.9390  
E: [dfreitag@daumcre.com](mailto:dfreitag@daumcre.com)  
CA License #00855673

**BRIAN JORGE**  
D: 310.538.6702  
E: [bjorge@daumcre.com](mailto:bjorge@daumcre.com)  
CA License #01947601

**JEFF JORGE**  
D: 310.538.6703  
E: [jjorge@daumcre.com](mailto:jjorge@daumcre.com)  
CA License #01947947

**KRIS COONTZ**  
D: 213.270.2231 | M: 626.660.5514  
E: [kcoontz@daumcre.com](mailto:kcoontz@daumcre.com)  
CA License #02216169

D/AQ Corp. #01129558. Maps Courtesy @Google & @Microsoft. Although all information is furnished regarding for sale, rental or financing is from sources deemed reliable, such information has not been verified and no express representation is made nor is any to be implied as to the accuracy thereof, and it is submitted subject to errors, omissions, changes of price, rental or other conditions, prior sale, lease or financing, or withdrawal without notice.