



**FRUITLAND AVE**

# 20,890 SF INDUSTRIAL LAND 0.48 ACRES FOR SALE

VACANT & READY FOR USE

**3580 FRUITLAND AVE.**  
**MAYWOOD | CA**

FOR MORE INFORMATION, PLEASE CONTACT:

**BRYAN ABAYAN**  
Associate Vice President  
P: 310.883.8476  
babayan@daumcre.com  
CA License # 02005294

**SEAN HOMSY**  
Associate Vice President  
P: 213.270.2237  
shomsy@daumcre.com  
CA License # 02157447

## PROPERTY HIGHLIGHTS



**0.48 ACRES**  
**LOT SIZE**



**INDUSTRIAL LAND IN**  
**VERNON SUBMARKET**



**M1\***  
**ZONING**

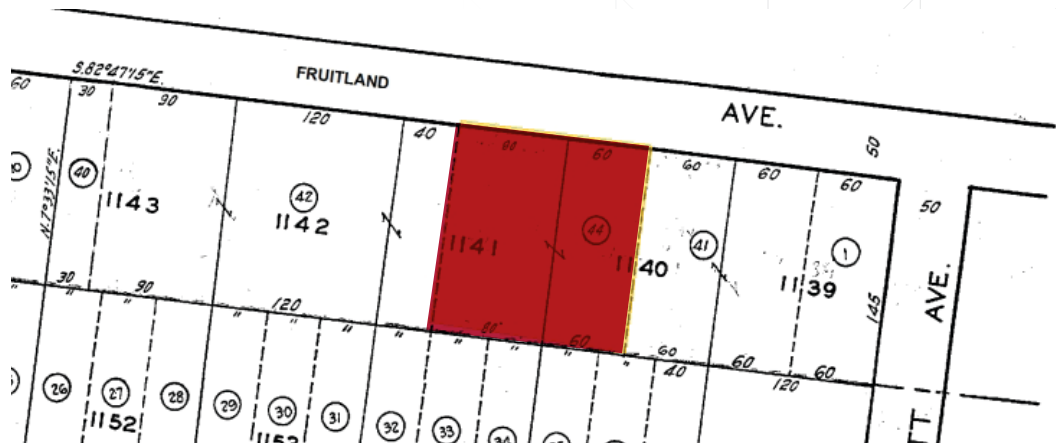

## PROPERTY HIGHLIGHTS

- 20,890 SF Industrial Land (0.48 Acres)
- Zoned M1 – Allows Truck and Storage Use By Right
- Vacant & Ready for Use – No Buildings on Site, Open Land For Flexible Use
- Three Curb Cuts & Large Yard – Easy Access for Trucks, Equipment, or Storage

- Located in The City of Maywood, an Industrial Area with Easy Access to Major Distribution Hubs
- Adjacent to Vernon – Located in a Strong Industrial Area
- Easy Freeway Access – Close To 5, 60, & 710 Freeways for Quick Transport
- Sale Price: Asking \$2,200,000 (\$105.31/SF)

# Property Location & Aerial

3580 FRUITLAND AVE.  
MAYWOOD | CA

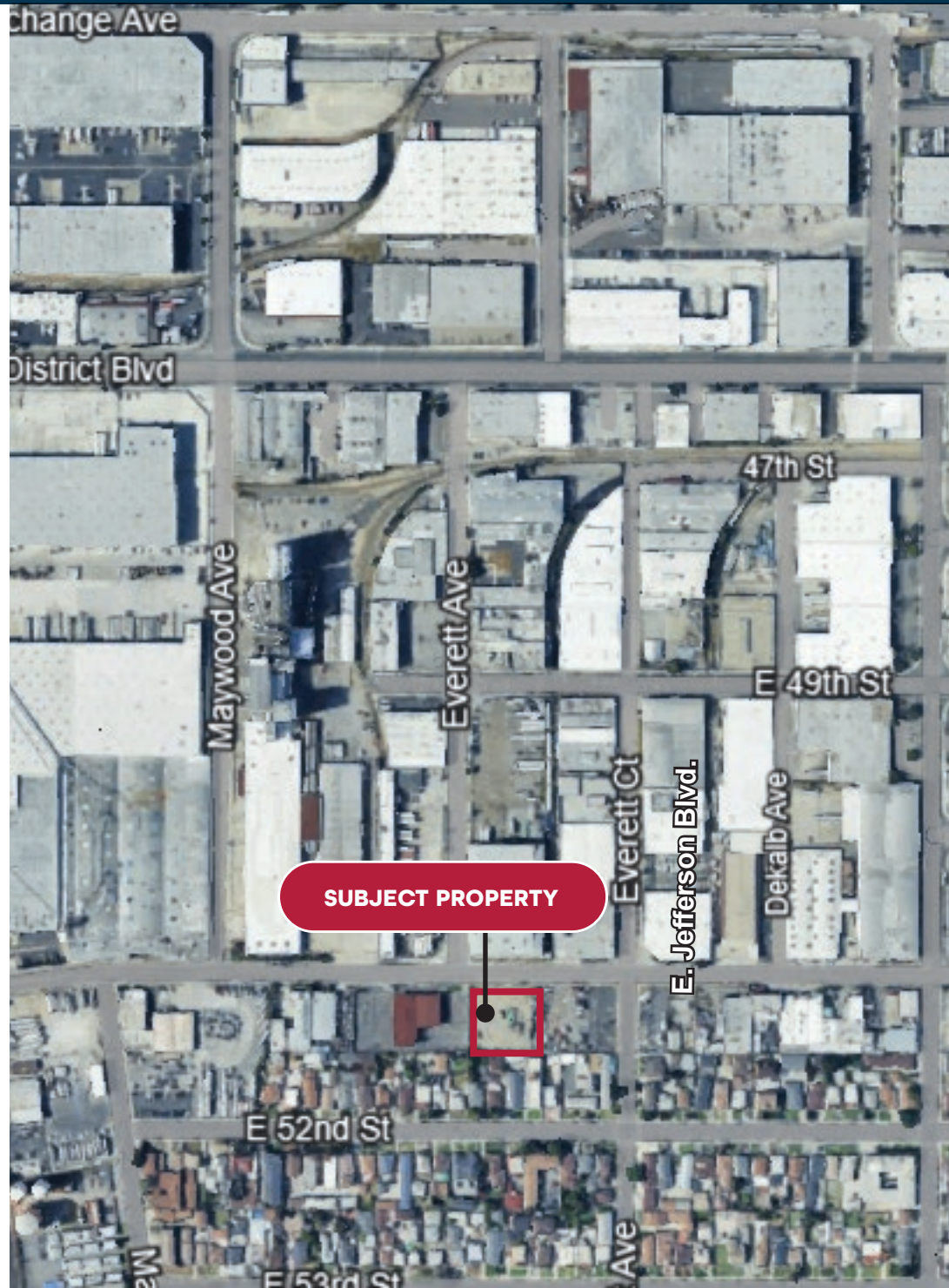
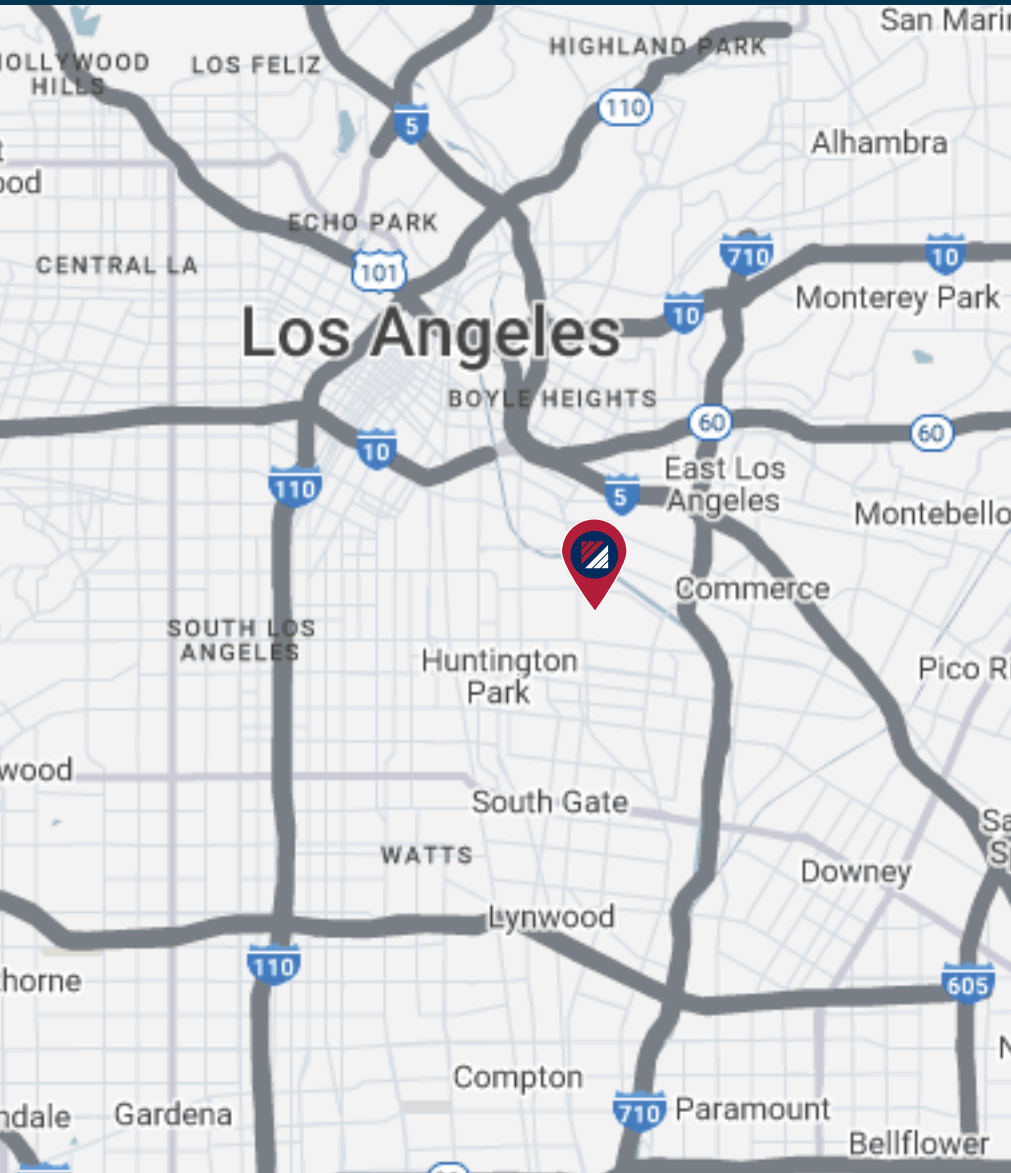

|   |   |   |  |
|---|---|---|--|
| <b>1,305,717</b><br>5-Mile Radius of<br>Population Served | <b>22 Miles</b><br>to Port of LA/<br>Long Beach | <b>20 Miles</b><br>to Long Beach<br>Airport (LGB) | <b>17 Miles</b><br>to Los Angeles<br>Airport (LAX) |
| <b>&gt;1 Miles</b><br>to Nearest FedEx<br>DC              | <b>&gt;1 Miles</b><br>to Nearest UPS<br>DC      | <b>2 Miles</b><br>to Nearest DHL<br>DC            | <b>38 Miles</b><br>to John Wayne<br>Airport (SNA)  |



## For More Information, Contact:

### BRYAN ABAYAN

Associate Vice President

P: 310.883.8476

[babayan@daumcre.com](mailto:babayan@daumcre.com)

CA License # 02005294

### SEAN HOMSY

Associate Vice President

P: 213.270.2237

[shomsy@daumcre.com](mailto:shomsy@daumcre.com)

CA License # 02157447

D/AQ Corp. #01129558. Maps Courtesy ©Google & ©Microsoft. Although all information is furnished regarding for sale, rental or financing is from sources deemed reliable, such information has not been verified and no express representation is made nor is any to be implied as to the accuracy thereof, and it is submitted subject to errors, omissions, changes of price, rental or other conditions, prior sale, lease or financing, or withdrawal without notice.