

# HEAVY POWER - GREAT FOR MANUFACTURING

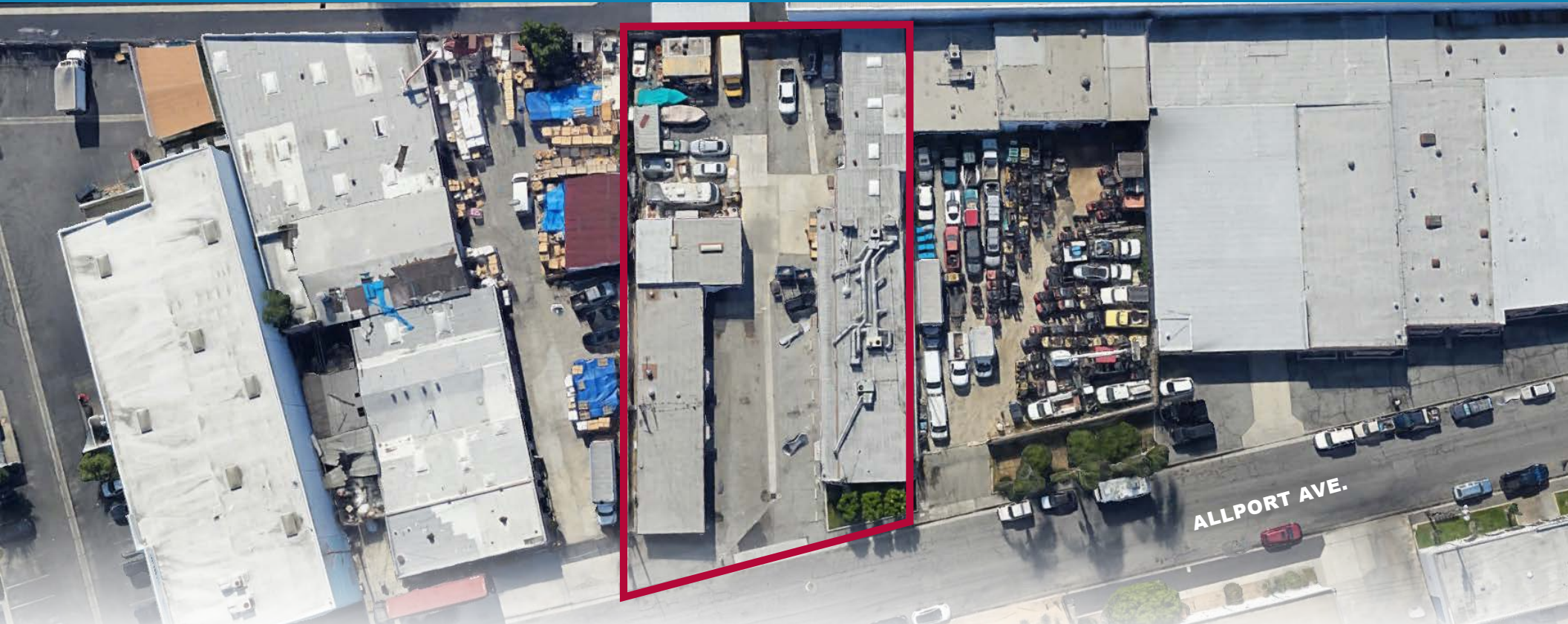

**FOR LEASE**  
**±8,572 SF ON 22,068 SF**  
**8231 ALLPORT AVE.**  
**SANTA FE SPRINGS | CA 90670**

**FOR MORE INFORMATION, PLEASE CONTACT:**



**LUI SALAZAR**  
ASSOCIATE  
D: 213.270.2229  
lsalazar@daumcommercial.com  
CA Lic. #02118236



**ALONDRA SALAZAR**  
ASSOCIATE  
D: 213.270.2226  
asalazar@daumcommercial.com  
CA Lic. #02222628



**SAM CHU**  
EXECUTIVE VICE PRESIDENT  
D: 562.207.3303  
schu@daumcommercial.com  
CA Lic. #01186837

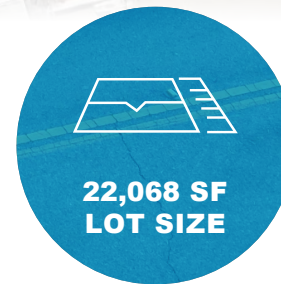

D/AQ Corp. #01129558. Maps Courtesy ©Google & ©Microsoft. Although all information is furnished regarding for sale, rental or financing is from sources deemed reliable, such information has not been verified and no express representation is made nor is any to be implied as to the accuracy thereof, and it is submitted subject to errors, omissions, changes of price, rental or other conditions, prior sale, lease or financing, or withdrawal without notice.

# FOR LEASE

±8,572 SF ON 22,068 SF

8231 ALLPORT AVE.

SANTA FE SPRINGS | CA 90670

## PROPERTY HIGHLIGHTS



±8,572 SF BUILDING  
ON ±22,068 SF LOT



±1,500 SF  
OFFICE SPACE



SECURED  
LOT



THREE (3)  
GL DOORS

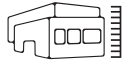

8'  
CLEAR HT



HEAVY  
POWER

- ±8,572 SF Free Standing Building on 22,068 SF Lot
- ±1,500 SF of Office Space
- Three (3) GL Doors
- 8' Clear Height
- 1,000A, 240V, 3Ø Heavy Power
- HVAC and Gas
- Secured Yard
- Centrally Located

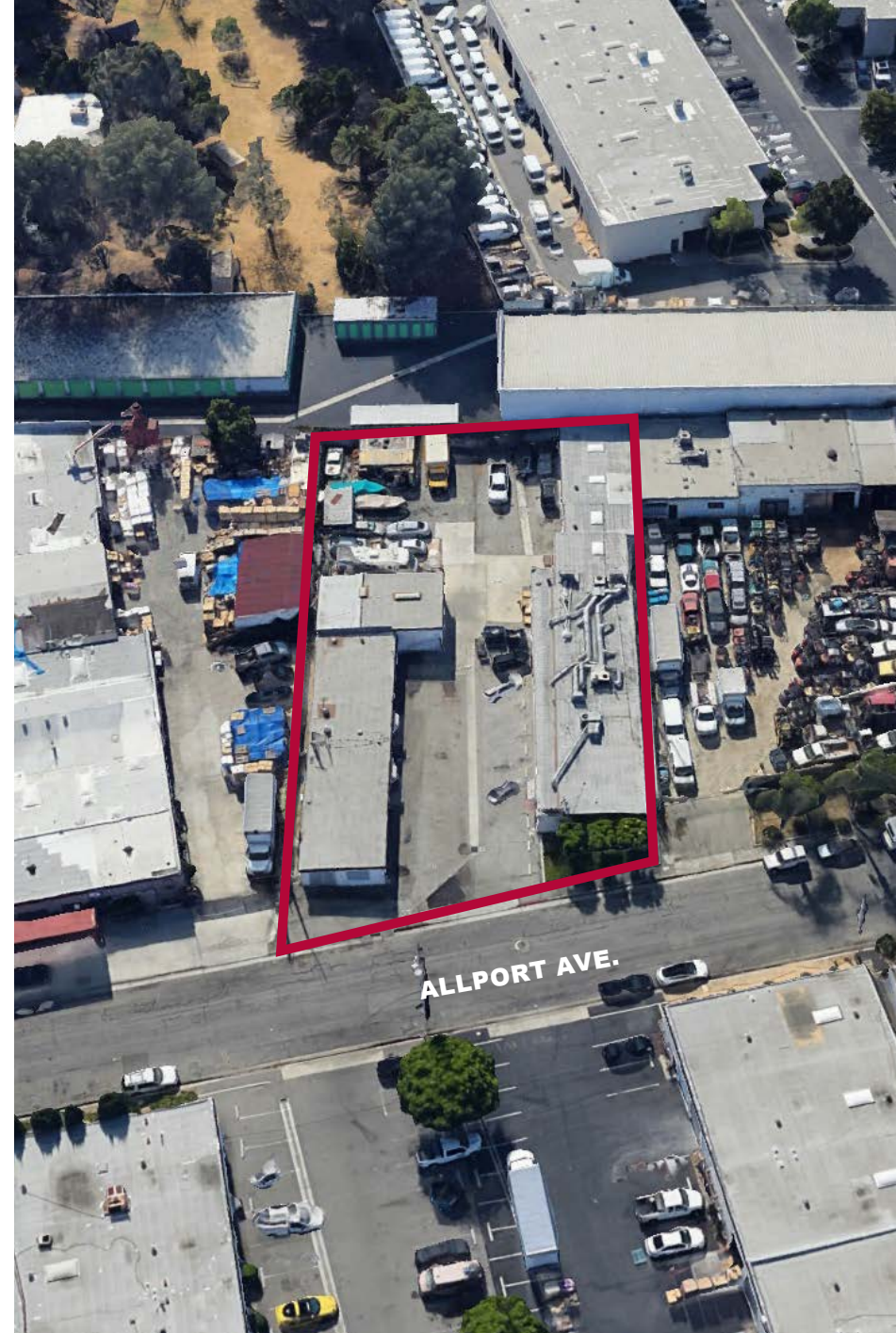

FOR MORE INFORMATION, PLEASE CONTACT:

2



**LUI SALAZAR**  
ASSOCIATE  
D: 213.270.2229  
lsalazar@daumcommercial.com  
CA Lic. #02118236



**ALONDRA SALAZAR**  
ASSOCIATE  
D: 213.270.2226  
asalazar@daumcommercial.com  
CA Lic. #02222628



**SAM CHU**  
EXECUTIVE VICE PRESIDENT  
D: 562.207.3303  
schu@daumcommercial.com  
CA Lic. #01186837

AERIAL

**FOR LEASE**  
**±8,572 SF ON 22,068 SF**

**8231 ALLPORT AVE.**  
**SANTA FE SPRINGS | CA 90670**



**FOR MORE INFORMATION, PLEASE CONTACT:**

**3**



**LUI SALAZAR**  
ASSOCIATE  
D: 213.270.2229  
lsalazar@daumcommercial.com  
CA Lic. #02118236



**ALONDRA SALAZAR**  
ASSOCIATE  
D: 213.270.2226  
asalazar@daumcommercial.com  
CA Lic. #02222628



**SAM CHU**  
EXECUTIVE VICE PRESIDENT  
D: 562.207.3303  
schu@daumcommercial.com  
CA Lic. #01186837

**PHOTOS**

**FOR LEASE**  
**±8,572 SF ON 22,068 SF**

**8231 ALLPORT AVE.**  
**SANTA FE SPRINGS | CA 90670**



**FOR MORE INFORMATION, PLEASE CONTACT:**

**4**



**LUI SALAZAR**  
ASSOCIATE  
D: 213.270.2229  
lsalazar@daumcommercial.com  
CA Lic. #02118236



**ALONDRA SALAZAR**  
ASSOCIATE  
D: 213.270.2226  
asalazar@daumcommercial.com  
CA Lic. #02222628



**SAM CHU**  
EXECUTIVE VICE PRESIDENT  
D: 562.207.3303  
schu@daumcommercial.com  
CA Lic. #01186837

**PHOTOS**

# FOR LEASE

±8,572 SF ON 22,068 SF

8231 ALLPORT AVE.  
SANTA FE SPRINGS | CA 90670



FOR MORE INFORMATION, PLEASE CONTACT:

5



**LUI SALAZAR**  
ASSOCIATE  
D: 213.270.2229  
lsalazar@daumcommercial.com  
CA Lic. #02118236



**ALONDRA SALAZAR**  
ASSOCIATE  
D: 213.270.2226  
asalazar@daumcommercial.com  
CA Lic. #02222628



**SAM CHU**  
EXECUTIVE VICE PRESIDENT  
D: 562.207.3303  
schu@daumcommercial.com  
CA Lic. #01186837

AMENITIES  
MAP

# FOR LEASE

## ±8,572 SF ON 22,068 SF

**8231 ALLPORT AVE. | SANTA FE SPRINGS | CA 90670**

**FOR MORE INFORMATION, PLEASE CONTACT:**



**LUI SALAZAR**  
ASSOCIATE  
D: 213.270.2229  
lsalazar@daumcommercial.com  
CA Lic. #02118236



**ALONDRA SALAZAR**  
ASSOCIATE  
D: 213.270.2226  
asalazar@daumcommercial.com  
CA Lic. #02222628



**SAM CHU**  
EXECUTIVE VICE PRESIDENT  
D: 562.207.33034  
schu@daumcommercial.com  
CA Lic. #01186837

Although all information is furnished regarding for sale, rental or financing from sources deemed reliable, such information has not been verified and no express representation is made nor is any to be implied as to the accuracy thereof, and it is submitted subject to errors, omissions, changes of price, rental or other conditions, prior sale, lease or financing, or withdrawal without notice. D/AQ Corp. # 01129558