

# OUTSTANDING MANUFACTURING FACILITY EL SEGUNDO LOCATION



**2041**  
**E. MARIPOSA AVE.**  
**EL SEGUNDO | CA**

**FOR LEASE**  
**24,000 SF | INDUSTRIAL**

**FOR MORE INFORMATION, CONTACT:**

**BRAD LEVIN**  
E.V.P./PRINCIPAL

P: 310.538.6728 | [blevin@daumcre.com](mailto:blevin@daumcre.com)

CADRE #01020885

 **DAUM**  
COMMERCIAL REAL ESTATE SERVICES

# FOR LEASE

## 24,000 SF | INDUSTRIAL

2041 E. MARIPOSA AVE.  
EL SEGUNDO | CA

### AVAILABLE SF

24,000 SF

### PARKING

±60

### RAIL STATION

Nearby (Green Line)

### DOCK HIGH

2 (Well)

### HEAVY POWER

800 Amps  
(2,500 Amp Power Panel)

### PROPERTY SPECIFICATIONS

- Outstanding El Segundo Location
- Just Minutes to LAX, 105 and 405 Freeways
- Approx. 6,000 Square Feet of Office
- Light Rail Station Nearby (Green Line)
- (2) Dock High (Well)
- (2) Ground Level Loading
- Large Fenced & Paved Yard
- Sprinklered
- Heavy Power: 800 Amps (2500 Amp Power Panel)
- 100% HVAC in Warehouse
- ±60 Parking





# FOR LEASE

## 24,000 SF | INDUSTRIAL

**2041 E. MARIPOSA AVE.**  
EL SEGUNDO | CA



D/AQ Corp. #01129558. Maps Courtesy ©Google & ©Microsoft. Although all information is furnished regarding for sale, rental or financing is from sources deemed reliable, such information has not been verified and no express representation is made nor is any to be implied as to the accuracy thereof, and it is submitted subject to errors, omissions, changes of price, rental or other conditions, prior sale, lease or financing, or withdrawal without notice.

**DAUM**  
COMMERCIAL REAL ESTATE SERVICES



# FOR LEASE

## 24,000 SF | INDUSTRIAL

2041 E. MARIPOSA AVE.  
EL SEGUNDO | CA

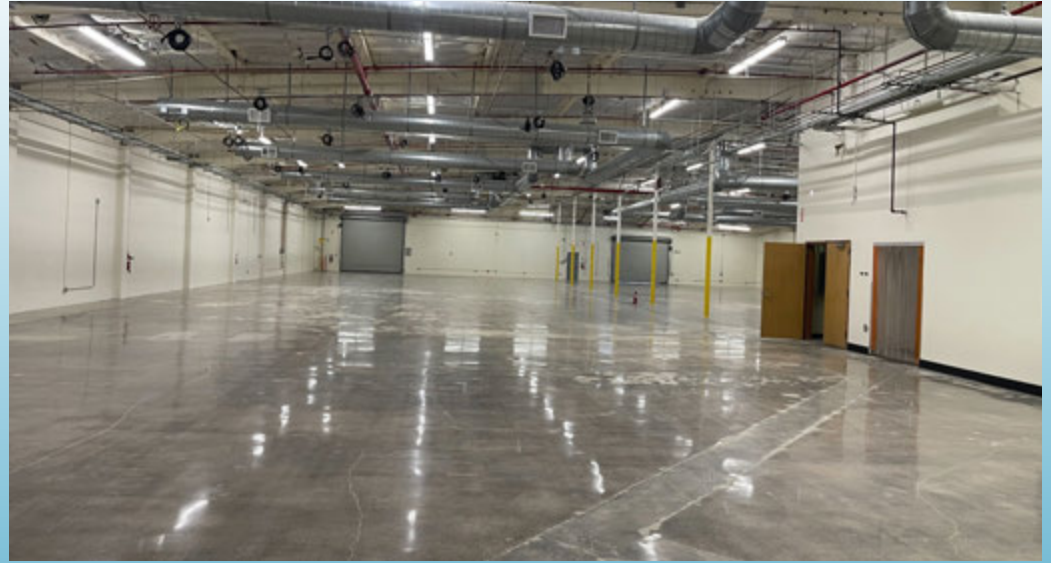

D/AQ Corp. #01129558. Maps Courtesy ©Google & ©Microsoft. Although all information is furnished regarding for sale, rental or financing is from sources deemed reliable, such information has not been verified and no express representation is made nor is any to be implied as to the accuracy thereof, and it is submitted subject to errors, omissions, changes of price, rental or other conditions, prior sale, lease or financing, or withdrawal without notice.

**DAUM**  
COMMERCIAL REAL ESTATE SERVICES



# FOR LEASE

## 24,000 SF | INDUSTRIAL

2041 E. MARIPOSA AVE.  
EL SEGUNDO | CA

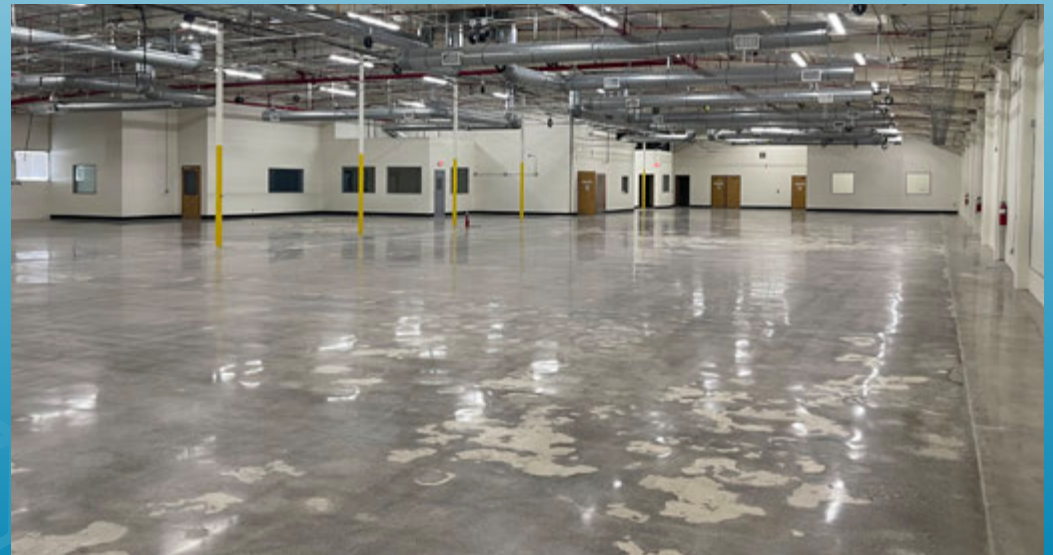



# FOR LEASE

## 24,000 SF | INDUSTRIAL

2041 E. MARIPOSA AVE.  
EL SEGUNDO | CA



SOURCE: WCL Consulting 2023 SoCal Container Drayage Rate Survey Report

D/AQ Corp. #01129558. Maps Courtesy ©Google & ©Microsoft. Although all information is furnished regarding for sale, rental or financing is from sources deemed reliable, such information has not been verified and no express representation is made nor is any to be implied as to the accuracy thereof, and it is submitted subject to errors, omissions, changes of price, rental or other conditions, prior sale, lease or financing, or withdrawal without notice.

# FOR LEASE

## 24,000 SF | INDUSTRIAL

**2041 E. MARIPOSA AVE.**  
EL SEGUNDO | CA

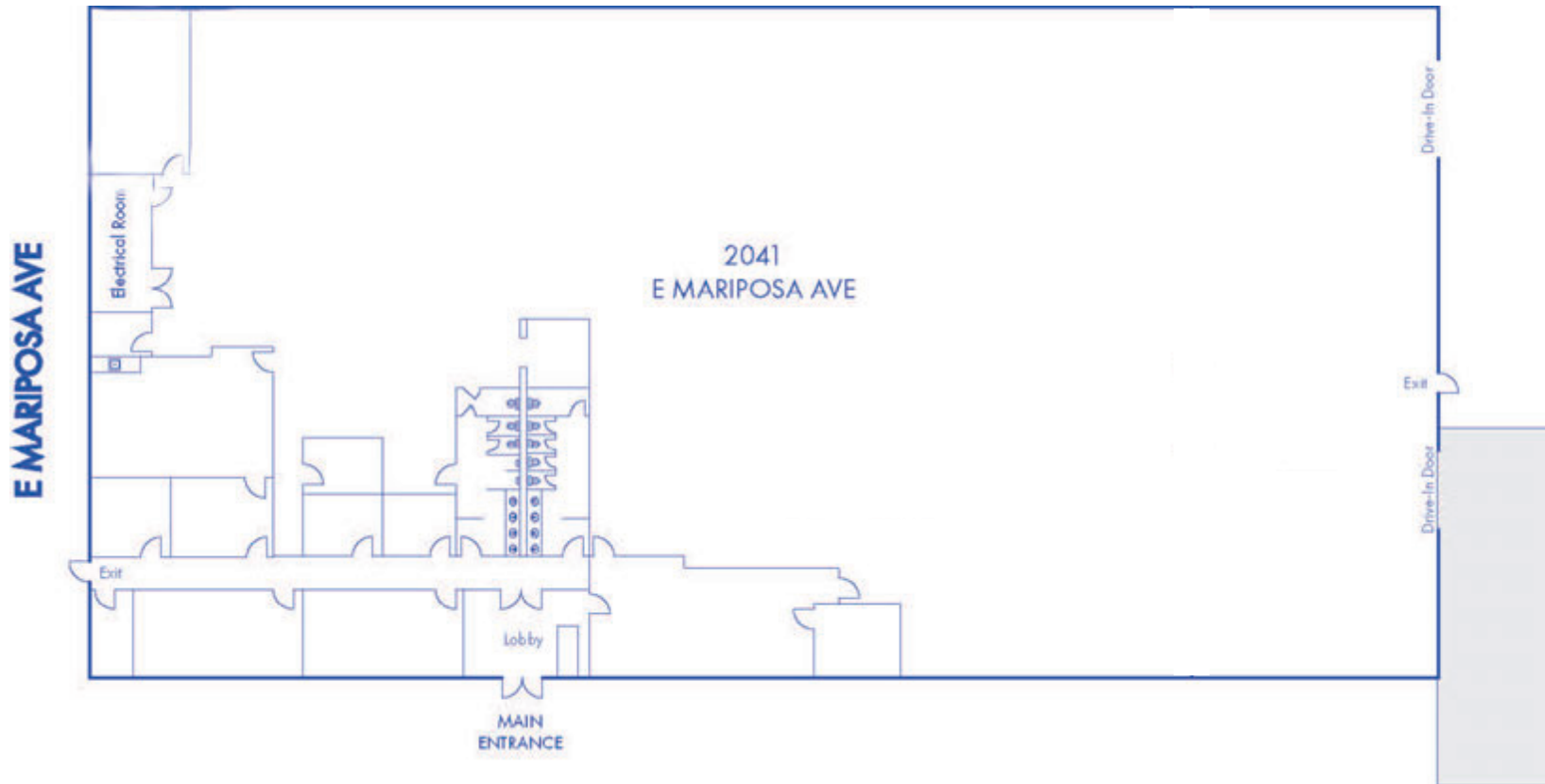



# FOR LEASE

## 24,000 SF | INDUSTRIAL

2041 E. MARIPOSA AVE.  
EL SEGUNDO | CA

